

# PUBLIC NOTICE

## •PUBLIC NOTICE•

### IN THE MATTER OF THE ESTATE OF PATRICK J. MINDRUP

First published in The Norton Telegram on Friday, November 22, Friday, November 29, and December 6, 2013. (3T)

#### IN THE DISTRICT COURT OF NORTON COUNTY, KANSAS PROBATE SECTION

In the Matter of the Estate of PATRICK J. MINDRUP, Deceased.

#### NOTICE OF HEARING THE STATE OF KANSAS TO ALL PERSONS CONCERNED:

You are hereby notified that on November 14, 2013, a Petition was filed in this County by Joseph M. Mindrup, duly appointed, qualified and acting Executor of the Estate of Patrick J. Mindrup, deceased, praying Petitioner's acts be approved, accounts be settled and allowed, the heirs be determined, the Will be construed and the Estate be assigned to the persons entitled thereto. Petitioner requests the Court find the allowances requested for attorney's fees and expenses are reasonable and should

be allowed, the costs be determined and ordered paid, the administration of the Estate be closed, and upon the filing of receipts, the Petitioner be finally discharged as the Executor of the Estate of Joseph M. Mindrup, deceased, and the Petitioner be released from further liability.

You are required to file your written defenses thereto on or before December 16, 2013, at 1:30 p.m. in the District Court of Norton County, Kansas, at which time and place the cause will be heard. Should you fail therein, judgment and decree will be entered in due course upon the Petition.

/s/ Joseph M. Mindrup  
JOSEPH M. MINDRUP

SUBMITTED BY:  
/s/ Kaylene Brin  
KAYLENE BRIN, P.A.  
Kaylene Brin, #15748  
109 W. 10th, Hays, KS 67601  
(785) 628-1145;  
FAX (785) 628-3098  
Attorney for Petitioner

**CONGREGATIONAL CHURCH, ALMENA**  
**Kirk Kasson, Pastor**  
**Phone 785-669-2501**  
**e-mail: congo@ruraltel.net**  
SUNDAY — 9:30 a.m. Sunday School  
10:30 a.m. Worship.  
6 p.m. Bible Study at VanPattens' WEDNESDAY — 6:00 p.m. TFC  
8:30 p.m. Men at the Cross Bible Study  
THURSDAY — 7:15 a.m. Teen Women's Discipleship

**ALMENA UNITED METHODIST CHURCH**  
**Pastor Lyn Linde**  
SUNDAY — 9:00 a.m. Worship  
WEDNESDAY — 7 p.m. Bible Study in Fellowship Hall  
TUESDAY and THURSDAY — 9 a.m. Vita Band Exercise Class, Everyone Welcome  
7 p.m. Bible Study at Grace Reeves

**CLAYTON UNITED METHODIST CHURCH**  
**Pastor Ed Woods**  
**669-2554**  
SUNDAY — 10:00 a.m. Worship Service, Choir  
11:00 a.m. Bible Study

**JENNINGS UNITED METHODIST CHURCH**  
**Pastor Ed Woods**  
**Phone 669-2554**  
SUNDAY — 11:00 a.m. Worship Service

**LENORA CHURCH OF GOD**  
**785-567-4459**  
**Ron Scheimo**  
SUNDAY — 10:30 a.m. Church Services  
FRIDAY — 7:00 p.m. Bible Study at the Church

**UNITED PARISH OF LENORA**  
**The Rev. Bob Speer**  
**140 E. Iowa, 567-4420**  
SUNDAY — 9:30 a.m. Social Hour  
10:30 a.m. Worship Service  
United Parish is a Community Church, all are welcome

**FIRST CHRISTIAN CHURCH OF LOGAN**  
**Pastor Troy Buss**  
SUNDAY — 9:30 a.m. Sunday School  
10:30 a.m. Church Services  
WEDNESDAY — 7 p.m. Bible Study

**ST. JOHN'S CATHOLIC CHURCH, LOGAN**  
**Reverend George Chalhagan**  
SUNDAY — 8:30 a.m. Mass  
MONDAY — 5:30 p.m. Mass

**LOGAN UNITED METHODIST CHURCH**  
**The Rev. Dean Gilbert**  
**303 W. Church, 689-4350**  
SUNDAY — 9:15 a.m. Worship  
10:30 a.m. Sunday School  
9:15 a.m. Fifth Sunday Song Service  
FIRST & THIRD WEDNESDAYS — 6:30 p.m. UMYF  
SECOND WEDNESDAY — 1:30 p.m. United Methodist Women  
THIRD WEDNESDAY — 7:30 p.m. Administrative Council Meeting

**LONG ISLAND UNITED METHODIST CHURCH**  
**The Rev. Dean Gilbert**  
**554 Washington, 854-7626**  
SUNDAY — 11 a.m. Morning Worship  
FIRST SUNDAY — 12 noon Fellowship Dinner  
1 p.m. Administrative Council Meeting  
FIRST WEDNESDAY — 2 p.m. United Methodist Women's Meeting in Fall, Winter and Spring

**LYLE COMMUNITY CHURCH**  
**Guest Speakers Each Sunday**  
SUNDAY — 9:00 a.m. Worship Service  
First Sunday of every Month — Worship Service starts at 11:00 a.m. followed by a Potluck dinner at 12:15 p.m. Everyone welcome.

**NORCATUR UNITED METHODIST CHURCH**  
**Pastor Ed Woods**  
**693-4519**  
SUNDAY — 8:45 a.m. Worship Service

**ST. JOSEPH CATHOLIC CHURCH, NEW ALMELO**  
**stjosephcc@ruraltel.net**  
**Father Vincent Thu Laing**  
SUNDAY — 8:30 a.m. Mass  
Weekday Mass Tuesday 8:30 a.m.

**THE CHURCH OF JESUS CHRIST OF LATTER DAY SAINTS**  
**Phillipsburg Ward**  
**Philip Isernhagen, Bishop**  
SUNDAY — 10:00 a.m. Sacrament meeting  
11:15 a.m. Sunday School

12:10 - Priesthood and Relief Society  
MONDAY — Family Home Evening  
WEDNESDAY — 7:00 a.m. Young Men/Young Women, Ages 12-18; 5-9 p.m. Family History Center Open

**PRAIRIE VIEW REFORMED CHURCH**  
**Ian Vanleeuwen, Pastor**  
**410 Holland, Prairie View**  
**973-2794**  
SUNDAY — 9 a.m. Morning Worship

**LUCTOR CHRISTIAN REFORMED CHURCH**  
**2 miles east and 3 miles north of Prairie View**  
**Ian Vanleeuwen, Pastor**  
**973-2794**  
SUNDAY — 10:30 a.m. Morning Worship

**CORNERSTONE CHURCH**  
**313 West Lincoln Street**  
**Pastor James Kallenberg**  
**Phone: 877-2416**  
SUNDAY — 9:00 a.m. Sunday School  
10:30 a.m. Morning Worship  
TUESDAY — 10:00 a.m. Ladies Prayer  
WEDNESDAY — 6:00 p.m. Midweek Fellowship  
SATURDAY — 8:00 a.m. Men's Prayer

**CROSSROADS MINISTRIES**  
**Preacher/Teacher Terry L. Laughlin**  
**603 Sunset Dr., Norton, KS 67654**  
**(785) 877-2567**  
**e-mail - crossroads@ruraltel.net**  
**www.standatthecrossroads.com**

**FIRST CHURCH OF GOD**  
**Pastor Terrill Worthington**  
**1010 Churchill Dr.**  
**877-2181**  
**cog@ruraltel.net**  
SUNDAY — 9:15 a.m. Time of Prayer (Adults)  
9:45 a.m. Sunday School  
10:45 a.m. Morning Worship  
5:30 p.m. Choir Practice  
7:00 p.m. Evening Service  
WEDNESDAY — 7:00 p.m. Family Night  
7:00 p.m. Adult Bible Study, Junior High and Senior High Youth, and Christian Life Club (pre-school through sixth grade)  
8:00 p.m. Committee Meetings  
FIRST THURSDAY OF EACH MONTH: 7:00 p.m. Women of the Church of God  
THIRD SATURDAY OF EACH MONTH: 8:00 a.m. Men's Breakfast

**FIRST UNITED METHODIST CHURCH, NORTON**  
**Rev. Lyn Linde**  
**805 W. Wilberforce, Norton**  
SUNDAY  
8:00 a.m. Informal Worship  
9:00 a.m. Sunday School  
10:30 Traditional Worship - Hanging of the Greens  
2:00 p.m. Andbe Home Worship Service  
3:00 p.m. Manor Worship Service  
4:00 p.m. Boy Scouts  
4:00 p.m. Jr. UMYF  
6:00 p.m. Sr. UMYF  
7:00 p.m. Narcotics Anonymous  
MONDAY — Pastor Lyn Linde on vacation  
5:30 p.m. TOPS  
6:30 p.m. Bible Study Babes  
TUESDAY — 5:30 p.m. NOW Committee Meeting - Church Parlor  
WEDNESDAY — 8:00 a.m. Prayer Warriors  
9:30 a.m. Cookie and Candy Walk - Community Center  
6:00 p.m. Here & There Circle Christmas Caroling  
6:00 p.m. Fiance Committee Meeting - Church Library  
7:00 p.m. Choir Practice  
8:15 p.m. Bell Choir Practice  
SATURDAY — 1:00 p.m. Set up for Living Nativity  
8:00 p.m. Narcotics Anonymous

**IMMANUEL LUTHERAN CHURCH**  
**Pastor Rick Rostek**  
**14715 W. Washington Road**  
**877-2430**  
SUNDAY — 9:00 a.m. Bible Class and Sunday School  
10:30 a.m. Sunday Worship  
MONDAY — 5:15 p.m. LWML  
WEDNESDAY — 2:00 p.m. Andbe Home  
5:15 p.m. Choir  
6:15 p.m. Praise Team  
7:00 p.m. Worship  
THURSDAY — Thanksgiving

**LIVING HOPE FELLOWSHIP**  
**One mile south of Norton at corner of PDRA road**  
**Pastor Jerry Cummings**  
**877-2426**  
SUNDAY — 10 a.m. Worship and Praise Service  
WEDNESDAY — 7 p.m. Youth and Children's Programs  
7 p.m. Adult Home Bible Study

**NORTON CHRISTIAN CHURCH**  
**Larry Lyles, Minister**  
**Paul Vanderveer, Youth Minister**  
**www.nortonchristianchurch.com**  
**www.igniteyouth.co**  
**208 N. Kansas, 877-2871**  
SUNDAY — 8:00 a.m. Traditional Worship Service  
9:00 a.m. Sunday School for All Ages  
10:40 p.m. Contemporary Worship Service  
6:00 p.m. "Ignite" at The Rock  
WEDNESDAY — 6:30 a.m. Men's Prayer Group in Church Library  
9:00 a.m. Prayer Fellowship for all  
6:10 p.m. Awana  
8:00 p.m. Elders' Meeting  
SATURDAY — 7:00 p.m. Saturday Night Service

**NORTON FIRST BAPTIST CHURCH**  
**Pastor Charles Ross**  
**112 S. Archer, 877-5214**  
SUNDAY — 9 a.m. Worship Service  
WEDNESDAY — 7 p.m. Mid-Week Prayer Meeting and Bible Study

**NORTON MINISTERIAL ALLIANCE**  
Andbe Home Services, 2 p.m. and Norton Manor Services 3 p.m.  
The Norton County Ministerial Alliance meets at noon on the third Thursday of each month from September through May

**NORTON SEVENTH DAY ADVENTIST CHURCH**  
105 S. Case Street  
Pastor James McCurdy  
SATURDAY — 9:45 a.m. Sabbath School  
10:45 a.m. Church Services

**ST. FRANCIS OF ASSISI CATHOLIC CHURCH**  
**Father Vincent Thu Laing**  
**877-2234**  
**stfranci@ruraltel.net**  
**108 S. Wabash, Norton**

Mass Schedule  
Sunday - 10:30 a.m.  
Monday - 7:30 a.m.  
Wednesday - 7:30 a.m.  
Thursday - 7:30 a.m.  
Friday - 7:30 a.m.  
Saturday - 7:00 p.m.  
Sacrament of Reconciliation  
Saturday - 4 p.m., 30 minutes before mass or by appointment  
TUESDAY — 7:00 p.m. Bingo  
WEDNESDAY — 7:00 p.m. SYF (K-8)  
First Wednesday of Month Mass - 7:15 p.m.  
First Friday of the Month - Eucharistic Adoration following Morning Mass  
First Saturday of the Month - 8:00 a.m. Marion Devotions  
Legion of Mary - Tuesday, 5:30 p.m.  
K of C - Third Monday of Month - 7:30 p.m.

**TRINITY EPISCOPAL CHURCH**  
**Senior Warden, Don Johnson**  
**Junior Warden, Robert Hoover**  
**102 E. Waverly, Norton**  
SUNDAY — 9:30 a.m. Christian Education  
10:30 a.m. Holy Eucharist  
Lay Reader, Georgia Briery  
Celbrant, Jerry Jones  
11:30 a.m. Coffee Hour Host, Ron and Geri Temple  
11:30 a.m. Hanging of the Greens with lunch to follow  
3:00-4:00 p.m. God's Pantry, Connie Johnson

**REDEEMER EVANGELICAL LUTHERAN (WELS)**  
**805 West Holme Street**  
**West Hwy. 36, Norton**  
**877-3138/3824**  
**timmomeyer@ruraltel.net**  
**Pastor Timm O. Meyer**  
SATURDAY — 1:00 p.m. NCF Worship Service  
SUNDAY — 9:05 a.m. Goodness from the Good Shepherd Radio Broadcast, KQNK, 106.7FM/1530AM  
9:30 a.m. Worship Service  
10:45 a.m. Sunday School  
10:55 a.m. Bible Study, Ezekiel  
12:00 p.m. NCF Worship Service  
7:00 p.m. Hays Worship Service  
TUESDAY — 6:00 and 7:30 p.m., NCF Bible Studies  
SATURDAY — 1:00 p.m. NCF Worship Service

**MAPLE GROVE CHURCH OF THE BRETHREN**  
**9 miles west 4 1/2 miles north of Norton**  
**Pastor Jack Kersenbrock**  
SUNDAY — 10 a.m. Sunday School  
11:00 a.m. Worship Service  
4th Tuesday, Women's Fellowship  
3rd Sunday, Noon, carry-in dinner

**THE ROCK**  
FRIDAY — 7:00-10:00 p.m. Seventh, Eighth, and Ninth Graders  
First Sunday Night of the Month — Quarry, 6:30 p.m. Junior and Senior High Worship

## 760+/- ACRES CROPLAND & GRASS "MULTI-PARCEL" ABSOLUTE LAND AUCTION DECATUR & RAWLINS COUNTIES, KANSAS WED., DEC. 4, 2013 @ 10:30 AM, CST

**AUCTION LOCATION:** The Gateway, Oberlin, KS  
**SELLER:** Gilbert Bryan Family

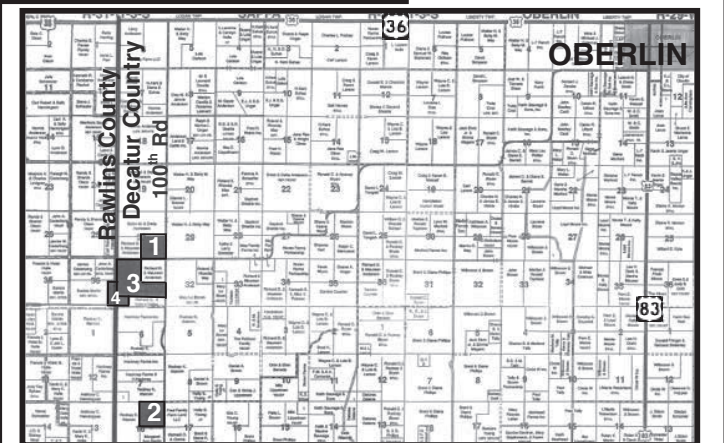

Land will be offered in 4 tracts & in combinations of tracts  
**LEGAL DESCRIPTIONS:**  
**TRACT 1:** SE/4 of 30-3-30, Decatur Co — 152.5 ac cropland  
**TRACT 2:** NE/4 of 18-4-30, Decatur Co — 126.1 ac cropland & 24.0± ac grass  
**TRACT 3:** NW/4, N/2SW/4 & N/2SE/4 of 31-3-30, Decatur Co — 190.2 ac cropland and 120.6± ac grass  
**TRACT 4:** E/2SE/4 of 36-3-31, Rawlins Co & SW/4SW/4 of 31-3-30, Decatur Co — 114.2 ac cropland & 5.8± ac grass

**INTERNET BIDDING AVAILABLE!**  
For a virtual tour & brochure visit [www.farmandranchrealty.com](http://www.farmandranchrealty.com)

**FARM & RANCH REALTY, INC.**  
**Neal Mann, Listing Agent (785-635-2102)**  
**Mike Bailey, Agent (785-678-8082)**  
1420 W. 4<sup>TH</sup> • COLBY, KS 67701  
**Toll Free: 1-800-247-7863**  
**DONALD L. HAZLETT**  
**BROKER/AUCTIONEER**  
"When you list with Farm & Ranch, it's as good as SOLD!"

## 160 ACRES DECATUR CO, KS CROPLAND w/ROYALTY INCOME ABSOLUTE LAND AUCTION TUES, DEC. 10, 2013 @ 10:30 AM, CST

**AUCTION LOCATION:** City Hall, Jennings, KS  
**SELLERS:** Turner Family

**NW/4 OF 31-4-26**  
•83.6 ac cropland  
Wheat base/ylid - 40.9/35  
Gr Sorg base/ylid - 42.0/41  
•76.4± ac grass  
This land offers good cropland and expired CRP grass. The expired CRP is currently being grazed, but could be broken out and put back into cultivation! There is good hunting potential for pheasant and deer!

**INTERNET BIDDING AVAILABLE!**  
All of Sellers' interest in mineral rights and production will go to Buyer. Mineral rights are subject to a pooling agreement. **ROYALTY INCOME HISTORY:** 2010 - \$1878; 2011 - \$1996; 2012 - \$1589; and 2013 through 8/20/13 - \$886.

CALL FOR A BROCHURE OR VISIT [www.farmandranchrealty.com](http://www.farmandranchrealty.com)

**FARM & RANCH REALTY, INC.**  
**Mike Bailey, Listing Agent (785-678-8082)**  
1420 W. 4<sup>TH</sup> • COLBY, KS 67701  
**1-800-247-7863**  
**DONALD L. HAZLETT, Broker/Auctioneer**  
"When you list with Farm & Ranch, it's as good as SOLD!"