



# Let the **Gorilla** help sell your stuff



## If you're planning a garage sale, be sure it's in **The Country Advocate**

Invite the 900-pound Gorilla to help with your garage sale. You'll have more customers, sell more stuff and make more money. That means more in your pockets at the end of the day, and less junk to haul off to the dump.

How does it work? Simple. While the paper reaches most families in the town, The Country Advocate goes all over northwest Kansas. It reaches 41,860 readers in 11 Kansas counties, plus parts of northeastern Colorado and southwest Nebraska.

That's why it's the 900-pound Gorilla of Northwest Kansas Advertising, reaching more homes and more people than any other publication, broadcast station, cable system, Internet page or advertising medium.

Reader after reader has tried The Advocate for their advertising. The results?

Stuff sells. People drive for miles to find a good sale. They don't want to walk away empty-handed. The Gorilla works.

Your newspaper makes it easy for you to be in The Advocate. Just call or stop by and place your ad. You'll be surprised how easy it is, and how affordable. You'll be surprised — and happy — when your phone starts to ring or people show up at your door.

But call today. Deadline for The Advocate is noon Friday, ONE WEEK BEFORE a weekend sale. Sure, you can get an ad in the paper later, but it won't be the same. Call the Gorilla.



**COLBY  
FREE PRESS**

155 W. Fifth Colby, Kan. 67701  
(785) 462-3963

**THE NORTON  
TELEGRAM**

215 S. Kansas, Norton, Kan. 67754  
(785) 877-3361



**THE OBERLIN HERALD**

170 S. Penn Ave., Oberlin, Kan. 67749  
(785) 475-2206

**The  
Goodland Star-News**

1205 Main, Goodland, Kan. 67735  
(785) 899-2338

**Bird City Times**

Box 220, Bird City, Kan. 67731  
(785) 734-2659

**The Saint Francis Herald**

Box 1050, St. Francis, Kan. 67756  
(785) 332-3162

**311 E. 11th, Goodland.**  
Friday from 10 a.m. to 3 p.m. and Saturday from 9 a.m. to 2 p.m.. Furniture, housewares, large hutch, pictures, glasses and lots of miscellaneous.  
G 109-10/9

**AUCTIONS/AUCTION SERVIC**

**McEwen Auction.**  
Experienced in all types of sales. Contact Duane McEwen at 785-877-3032.  
N tfn

**LOST AND FOUND**

**FOUND in Northern Sherman County** in early August. Black calf, brand on left hip. Call to identify. (785) 399-2726.  
G 10/9-10/16

**PERSONALS**

**Good looking, hard working,** open minded, single, white male has lots and lots of love to give to a companion. Interested in 40 - 70 yrs old 785-672-8382.  
C 10/9-10/16

**NOTICES**

**Pumpkins for Sale** - October 5 & 19, 9 a.m. - 4 p.m., October 6 & 20, 12 - 4 p.m., October 7, 9, 11 & 14, 4:30 - 7 p.m. Moonlight Gardens, 3 mi. N on Hwy 25, 1/2 W.  
C 10/9-10/16

**The person that brought the figurines 1 - 21 at the garage sale 1040 Villa Vista, you are missing #20, call 785-443-8284 to claim.**  
C 10/9

Gateway Civic Center in Oberlin, KS. Open 9 a.m. to 4 p.m. A large selection of unique items! Free admission. Vendor tables for home based businesses and crafters are still available for \$25 - but act fast! Call (785) 475-3441 for more info. (leave message)  
O 10/9

**TERRY RIEGER** will be having a concealed carry handgun class Oct. 12 at 8:30 a.m. at the Cheyenne County Wildlife Clubhouse, St. Francis. Call 785-332-5031 to sign up. 40-41c  
SFH 10/3-10/10

**MEMOIRS WRITING** and publishing workshop with Lucille Rossbach, Saturday, Oct. 12, 1-4 p.m., Atwood City Library. 40c  
SFH 10/3

**CELEBRATE ST. FRANCIS** memorabilia is on sale at Majestic Service, Farm

Bureau, United Methodist Thrift Store, museum and The Saint Francis Herald. Stop by and pick up a T-shirt, cap, mugs, shot glasses, koozies and coins. Prices are reduced.  
SFH tfn

**THE CITY OF ST. FRANCIS** is accepting bids to repaint the 39 pedestal pedestrian lights on Main Street. Contact JR at 785-332-3031 for details. Bids due by 5 p.m. Oct. 14. 38-41C.  
SFH 9/19-10/10

**HELP WANTED**

**Medium Duty Truck Mechanic**

Medium duty truck mechanic for 1 man shop in Colby.

Mush have experience. Gas and diesel engines and transmission diagnostics required. Clutch, break and drive line maintenance.

Vacation and holiday pay. \$25 per hour pay.

**913-486-5852**

**HELP WANTED**

Truck driver needed for fuel hauling in the Scott City/Colby/Goodland area. Must have CDL, tanker and HAZMAT endorsement. Home most nights. Health insurance and retirement benefits available.

Please send requests for application to [sandjtrucking@att.net](mailto:sandjtrucking@att.net).



**Automotive Technician**

NW KS Ford Dealer in a progressive community currently seeking a Full Time Service Technician. Established business of over 40 years. \$15 per hour, attractive benefit package, college town, great place to live & work.

Contact Chris at **Tubbs & Sons Ford Sales Inc** Colby, KS 67701 (800) 369-3673 [mtubbs@st-tel.net](mailto:mtubbs@st-tel.net)

**Help for Abused women and children.** Open 24 hours a day, seven days a week. Call Northwest Kansas Shelter, 800-794-4624.  
SFH tfn

**Raybo's Meats** will beat First Stop, Norton on Tuesday, October 8 through Friday, October 11 from 11:00 a.m. to 7:00 p.m.  
N 10/9

**Millings Available.** Can be transported. Call Merrill at 785-871-0836 or Deb at 785-202-1833.

N 11/6

**Carpet Cleaning - 3 Room Special** - Only \$159.95! Dry-Foam Safe & Green Seal approved. Serving NWKS mileage free since 1987. A+ Cleaners (785) 538-2526 or (785) 443-5400, Johnene Cheney.  
N 11/1



**Now Hiring Shop Technicians**

Full time and Part time positions available now at Mitten Travel Plaza. Excellent Career Opportunity. Blue Cross Blue Shield Insurance packages, Dental Insurance, Profit Sharing, 401k plan, paid vacation, fuel discounts, tire discounts, top wages, year-end bonus program, and many more benefits available to qualified employees. Experienced applicants encouraged and training also available. Please apply online at [www.mitteninc.com](http://www.mitteninc.com) or For more information call 785-672-3270. Mitten Inc. is an EOE. **\$1000 Sign on Bonus**

**Full Time Position Available**

**OUTSIDE YARD HELP**

*Duties Include:*  
• Truck Loading & Unloading  
• Equipment Assembly  
• Forklift Operator

Great Long Term Opportunities w/Good Pay, Health Ins. and Retirement Plan

**For more details call:**

1-800-982-1280  
or apply in person at Beaver Valley Supply Co. Atwood, KS 67730  
or online @ [beavervalleysupply.com](http://beavervalleysupply.com)

**ARE YOU LOOKING FOR AN EXCITING NEW CAREER? JOIN THE CLEARLY TEAM!!**



**NOW HIRING FOR CONSTRUCTION SALES**

Join our Building Sales Team at our NEW Colby, KS Branch. Base salary plus bonuses, full benefits, paid vacation and holidays, 401K plans, and your own company vehicle!! Construction experience preferred. Join our debt-free, family owned company with a 99% customer satisfaction rating. **APPLY ONLINE TODAY!!** [www.workforclearlybuildingcorp.com](http://www.workforclearlybuildingcorp.com)

**NOW HIRING! RN'S, LPN'S, CNA'S, CMA'S** and Dietary. FT and PT. Competitive wage scale. Apply in Person at Deseret Health & Rehab at Colby, 105 E. College Dr., Colby, KS or contact Cheryl or Kyra at 785-462-6721.



**Help Wanted**

Our company is growing and we are looking to hire. If you like working hard and being part of a great team, this position is for you. We are looking for entry level or experienced collision repair technicians who are self motivated and take pride in producing a quality repair. If you would like to make auto body repair your career, please give us a call or stop by. We look forward to hearing from you and having you as part of our family. Creative Collision, Oberlin, KS. (785) 470-2130.

**Help Wanted**  
Experienced Mechanic to work on farm equipment. Great working conditions, wages, and benefits. Always busy providing great customer service. Newer service vehicles and a comfortable shop. Apply at Yost Farm Supply, PO Box 1080, St. Francis, KS 67756. 785-332-3351 - ask for Dave Yost. An equal opportunity employer.

**Fertilizer Delivery Driver**  
CPS Goodland is currently accepting applications for a Full Time Fertilizer Delivery Driver. Must have a Class A, CDL and Hazmat or be able to obtain one. Other duties would include shop maintenance & upkeep on equipment. Pre-employment background check & drug screening required. The full-time position offers a 401K and Benefits. Applications can be picked up in person at the North Office. EOE.

**Peoples State Bank**  
www.psonline.net FDI  
Peoples State Bank-Goodland has a full-time opening for a Teller/CSR. Desired qualifications include excellent skills in customer service, cash handling and computer proficiency in Windows environment. A two year degree or equivalent work experience is not required but preferred. Job responsibilities include deposit transactions, balancing cash drawer, and opening deposit accounts. Interested individuals should send resume with personal and business references to PO Box 869, Goodland, KS 67735.

**NOW HIRING!**  
**Front Desk Clerks; Cooks; Housekeeping; Servers**  
Flexible hours. Full and part-time positions available. Great benefits including insurance, vacation pay & 401K. Top pay. Certification bonus. Monthly bonus program. Employee discount at Penny's Diner, Excellent promotional opportunities, Dynamic training program. APPLY TODAY! 801 N. Highway 27. Front Desk Clerks/Van Drivers must have good driving record and be able to pass a drug test. (Junction of Hwy K-27 @ US-40) Sharon Springs, KS Phone: (785) 852-4664. (785) 852-4665-fax. [sharonsprings@mail.oaktreinn.com](mailto:sharonsprings@mail.oaktreinn.com)

**LET'S HAVE A CONVERSATION ABOUT STARTING A GREAT CAREER**  
**CROP ADJUSTER**  
Rural Community Insurance Services (RCIS), a Wells Fargo company and a leader in the crop insurance industry, currently has a full-time Crop Adjuster position available to cover the territory NW Kansas. Incumbent will office out of their home in the territory.  
Incumbent will possess 6+ months of agriculture related experience or agriculture related education. Some physical requirements. Reliable means of transportation with the ability to travel. Will possess strong verbal communication skills and strong customer service skills.  
To apply, visit [www.wellsfargo.com/careers](http://www.wellsfargo.com/careers) and search for requisition #3794862. Learn more about Rural Community Insurance Services at RCIS.com.  
Wells Fargo is an Affirmative Action and Equal Opportunity Employer, M/F/D/V. © 2013 Wells Fargo Bank, N.A. All rights reserved. Member FDIC.

**Red River Commodities**  
is currently looking for dependable individuals to fill openings in it's confection sunflower processing plant.  
**Receiving Department:** Must have CDL or the ability to acquire.  
**Warehouse Department:** Experience preferred, but will train the right person.  
Please apply in person at:  
1320 E. College Dr. in Colby, KS

**Hartland Cleaning**  
Looking for a Part Time **JANITORIAL CLEANER** In Colby • Evening Hours  
Call Craig **402-475-5588**

**Oasis Travel Center C-Store, Maintenance Dept. and Starbucks** are looking for Highly Motivated, Self Starting, Hard Working individuals to join our team. We are now hiring for all shifts: 6-2 p.m., 2-10 p.m., and 10-6 a.m.

Must be willing to work weekends and Holiday's. Good working environment, competitive wages.

We will work around your schedule, Full or Part-time available.

Please Pick up a application at Oasis Travel Center or Starbucks at 700 W Horton Ave. Colby, Ks. 67701 or Call 785.460.0044 to have one sent or e-mailed to you.

**PBC**  
Pepsi Beverages Company of Colby, KS has an **IMMEDIATE** opening for:  
**Full Time Warehouse Loader**  
Please review the detailed job descriptions, requirements, and apply online TODAY at [www.pepsico.com/careers](http://www.pepsico.com/careers)  
PBC is an Equal Opportunity Employer

**CEMENTING OPERATOR AND DRIVER POSITION**  
**Consolidated Oil Well Services has served the Mid-Continent region and the Rocky Mountains since 1956, providing all types of cementing, acidizing and fracturing.**  
Consolidated Oil Well Services is looking to fill Equipment Operator/Driver positions in Oakley, Kansas immediately. This is an hourly position, paying \$15.00/hour and up, depending on relevant experience.  
Candidates must meet the following requirements:  
• A good driving record  
• Class A CDL  
• High School Diploma or GED  
The position offers the following benefits:  
• 7 days on-2 days off/ 7-2/7-3 Schedule  
• Health, Vision, and Dental Benefits  
• 4% Matching on 401K  
If you are interested, please send your résumé to [kkoslosky@cows.bz](mailto:kkoslosky@cows.bz) or fax to 307-686-4917. For more information visit our website [consolidatedows.com](http://consolidatedows.com).

**Time for a New Career?**  
The Goodland Star-News is looking for a **FULL TIME ADVERTISING EXECUTIVE** to join our team selling advertising for Nor'West Newspapers. Work week is 40 hours. Computer skills are helpful but not required. Must have good communication skills, excellent customer service skills with attention to detail, and enjoy a fast-paced atmosphere.  
Send a resume to: **Kevin Bottrell, Editor,** 1205 Main, Goodland, KS 67735, or apply in person. No calls please.  
The **Goodland Star-News**  
1205 Main, Goodland, KS 67735

**HELP WANTED**

**Part Time Dietary Server positions** needed for our growing Assisted Living Facility. Flexible hours. Friendly and Rewarding work environment. Great position for a High School/College Student or someone who needs to get out of the house few a few hours a day and enjoys working with the elderly. Apply at Fairview Estates Retirement Community, 1630 Sewell Ave, Colby, KS 67701 - 785-462-2154. EOE  
C 10/9-10/16

**Certified Medication Aide/CMA and CNA** positions available on all shifts. We offer Competitive Wages, Shift Differentials for night shift, Holiday Pay and Call in pay available. Friendly and Rewarding work environment. Apply in person at Fairview Estates Retirement Community, 1630 Sewell Ave, Colby, KS 67701 - 785-

462-2154. EOE  
C 10/9-10/16

**LPN part-time needed** for growing Assisted Living Facility. Flexible hours, competitive wages, friendly and rewarding work environment. Apply at Fairview Estates Retirement Community, 1630 Sewell Ave, Colby - 785-462-2154, email resume to fairview@st-tel.net. EOE  
C 10/9-10/16

**Paraprofessional opening** at Colby Public Schools. Health Insurance and other benefits are available. Application available at the administration office, 600 W. Third Street, 785-460-5000 EOE  
C 10/9

**Assistant basketball coaches needed!** Coaches needed for boys and girls at the high school and middle school levels. Application available at the administration office, 600 W.

Third Street. 785-460-5000 EOE  
C 10/9

**Trucking Company in Northwest Kansas** has immediate opening for driver. Hauling grain, rock, and sand Monday through Friday. Local hauling, home every weekend. Paid weekly, must have a CDL and good MVR. Must have 2 years driving experience. Call for appointment (877) 850-7285 or (785) 678-8041.  
O 10/9 to 10/30

**Colby 24/7 Travel Store** has an opening for a full time Assistant Manager. Our employees are customer service oriented and have an outgoing personality. Benefits include, flexible hours, BCBS insurance, 401K, Paid Vacation, and Incentive pay. Apply in person at 24/7 Travel Store 1980 south Range. Also check us out on the web www.24-7stores.com.  
C 10/2-10/9

**FT Accounts Receivable Clerk** wanted at Rawlins County Health Center, Atwood, KS. Apply at www.rchc.us EOE.  
C 10/2-10/9

**SureFire Ag Systems is hiring** for full time seasonal positions. We develop and manufacture application technology used in modern farming businesses. We are looking for motivated individuals eager and willing to learn. Open positions include pulling/packing orders, shipping and assembly. These positions run from October through April with paid holidays. Apply on site at 9904 HWY 25 Atwood KS. or email jason@surefireag.com  
C 10/2-10/9

**DL Cattle Trading**, out of Benkelman, NE has an immediate opening for a feedyard office manager/bookkeeper. The ideal candidate would have good

computer skills and basic accounting knowledge. Having an agriculture (beef cattle) background would be a plus. The individual must be trustworthy and reliable. The job offers a very competitive salary and benefits package with housing provided. Interested individuals should contact Bill Sleigh at 614-800-4777 or email bill.sleigh@dlglobal.net.  
C 10/2-10/23

**FirstFleet Inc is looking to hire** Class A CDL driver for our Garden City, KS location for deliveries in Lexington, NE. 2 Yrs minimum Exp along with a clean safety/driving record required. Great Pay, Great Benefits, Great People. Please Contact Matt Fisher, 816-214-1232, for more info.  
C 10/2-10/9

**Logan County Farm Service Agency** has a temporary full-time Program Technician position available. Salary ranges from

\$24,933 to \$31,315 (Grade CO-3 to CO-5) depending on knowledge and experience. Must be a US citizen; high school education or GED. An agricultural background and general computer knowledge is not required, but helpful. Applications (FSA-675, Application for FSA county employment and KSA's, Knowledge, Skills and Abilities) may be picked up at the Logan County FSA Office, Oakley, KS between 8 a.m. and 4:30 p.m., Monday through Friday. Applications and KSA's must be returned to the office no later than 4:30 p.m., October 11, 2013. Please call the Logan County FSA office with any questions at 785-672-4861. FSA is an Equal Opportunity Employer.  
C 10/2-10/9

**Receptionist wanted:** approximately 30 hours per week. Send resume to: 1401 Main, Goodland, KS 67735.  
G 10/2-10/9

# The Country Advocate Service Directory

## SPEEDLINER

**Moonlight Liners**

Spray-In Bedliners

**Scott Gilmer**

819 W. 8th • Goodland, KS 67735  
(785) 890-5384  
Evenings & Weekends



## Langer Industrial Service

2022 County Road 11 • Levant, KS 67743 • 785-586-2208  
Monday - Friday 8 a.m. - 5 p.m.

**We pay cash up to for all scrap metal\***

- Brass • Copper • Aluminum • Batteries • Electric motors • Cars
- Combs • Farm Equipment • Prepared/Unprepared Iron and Tin
- Container Service • Off site baling and car crushing
- Limited pickup service available

*Schedule deliveries after normal business hours by appointment when necessary*

\* Some Conditions Apply

## Guitars & Band Instruments

*"No need to go to the city for your instrument needs. Come see us the The Music Box!"*

- Rent or purchase
- Instruments made in the USA
- ACCESSORIES (reeds, drumsticks, strings, pads, etc.)



430 14th Street, Burlington, CO

Open Friday and Saturday from 12-5 p.m., or call for weekday appointments

**Lessons • Repairs • Instrument Rentals**

## Your protection is personal.

Get a quote today from:

**Shirley D Skolout**  
Mountain Plains Agency LLC  
1690 W. 4th St., Colby  
(785) 460-6284  
skolos1@nationwide.com



**Auto. Home. Life. Business.**



Nationwide Mutual Insurance Company and Affiliated Companies. Home office: Columbus, Ohio 43215-2220. Nationwide Life Insurance Company, Nationwide, the Nationwide Framemark and On Your Side are service marks of Nationwide Mutual Insurance Company. Subject to underwriting guidelines, review and approval. Nationwide, Nationwide Insurance, the Nationwide framemark, Nationwide is On Your Side and Join the Nation are service marks of Nationwide Mutual Insurance Company. © 2013 Nationwide Mutual Insurance Company. All rights reserved. NPO-0194M1 (01/13)

## High Plains RV Resort



Swimming pool, hot tubs, clean restrooms, Propane available, clubhouse and laundry room, and store!

*We only have a few sites available for monthly guests, so call us now.*

High Plains RV Resort • (785) 672-3538 • www.HighPlainsCamping.com

We sell PROPANE PROPANE PROPANE!

**Live at the resort in your RV Oakley/Colby!**

Live in your RV at the #1 rated RV resort in Kansas. \$450 monthly rent - includes water, sewer & cable TV!

## Truck Lettering

800-886-2423

AWARD WINNING SIGNS AND PINSTRIPING SINCE 1974

## Hot Brush

204 W. 4th Box 309  
Bird City, Kan. 67731



## Dr. Tom Barlow

**DENTIST**

785-460-7538

Appointments Readily Available

505 H N. Franklin, Colby

## MURRAY ROOFING & CONSTRUCTION

RESIDENTIAL • COMMERCIAL • INDUSTRIAL

**Residential:**

- Roofing
- Construction
- Remodels
- Blown in Insulation

**Commercial:**

- TPO, EPDM, Duro-Last, Modified, Fibered and Non-Fibered roof coatings.



Fully Insured, Bonded, Licensed and Covered by workman's Comp.

**Office: 785-462-6908**

Office Manager: 785-443-5708  
Owner: 785-443-1339



Elite Dura-last Contractor

CHECK OUT OUR WEBSITE FOR MORE INFORMATION:

**www.MurrayEnterprises.org**

## Paw Wash Pet Crematory

6445 Rd. 21, Goodland

Kathy Schermerhorn

Please leave message  
CELL PHONE: (785) 899-4398  
Private or Group Rate

## Mobile Home Lots for Rent

\$175 Month  
(includes water, sewer & storage shed)  
FREE Month with approved application

## Friendly Acres Mobile Home Park

1150 S. Franklin, Colby  
Call 785-462-6445

## Windy Plains Bike Shop

Professional bicycle repairs since 1978!  
Parts, accessories and service for all makes.  
Pick up and delivery available in Goodland!

**TIRED OF FLATS?**  
ASK ABOUT OUR NO FLAT GUARANTEE!

**Harold Snethen**  
6085 Rd. 17

(785) 899-4786 • (785) 899-5858 (home)  
Same day service on most out of town repairs!

## KANSAS Insurance

Formerly THOMAS County INSURANCE AGENCY



**Dennis Tubbs**  
dtubbs@kansasins.com

**490 N. Franklin**  
**785-462-3939**

- Home & Auto
- Farm & Crop
- Business Insurance
- Boat, Motorcycle, RV

**Nationwide Agribusiness**  
On Your Side®

www.kansasins.com

Certified Insured & Bonded

## CTE Construction & Roofing

When Time Matters & Quality Counts



Roofing, Siding, Gutters

General Construction (Decks, Porches)

Post Frame or Steel Buildings

Unbeatable Steel Building Prices Residential & Commercial Save With Quality

308-345-3242  
www.cteroofing.com

## FARM & INDUSTRIAL PAINTING

Grain Bins, Barns, Morton Sheds, Barn Repairs, Metal Roofs

**ALL COLORS! TRI-STATE PAINTING**

Pat Castella  
1-800-940-8289  
leave message

FREE ESTIMATES!

## NEW SYSTEM PROFESSIONAL WINDOW CLEANING

**(785) 462-6995**  
**(800) 611-6735**

www.MyWindowCleaner.net  
Serving Colby since 1992!

Commercial • Residential • Free Estimates

## HINKLE TERMITE & PEST CONTROL

1-800-536-2704  
www.hinkletermite.com

JOE HESKETT • OWNER • 785-545-6868 (CELL)

## Looking for wheat straw or damaged wheat to bale

**Kroskob Brothers Farms**  
Custom Haying and Farming

Will Prepay to secure Acres  
Call for Pricing

Brandon: 970-380-4256 or Travis: 970-380-6853

**Schwans - Colby, KS** Now taking applications! Must be 21 or older, good driving record, active license. Apply now: [www.schwansjobs.com](http://www.schwansjobs.com) Questions: 785.462.2871  
C 9/25-10/16

**Village Inn is now hiring** all positions, all shifts, apply in person.  
C 9/25-10/16

**PART-TIME CNA NEEDED.** Goodland Home Health, contact Sue at (785) 821-0050.  
G 9/18-10/18

**CDL Drivers** - Must be at least 23 years of age, clean MVR, minimum 2 years of driving experience. Hopper experience a plus. Call 785-462-0087.  
C 9/11-12/25

**Great Western Tire of Colby, Inc.,** 1170 S. Country Club Drive, is now accepting applications for a full time appliance repair

technician. Job includes delivery & installation of new appliances, diagnostics and repairs on all appliances. Experience and knowledge of repairs required. Valid driver's license is a requirement. Full time position includes competitive salary and benefits. Apply in person, EOE. Questions please call 785.462.2100.  
C 8/21-TFN

**Decatur County Road and Bridge** is taking applications for full-time employment. Employee will be subject to random drug and alcohol testing and will be required to obtain a CDL. Applications available at Engineer's Office. Call (785) 475-8111. Decatur County is an Equal Opportunity Employer.  
O 4/24tf

**Help Wanted: correspondent for Rexford.** Send news via e-mail once a week. Paid by inch and receive free subscription to The Oberlin Herald.

O 1/30 tfn

**PSI Transport is always looking** for good company livestock and grain haulers as well as shop mechanics. Competitive pay, life/health/dental benefits and bonus program available. EOE. (785) 675-3477.  
G 6/15-TFN

**Marketing Assistant** wanted with outgoing personality for part-time work, 1:00 p.m.-6:00 p.m., four days a week. Call 785-874-5122.  
N tfn

**Phillips County Retirement Center** has openings for LPN's, RN's and C.N.A.'s. Offering part-time or full-time employment, good wage and benefit package including paid single health and dental plan. Please call (785) 543-2131 for more information or stop by 1300 State Street to pick up an application.  
N 10/9

**Be a part of the Miracle!** Norton Valley Hope is now hiring for the following positions: FT and PT RN/LPNs; FT and PT Patient Care Aides; FT Cook. Excellent working environment with excellent benefits! Email resume to [employment@valleyhope.org](mailto:employment@valleyhope.org) or stop by the facility to fill out an application. EOE.  
N 10/16

**AG VALLEY CO-OP** in Norton, KS is accepting applications for a Custom Applicator of fertilizer and ag-chemicals and a Tender Truck Driver. These are full-time positions. Ag Valley offers competitive wages as well as one of the best benefit packages in the area. Please apply online at [www.agvalleycareers.com](http://www.agvalleycareers.com) for these positions or contact Robert Campbell at 785-877-5900.  
N 10/9

**Norton County Road and**

**Bridge** is taking applications for an Equipment Operator. Experience is preferred but we are willing to train. Valid CDL required within first 90 days of employment. We offer paid health insurance and paid vacation/sick days, holidays, and KPERs retirement. Employees are subject to random drug/alcohol testing. Applications can be picked up at 15590 Washington Rd, Norton or by calling 785-877-5740. Applications accepted until position is filled. EOE.  
N tfn

**Direct Support Workers** are needed in Almena to work for an individual with a disability in their home. Starting wage is \$9.64 an hour. Duties may include personal care, household chores, meal preparation, etc. For an application, please contact Carol at LINK, Inc. at 1-800-569-5926 and leave your name and mailing address.  
N 10/16

**AMERICAN GREETINGS** is looking for Retail Greeting Card Merchandisers in Norton, KS. As a member of our team, you will ensure the greeting card department is merchandised and maintained to provide customers the best selection of cards and product to celebrate life's events. Join the American Greetings family today by applying online at [WorkatAG.com](http://WorkatAG.com) or call 1-888-323-4192.  
N 10/16

**WANTED - Property Manager/Maintenance** needed for apartment community in Norton, Kansas. P/T flexible hours. Send resume to Jennifer Persing, 6220 SW 29th St., Suite 202, Topeka, Kansas 66614 or email: [jennifer@cgkansas.com](mailto:jennifer@cgkansas.com)  
N 10/16

# The Country Advocate Service Directory

## WANTED: DIRTY CARPET

**IF YOU HAVE DIRTY CARPET, WE CAN STEAM CLEAN IT. NO JOB TOO BIG OR TOO SMALL!** Cleaning NW Kansas one house at a time!

- Commercial/Residential
- Advanced Truck Mounted Steam Cleaning Equipment
- Water Damage Restoration
- FREE ESTIMATES

**PRO FLOOR CARE**  
Carpet & Upholstery Cleaning  
(785) 462-8313 or (800) 473-4138



## Nancy LePell Bookkeeping

165 East 3rd - Colby, KS 67701  
785-462-7428

Income Tax Preparation - Individual, Business and Estates  
**Now Processing Tax Returns Under Extension**

Christy Griffith, RTRP Nancy LePell, EA, ChFC, CB  
Working to bring you the best possible solutions

## Looking for a better return?

David Browne III  
550 N. Franklin Ave.  
Colby, KS  
785-462-5288  
[www.agentdavidbrowne.com](http://www.agentdavidbrowne.com)

Vernon Hurd  
550 N. Franklin Ave.  
Colby, KS  
785-462-5288  
[www.vernonhurd.com](http://www.vernonhurd.com)

If you have CDs about to mature or other assets to invest, consider all of your options. Not only do our fixed annuities offer you a competitive return, they also offer you flexibility, security and guarantees.  
To see how simple it can be to save for your future, contact us today.

**FARM BUREAU FINANCIAL SERVICES**  
Insurance • Investments

Auto | Home | Life | Business | College | Retirement

The guarantees expressed here are based on the claim-paying ability of Farm Bureau Life Insurance Company. Note: Bank CDs are FDIC insured, the other products referenced here are not. Holiday hours: Celebrations & Services offered through 11th. Marketing Services, LLC - 3403 University Ave., West Des Moines, IA 50326, 515/286-2264. Member SIPC. Farm Bureau Property & Casualty Insurance Company, Western Agricultural Insurance Company, Farm Bureau Life Insurance Company, West Des Moines, IA. \*Variable. Company providers of Farm Bureau Personal Services 815/328-2121.

## Culligan

better water. pure and simple.®

- Drinking Systems • Water Softeners (Sales & Rentals)
- Water Coolers • Salt Sales & Delivery

## Scheopner's Water Conditioning, Inc.

Goodland & Colby, KS • Toll free: (800) 536-2352

## NKBA

The Kitchen & Bath Professionals

- Kitchen Cabinets • Counter Tops
- Closets • Furniture • Commercial
- Entertainment Centers
- Custom Jewelry Closets



## Mingo Custom Woods

1965 W. 4th St., Colby, KS • 800.320.2201  
[www.mingocustomwoods.com](http://www.mingocustomwoods.com) • 785.462.2200

## Welcome



**Dr. Justin Evanson**  
DDS, MD

Oral and  
Maxillofacial  
Surgeon



Dr. Justin Evanson has joined the Burlington Family Dentistry team, providing **ORAL SURGERY with IV SEDATION**, including wisdom teeth extractions. •• Accepting most insurances. ••

Now you can have oral surgery right here in Burlington and avoid the trip to the city.

## Burlington Family Dentistry

340 14th St. • Burlington

(719) 346-8266

Please call for an appointment  
Jason Ehtessabian, DDS, PC

[www.burlingtonfamilydentistry.net](http://www.burlingtonfamilydentistry.net)



Dr. E

## Health insurance is changing.

You have new plan options, but which one is right for you? I can help you understand your options and select the right plan for you and your family.



Give me a call today!  
I know health insurance.

Vernon Hurd  
Farm Bureau Agent  
550 N. Franklin Ave.  
Colby, KS 67701  
785-269-9511  
[www.VernonHurd.com](http://www.VernonHurd.com)



KANSAS FARM BUREAU  
The Voice of Agriculture

CoventryOne.

Products available at Farm Bureau Financial Services

CHKS1768 Health Insurance plans underwritten by Coventry Health and Life Insurance Company, H2398-ML-1 (8-13)

This space WILL  
work for YOU!

Contact your local newspaper  
today to find out how!



**NEW HOURS STARTING AUGUST 31!**  
12:30-9 P.M. TUESDAY-FRIDAY • 9 AM-9 PM SATURDAY  
CLOSED SUNDAY AND MONDAY

921 MAIN, GOODLAND • PHONE: (785) 890-2256

**Daily delicious treats, plus Bake Sale Saturdays starting August 31st...**  
Items available while they last every Saturday. Cakes, cupcakes, cookies, breads, cinnamon rolls, pies, dinner rolls, cheesecakes, danishes, homemade pretzels and more!

**We also offer custom-decorated cakes and treats!**

NOW available at Oasis Travel Center in COLBY...

## Gunnysack Greeting Cards

"Cards that have the guts to tell it like it is"



Sarcastic & Silly  
Very Blunt & Unusual  
Not for the easily Offended  
Created by Ellis, KS resident  
Tracy Augustine

Stop by to check out the wonderful selection or go online at  
[www.gunnysackgreetings.com](http://www.gunnysackgreetings.com)



## HOXIE STATE INSURANCE, INC.

824 Main, PO Box 378  
Hoxie, KS 67740

115 S. State St.  
Winona, KS 67764

(785) 675.3263 - Fax (785) 675.3721

## C.W. Beamgard Co. Inc.



Jeep

SALES & SERVICES SINCE 1919

- New Vehicle Sales
- Used Vehicle Sales
- Parts
- Accessories
- Service
- Windshield Pit Repair
- Tires
- Towing Service

Monday - Friday 8-6, Saturday 8-Noon

**785.626.3286**

Fax 785.626.3717

210 State St. • Atwood, KS 67730



360 14th St., Burlington, CO ~ PHONE: (719) 346-7579  
Dan and Myrna Troyer

## ROOFMASTERS

Your Local Roofing Contractor

425 East Hill, Colby, KS  
Licensed - Bonded - Insured

RESIDENTIAL  
Tamko Shingles  
GAF Shingles  
Wood Shingles  
Metal Roofs

1-800-536-6642  
1-785-462-6642

**FREE ESTIMATES**

Elastomeric Rubber Coating For Metal Roofs

COMMERCIAL  
Rubber Single Ply  
White TPO Single Ply  
Built Up Systems  
Modified Systems

## Meadow Lake Restaurant & Lounge

Golf season is here. Come join in the fun at our new low season prices!

Meadowlake Golf Course, Restaurant and Lounge are public facilities, not private - everyone welcome.

Restaurant and Lounge are open  
Monday - Saturday  
Prime Rib, Salad Bar and Desert Special every Saturday night



**785-460-6443**

1085 E Golf Club Rd. • Colby, KS



**PART-TIME** position is available in the maintenance department at the Cheyenne County Hospital. Position will be 4 hours daily Monday - Friday and with flexibility for other hours if needed. Job includes a variety of skilled and unskilled jobs about the buildings and grounds to insure the proper maintenance functions of the hospital and the medical clinics. Applicants with basic electrical, mechanical and computer skills preferred. Contact Sara in Human Resources or fill out an application on-line at [www.cheyennecountyhospital.com](http://www.cheyennecountyhospital.com). (tfn)

SFH tfn

**NANNY NEEDED M-F**, Competitive pay. Located in St. Francis. References required. Call 785-332-4412. 38-39c

SFH 9/19-9/28

**WANTED**

**Dry land/Irrigated land** to cash rent, will pay a premium. 785-567-7837.

C 9/18-12/11

**2 Families eager** to move to Rawlins county farm-ranch. If you would have

2-4 quarters with or without houses you would be willing to sell for cash, please contact us [palmer.farms@yahoo.com](mailto:palmer.farms@yahoo.com). Paul and Ann, Mike and Emily. (520) 824-3646 or (520) 403-4223. O 9/18-10/9

**Custom haying service.** Now baling failed corn and milo. Can also do CRP cane or alfalfa. Reasonable rates, turnkey job, can travel. Call Tadd Neitzel at (785) 332-7004.

G 8/14-10/14

**Wanted: Older pickups**, 1930-1972, clean out barns, sheds, tree rows, any condition, top dollar. Phone 785-687-3416.

N 10/16

**Junk batteries**, non-ferrous metals and iron. Darrel Bowen. Phone 785-899-2578.

G tfn

**SERVICES**

**Will iron men's shirts** for \$2.00 each, call 785-460-7990.

C 10/9-10/16

**I specialize & analyze** the situation surrounding

the environment. Pines, Deciduous, Evergreens, Shelterbelts, Fruit Trees, Cleanup, Removal, Nurseryman, Gardening, Landscaping, Shrubs & Yard Care. Dave's Tree Service 785-443-0994.

C 10/2-10/23

**Need Fencing? Can tear out**, build, and repair pasture fences and corrals. Call 970-554-1613.

C 9/25-10/16

**Would you like to lower** your heating cost for this upcoming winter, have Vap Construction blow-in insulate your attic. Schedule now before the first storm hits! Call Dustin Vap at 785-626-2978.

C 9/18-10/9

**Are you having problems** keeping rain water away from your foundation and basement, have Vap Construction fix your problem with 100% seamless guttering. Call Dylan Vap at 785-216-0446.

C 9/18-10/9

**Burlington-Goodland area.** Residential overhead door service and repair, 20 years

experience. Call Gary at (719) 350-0705.

G 7/17-tfn

**Hickert Enterprises, LLC.** Windmill repair and service. Tree trimming and removal. (785) 475-2729.

O 6/5-12/25

**Do you have weeds every year?** Want a great looking yard? Call JM Tree & Lawn Service to fill ALL of your needs this year. We offer full tree care and sprinkler system maintenance/installs as well. Call today to get a free quote. 785-462-6908.

C 5/22-TFN

**BECKMAN Carpet Cleaning:** Truck-mounted steam cleaning. Carpets, upholstery and autos. Call (785) 626-4548.

SFH tfn

**Have a leaking roof** and need it repaired? Look no further. Murray Roofing & Construction, LLC will give you a free estimate and roof inspection. We specialize in residential and commercial roofing systems. Call our office to schedule an inspection. 785-462-6908.

C 4/3-TFN

**Prairie Dog Control**



"Treat now and have more grass this spring"

Control your Prairie Dogs with Rozol® this fall and have more grass this spring.

**Donnie Sughroue**  
Bartley, Nebraska  
Cell (308) 350-3120  
Home (308) 692-3693



**Personal Property Auction**

**RUDY ZIMBELMAN ESTATE & MEL & LINDA PFAU**

**Saturday, OCTOBER 12, 9:30 a.m. MDT**

**Location: VFW Hall, 824 Main, Goodland, KS**

**GUN:** Ant. Winchester mdl 1897 12ga pump shot gun, full choke  
**FURNITURE & APPLIANCES:** Matching sofa & love seat; Large cherry wood entertainment center; Country table W/6 chairs, 3 leaves; Country hutch; 2 glass top side tables; 2 sofa hide-a-beds; 2 sofas; 2 rocker/recliners; White swivel rocker; Several high back chairs; Chrome Craft table W/4 chairs; Wood dining table; Bedroom set W/queen bed; 3 bedroom sets W/chest, dressers; Glass top end table; Floor lamps; Small china hutch; Several chests & dressers; Ant. secretary; Ant. Seth Thomas mantel clock; Ant. Oak wash basin; Ant. Magazine rack; Pool table; Maytag heavy duty washer & dryer; Kenmore dryer; Maytag washer; Microwave; 4 bar stools; Base cabinet W/formica top; Kitchen table; King pillow top bed & headboard; Small TV stand; Ant. cupboard.; 3 bookcases; Hoover vacuum; RCA consol TV; Treadmill; Stamina Stepper; Exercise tramp; Kimball Organ; 2 Portable tv's; Bakers rack.  
**MISCELLANEOUS:** Lots of kitchen dishes, casseroles, glass bowls, relish dishes, platters; Mixing bowls, silver trays; 12 gold changer plates; 12 red Christmas baskets; Yellow Fiesta pitcher; Deco wall plates; 2 antique oil lamps; Several lamps; Lots of bedding for full & king beds; Books; Camping stove; Ping Pong table; Lots of jars; Singer portable sewing machine; 8 place porcelain china set; Steins; Lots of dishes; Silverware; Cookware; Quilts; Bedding, towels, pillows; 2 oil lamps; Knick knacks; Card table W/chairs.

**GARAGE & SHOP TOOLS:** Near new recumbent bike; Small metal lathe; Bench grinder; Drill press; Jig saw; Mall saw; Elect drills; Large assortment of hand tools; Sanders; Rope; Chains; Extension ladder; 2 step ladders & step stools; Lawn mower; Fert. spreader; Edge trimmer; Fishing poles; Extension cords; Lawn Sweep; Yard & garden tools.

Many more items. The hall will be full so come and enjoy the day. For more information contact Terry Richardson at 785-899-8094. Homestead Realty, 1023 Main, Goodland, KS. [www.goodlandhomestead.com](http://www.goodlandhomestead.com)



**Call us before you** pay your next insurance premium. American Family Insurance - Rita Peters Agency - Colby 785-462-8246.

C 1/25-TFN

**CAT'S TNT for jewelry**, material, vinyl graphic designs, massages, quilting and more! Stop by 1018 Main, Goodland, or call (785) 890-2287 for more information.

G 3/28-tfn

**Experienced with texturing**, painting, cleanup/removal of clutter. Experience with Rental management experience. Have 16 ft. car trailer for rent. 785-462-5861.

C 3/25-TFN

**Abel Tree Service**-Fully insured, free estimates, stump grinder, bucket truck. 785-871-7275.

N tfn

**Dan is back!** Dan Geschwentner. Small remodeling and repair jobs. Call 785-443-3673.

C 2/3-TFN

**Graham Dirtworks, LLC** - Offers Trenching Services for water lines and electrical lines, installation or replacement of water hydrants; backhoe services and general skid steer work, etc. Willing to travel. For info call Mark at 785-543-4336.

N tfn

**Jacobs Service**, your authorized Traeger Grill dealer. See our selection of grills, pellets, rubs and spices at West Highway 36, Norton. Pellets are \$13.50 per bag EVERY DAY!

N tfn

**ARTS & ANTIQUE FAIR**

**October 11 & 12, 10 a.m. to 4 p.m. CT**  
On the grounds of Whistle Stop RV Park, Colby, KS  
(Across the street from Walmart)

**Booths reserved by antique dealers, artists and master craftsmen. There will be something for everyone!**  
**TO RESERVE A SPOT CALL (785) 460-6000**

**Whistle Stop RV & Antiques**

**960+/- ACRES CROPLAND, GRASS & CRP**  
**MULTI-PARCEL ABSOLUTE LAND AUCTION**  
**SHERMAN COUNTY, KS**

SELLER: ESTATE OF MERLE STASSER

**Tues, Oct. 15, 2013 @ 10:30 AM, MDT**

**AUCTION LOCATION:**

Community Hall at the Firehouse, Goodland, KS

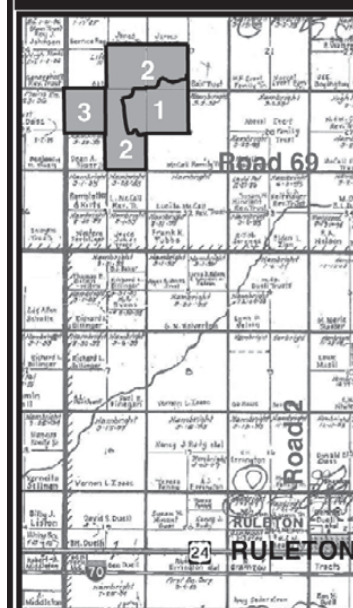

Land will be sold in 3 tracts and combinations of tracts:

**LEGAL DESCRIPTIONS:**

- TRACT 1:** NW/4 of 29-7-41; Tract of 23.9± ac cropland in SW/4 of 20-7-41; and all cropland ac in E/2 of 30-7-41
  - 151.3 ac cropland
  - 52.8± ac grass
  - 64.2 ac CRP
- TRACT 2:** SE/4 of 19-7-41; grass acres in E/2 of 30-7-41 and SW/4 of 20-7-41; and Tract of 48.4± ac cropland in SW/4 of 20-7-41
  - 126.1 ac cropland
  - 401.1± ac grass
- TRACT 3:** NW/4 of 30-7-41
  - 79.1± ac grass
  - 80.9 ac CRP

\*Total of 422.5 acres cropland. 277.4 acres are newly broke & in compliance with NRCS. 145.1 acres come out of CRP in 2015 - could be broke out & added to the cultivated acres.

\*Seller plans to plant to wheat this fall on all broke ground with Buyer to receive 100% of the crop. **IMMEDIATE POSSESSION TO BUYER!**

**INTERNET BIDDING AVAILABLE!**

**For Virtual Tour visit**

[www.farmandranchrealty.com](http://www.farmandranchrealty.com)

**FARM & RANCH REALTY, INC.**

1420 W. 4<sup>TH</sup> • COLBY, KS 67701

TOLL FREE: 1-800-247-7863

**DONALD L. HAZLETT**

Broker/Auctioneer

"When you list with Farm & Ranch, it's as good as SOLD!!"

**Cash 4 Junkers**

Will pay top dollar for your unwanted, totaled or junked vehicles. Cars, vans, pickups or trucks. Also interested in other metals. Call 785-332-7046, Jett Fromholtz, St. Francis, Ks.

**IN THE NATION, YOU'RE ALWAYS WELCOME.**

Please attend our Grand Opening.

We treat our members like family. So come see our new home and learn about what Nationwide can do to protect the people and things you cherish the most.

**Stop by our Grand Opening:**  
Friday,  
October 11th  
10:00 AM - 3:00 PM

**Stop by for lunch:**  
11:30 a.m. - 1:30 p.m.

Register to win a Grand Prize

Spin the wheel to win lots of great prizes!

Hosted by:  
Shirley D. Skolout  
Mountain Plains Agency LLC  
1690 W. 4th St.  
PO Box 929  
Colby, KS 67701  
785-460-6284  
[skolos1@nationwide.com](mailto:skolos1@nationwide.com)



Nationwide is On Your Side.®

**MIGHTY WINGS**



**3 PIECE: \$2.99 • COMBO: \$4.99**  
**5 PIECE: \$4.79 • COMBO: \$6.79**  
**10 PIECE: \$8.99 • COMBO: \$10.99**

• LIMITED TIME ONLY!



GOODLAND LOCATION ONLY  
OPEN DAILY 6 A.M. TO 11 P.M.

**2014 THOMAS COUNTY EXTENSION COUNCIL PROGRAM DEVELOPMENT COMMITTEE ELECTION**

Please mark your choices with an "X" by the corresponding name. Choose **THREE** of the candidates in each program area for a total of 12 people. The last line may be used for write-in candidates and the corresponding line must have an "X" on it. Elected candidates term will start January 2014.

<b>Agriculture</b> (Choose 3)	<b>Family &amp; Consumer Science</b> (Choose 3)	<b>Economic Development</b> (Choose 3)	<b>4-H &amp; Youth</b> (Choose 3)
_____ Mike Brown	_____ Colleen Bixenman	_____ Marilyn Meyer	_____ Lori Denny
_____ Herb Mattson	_____ Rosanne Dougherty	_____ Pat Sloan	_____ Lynette Koon
_____ Shad Metcalf	_____ Karen Larmer	_____ Mike Wiens	_____ Kayla Sloan
	_____ Cindy Reinert		_____ Lisa Stramel
			_____ Angela Tinkham
<b>Write In</b>	<b>Write In</b>	<b>Write In</b>	<b>Write In</b>
_____	_____	_____	_____
_____	_____	_____	_____

Please return the ballot by mail to the Thomas County Extension Office, 350 S. Range, Suite 16, Colby, KS 67701 or hand deliver by **5pm Friday, October 25, 2013**. Ballots are also available at the Extension Office October 1. For more information about Thomas County K-State Research and Extension and our programs, visit [www.thomas.ksu.edu](http://www.thomas.ksu.edu).

**C & C Construction** - All types of dirt work: terracing, dozing, motor grading, and scraper; all lazer equipped machines. Call Brian Cook, 785-567-7794 or Topper Cook 785-874-8114.  
N 10/30

**Septic Tanks Pumped** and systems installed. Call Logan Septic and Water. 785-543-7772.  
N tfn

westernkansarentals.com.  
C 10/9

**Small 2 bedroom, 1 bath** mobile home, very reasonable. Colby. 785-462-1047.  
C 9/18-TFN

**Storage units for rent** in Colby, call 785-443-8658.  
C 9/25-10/9

**2 bedroom apartment,** Brookwood Apartments, Oberlin, (785) 475-3450.  
O 36tf

**2 bedroom apartment for rent in Goodland.** No pets. Call Tom at (785) 443-0136.  
G 9/11-tfn

**TWO BEDROOM**-Two bath house, St. Francis. \$450. Call 785-332-4021. 38-40c  
SFH 9/19-10/3

**FIFTH STREET APARTMENTS** in Bird City has for rent two-bedroom duplex apartments. Applications must income qualify. For information contact N.W. Kansas Housing, Inc. at (785) 421-2151 or pick up an application at Century II in Bird City. We offer Equal Housing Opportunity and are handicap accessible.  
SFH tfn (52)

**T-N-T STORAGE** Units in Bird City has 2 units available. 12 X 20, \$75.00 a month. Call Tracy Neitzel 785-734-7100. 40-41c  
SFH 10/3-10/10

**Downtown office space available** at 5th and Franklin, Colby. Call 785-462-3939.  
C 9/19-TFN

**One Bedroom Apartment.** Newly remodeled with updated kitchen cabinets and bathrooms. Close to Hwy. 36 and hospital in Norton, KS. Furnished or unfurnished. All utilities included. Laundry facilities on premises. \$350 per month. No pets or smoking inside. Call (785) 202-1167.  
N tfn

**Independent living apartments** at Prairie Meadows and Bieber Cottages in Norton now available for persons 55 years and above. For more information about these comfortable living apartments, call Administrator Nancy McGinnis, phone 785-877-2601.  
N tfn

**Whispering Pines, Norton, KS,** has (2) single car garages available for rent. These garages are for storage only

of your car, classic car or boat. Rent will be \$75.00 per month. If interested call 785-874-5500 or email wpines@ruraltel.net.  
N 10/9

**Houses and apartments** Goodland, KS. All sizes. Call for details. (785) 890-6538.  
G 6/20-tfn

**Houses & Apartments.** Cole Real Estate in Goodland 785-899-2683.  
G tfn

**REAL ESTATE**

**Home for sale - 4 bedroom, 2 bath,** 1 car garage, nice home updates in last 2 years. In Colby - Brick ranch with full basement 785-443-4071.  
C 10/9-10/16

House for Sale - Selden, KS

**DOOR & WINDOW REPLACEMENTS**  
**SEAMLESS RAIN GUTTERS**  
**GENERAL CARPENTRY REPAIRS**  
**Ron Lucke**  
**CUSTOM BUILDING**  
(719) 346-8840  
CELL: (719) 349-8840

\$57,900, approx. 1,600 sq. feet, 4 bedrooms, 1 bath, new refrigerator and stove in large kitchen, partial unfurnished basement, underground sprinklers, 3 year old roof and windows, 2 car garage - Not for Rent - please call 785-269-7101, 785-462-6394 or 785-586-2335.  
C 10/2-10/9

**Home for sale:** 606 E. Ash, Oberlin, 3 bedroom, 2 bath, full basement, attached garage. (785) 475-3184 or (785) 475-2103.  
O 7/31tf

**THREE BEDROOM HOUSE,** two-car garage for

sale by owner. \$64,500. St. Francis. Call 785-332-4391. 32-43c  
SFH 8/8-10/24

**REAL ESTATE SERVICES**

**Let Us List Your Property.** Call Duane McEwen, listing agent for Home Range Realty Inc. at 785-877-3032.  
N tfn

**Make the Weiser Choice** - Contact Weiser Realty for all of your real estate needs at 785-877-2185. Jolene L. Weiser, Broker; Samantha M. Hager, Sally Nelson, Robert Wyatt, salespersons.  
N tfn

**LAND FOR SALE**  
**1 acre lot, all utilities,** Willcox, Arizona. \$29,000 OBO. Call (785) 890-5800. Goodland.  
G 9/4-10/23

**PETS**  
**Kittens born July 15** - Free to permanent, non-abusive home. Call 785-386-4437.  
C 9/25-10/16

**GREAT PYRENEES** puppies, \$100 ea. St. Francis, 970-630-6079. 39-42c  
SFH 9/25-10/17

**FOR RENT**  
**Very nice, new, 2 bedroom** apartment in Oakley, 15 minutes from Colby. Central heat & A/C, all appliances provided \$750/month with all utilities paid. Allen 620-397-3459 or

**HOME FOR SALE**  
**340 E. WALNUT** Custom-built home in Colby with 6 bedrooms, 4 baths, home office with private entrance. 3,700 sq ft. Ready for your family. Leave message at 785-460-6501.

**Seed Wheat for Sale**  
**Certified T158, T163, Fuller, 1863 and LCS Mint**  
**CALL Carl Wahlmeier at 785-678-2476 or 785-678-7126**

**Specials for the week October 4-10**

Drinks included. Dine-in or carry out!

- Friday, Oct. 4: Chicken Tacos
- Saturday, Oct. 5: Sloppy Joes
- Sunday, Oct. 6: Smothered Hamburgers
- Monday, Oct. 7: Meatloaf
- Tuesday, Oct. 8: Tater Tot Casserole
- Wednesday, Oct. 9: Ham and Scalloped Potatoes
- Thursday, Oct. 10: Spaghetti



Jct. of Hwys. 27 and 40, Sharon Springs, Kansas • Phone: 785-852-4664

**SAMWAY FloorCovering & FURNITURE**  
308-345-1952



**SAVE up to \$500 on select Shaw and Mohawk carpeting**  
**Sale going on now**

**SAMWAY FloorCovering & FURNITURE**

**"You'll Love This Store!"**  
1801 N HWY 83 McCook, NE 69001

**Join us in our Defending Our Freedoms Section**

Bring in your family member's Military photos with the information below. We will publish all the photos and information on Veteran's Day November 11.

All photos must be submitted by October 25 to be included in our section. If you submitted information for anyone on active duty in our last section, please let us know if we need to update any information.

*Help us honor those who have served our country.*

NAME \_\_\_\_\_  
BRANCH OF SERVICE \_\_\_\_\_  
THEATRE OF OPERATION \_\_\_\_\_  
YEARS OF SERVICE \_\_\_\_\_

*God bless all those who answer our nation's call to defend our great country's freedoms!*  
Vet, SSgt. Matthews USMC 3rd Recon Bn.

Please bring in or mail photos and information to The Colby Free Press 155 W. Fifth St., Colby KS, 67701. Photos and information may also be emailed to khunter@nwkansas.com

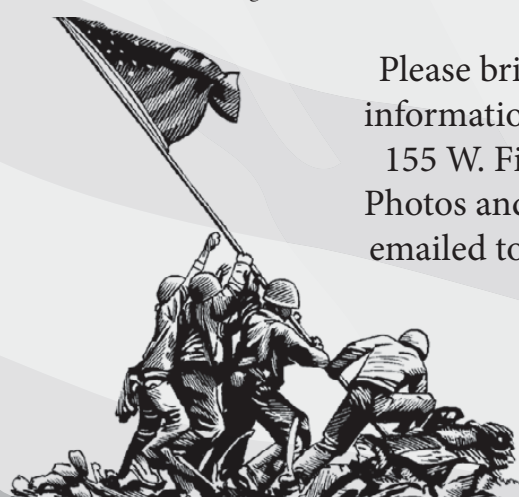

Make sure you have the protection you need for life's unexpected events.



Stop by and see Amanda for all your long-term care and disability needs.



183 S. Penn Ave  
Oberlin, Kan.  
(785) 475-3883

*"We sell insurance but specialize in service."*

**Professional Service Listing** and Selling your property. Contact Larry Riggs, Broker or Jeanette Krizek, Listing Agent. 785-678-7163. Kansasland Realty and Auction. N 10/22

**FARM SERVICES/EQUIPMENT**

**John Deere bailer, great condition.** \$5,250. In 2010 \$7,000 was put into it. Call (785) 626-0165. G 10/9-10/16

**Looking for Fall Crops to Harvest.** Have two late model John Deere Combines and Supporting Equipment. Call Derek at 785-871-0962 or 785-877-3417. N 10/23

**Custom Swathing and Baling** available. Call Jim Wagoner in Lenora, KS, 785-567-4494 or 785-202-9163. N 10/30

**Disc Rolling**—Rolling on the farm. Call Ron Lewis, Eustis, NE. 308-486-3501. N tfn

**VEHICLES/RECREATION**

**2003 Chrysler Town & Country** minivan, limited package, V6 - 3.8 liter engine, 7 passenger - power/heated leather seats, AM/FM, cassette, CD player, power sliding doors. Great condition - starting at \$4,300 - negotiable. Call 785-694-5131, Brewster, KS. C 10/9-10/23

**2006 PT Crusier.** 5 speed, only 61,000 miles, blue in color. Asking \$4,600. Call (785) 890-2827. G 10/2-10/9

**PASTURE WANTED**

**Grass pasture WANTED to rent,** Adam Jones, 785-332-6206. SFH tfc

**GRAIN/FEED**

**FEED FOR SALE,** two irrigated circles, near Bird City. One circle sudan cross, one circle cane cross. Delivery available. Contact Ted Patch. 785-332-8309. 40c SFH 10/3

**MILO HAY** \$100-\$125/ton. Cane hay \$150/ton. Can deliver 785-626-9597 or 785-626-5246. 39-41c. SFH 9/26-10/10

**Certified Agri-Pro TAM111** and SY Wolf also Fuller. Paul Nauer, Jennings 785-678-2339 or 785-678-8083. C 8/28-TFN

**For Sale:** Certified Denali, SY Wolf, SY Gold, Winterhawk, Tam 113, Hatcher, May Family Farms, (785) 475-3369 or (785) 475-7065. O 8/28-10/16

**FOR SALE**

**Steel Buildings - Big or Small.** Save up to 50%. For best deal with contract construction to complete. Source # 18X - www.sunwardsteel.com 620-577-4455 C 10/9-10/30

**2000 Morton barn 36'x15'.** Finished tack room 12'x15' with warranty and electricity. Call (785) 995-9450. G 10/9-10/9

**Eight 2 by 2 foot tables,** \$25 at Pizza Hut. SFH 10/2

**Electric Range** \$50, refrigerator, washers, dryers, microwave, dishwashers, 30 day guarantee 785-694-8013. C 9/25-10/16

**2 Harley Davidson die cast**

**models.** 1-1:10 scale Hot Wheels HD Softail. 1-1:10 scale Maisto FLSTS Heritage Springer. Still in original boxes! Call Gary at (719) 350-0705. G 9/25-tfn

**AWP toolbelt/pouches** with kidney belt and suspenders. Paid \$100 plus, asking \$50. Call Gary at (719) 350-0705. G 9/25-tfn

**2 LZ drills, 12"x8' rubber press wheels.** Sharon Springs. Call (785) 821-2124. G 9/25-10/3

**FIREWOOD FOR SALE** in Goodland. Call (785) 890-7224. G 12/12-tfn

**Rubber stamps, custom made,** The Country Advocate, 1205 Main. Goodland, Kansas. (785) 899-2338. G tfn

**GARAGE SALES**

**325 N. Chickamauga, Colby.** (East of F&M Bank) - Friday, Oct. 11, 1 - 6 p.m., Saturday, Oct. 12, 8 a.m. - noon. Furniture, tools, pickup tool box (like new), trucker CB radio, antiques, classic comic books, 1945-46 Life magazines, cast iron pots and skillets, glass rolling pins, old lanterns, and many more misc. items. C 10/9

**165 S. Chick, Colby** - Friday, Oct. 11, 1 - 7 p.m., Saturday, Oct. 12, 8 a.m. - 4 p.m. Portable whirlpool dishwasher, matching kenmore washer & dryer, furniture, misc., cash only. C 10/9

**606 E. Ash, Oberlin,**

Friday October 11 4-8 p.m. Saturday, October 12, 8 a.m. to 1 p.m. Baby clothes like new, newborn to 3 toddler. Baby swing and crib, junior size clothing, dishes and christmas decorations. O 10/9

**311 E. 11th, Goodland.** Friday from 10 a.m. to 3 p.m. and Saturday from 9 a.m. to 2 p.m.. Furniture, housewares, large hutch, pictures, glasses and lots of miscellaneous. G 109-10/9

**AUCTIONS/AUCTION SERVICE**

**McEwen Auction.** Experienced in all types of sales. Contact Duane McEwen at 785-877-3032. N tfn

**LOST AND FOUND**

**FOUND in Northern Sherman County** in early August. Black calf, brand on left hip. Call to identify. (785) 399-2726. G 10/9-10/16

**PERSONALS**

**Good looking, hard working,** open minded, single, white male has lots and lots of love to give to a companion. Interested in 40 - 70 yrs old 785-672-8382. C 10/9-10/16

**NOTICES**

**Pumpkins for Sale** - October 5 & 19, 9 a.m. - 4 p.m., October 6 & 20, 12 - 4 p.m., October 7, 9, 11 & 14, 4:30 - 7 p.m. Moonlight Gardens, 3 mi. N on Hwy 25, 1/2 W. C 10/9-10/16

See Our Selection at [waltermotorco.com](http://waltermotorco.com)  
**Walter Motor Company**  
 2 Blocks West of State St. (U.S. 283) on Washington St., Norton, KS  
**1-800-479-3112 or 785-877-3112**  
 Home Phone: Norm Walter (785) 877-3159 or Curt Walter (785) 877-5679  
*We Can Fix You Up! Full Service Shop with 3 Technicians to Serve You!*

**LINCOLNS**



**2012 Lincoln MKZ** - 4 door, immaculate, heated, cooled leather, rear parking assist, dual power seats, dual climate control, sterling gray, 13,000 miles.  
**2011 Lincoln MKZ** - 4 door, panoramic moon roof, heated, cooled leather, rear parking assist, dual power seats, dual climate control and more, only 18,000 miles.  
**2011 Lincoln MKS** - Top of the line luxury sedan, panoramic roof, all wheel drive, navigation and more, only 20,000 miles. Gorgeous!  
**2010 Lincoln MKZ** - Only 17,000 miles on this beautiful 4 door, all the comfort extras.  
**2009 Lincoln MKS** - It's the ultimate on a luxury 4 door, loaded, exceptionally clean, 56,000 miles.

er windows and locks, sharp! 129,000 miles.  
**2004 Cadillac Sedan DeVille** - A very well cared for comfort 4 door, leather, 108,000 miles.  
**1999 Acura** - This sharp looking 2 door has moon roof, heated leather and more.

**PICKUPS**



**2011 Ford F150** - 4 door crew cab, XLT, 5.0 V-8, 4x4, adjustable pedals, short bed, chrome package and more, 20,000 miles.  
**2010 Ford F150 4 Door Super Crew** - 5.4 V-8, 4x4 with Lariat package, heated and cooled leather, automatic climate control, and much more, white platinum trucoat, only 23,000 miles.  
**2005 Ford F150 Super Cab** - With Lariat trim, 5.4 V-8, 4x4, bedliner, nice!  
**2003 Ford F150 Super Cab** - 4.6 V-8, with wheel drive, cruise, tilt, alloy wheels.  
**2001 Ford F150 XLT** - S/cab 4x4 V-8, power windows and locks, new tires, white with silver tutone, 76,000 miles.

**CROSSOVERS-SUVS**

**2011 Ford Explorer** - It's the popular crossover model with XLT trim, 3rd seat, leather navigation, panoramic moon roof, dual video entertainment screens, all wheel drive, and much more, immaculate, 18,000 miles.  
**2011 Mercury Mariner Premiere** - Just the right size crossover, 4x4, V-6, heated leather, power moon roof, dual zone climate control, 19,000 miles.  
**2010 Ford Edge** - WOW! - A limited series in red candy metallic, all wheel drive, heated and cooled leather, power lift gate, only 16,000 miles.  
**2010 Ford Escape** - 4x4 XLT, only 5,038 miles on this great SUV, moon roof, sport blue metallic. Coming soon!  
**2003 Ford Windstar** - A very nice mini van with video entertainment, adjustable pedals, advance trac, rear warning system.

**The person that brought** the figurines 1 - 21 at the garage sale 1040 Villa Vista, you are missing #20, call 785-443-8284 to claim. C 10/9

**Love Craft Fairs?** Mark your calendars for the Holiday Craft Show on Saturday, November 30, 2013, at the Gateway Civic Center in Oberlin, KS. Open 9 a.m. to 4 p.m. A large selection of unique items! Free admission. Vendor tables for home based businesses and crafters are still available for \$25 - but act fast! Call (785) 475-3441 for more info. (leave message) O 10/9

**TERRY RIEGER** will be having a concealed carry handgun class Oct. 12 at 8:30 a.m. at the Cheyenne County Wildlife Clubhouse, St. Francis. Call 785-332-5031 to sign up. 40-41c SFH 10/3-10/10

**MEMOIRS WRITING** and publishing workshop with Lucille Rossbach, Saturday, Oct. 12, 1-4 p.m., Atwood City Library. 40c SFH 10/3

**CELEBRATE ST. FRANCIS** memorabilia is on sale at Majestic Service, Farm Bureau, United Methodist Thrift Store, museum and The Saint Francis Herald. Stop by and pick up a T-shirt, cap, mugs, shot glasses, cozies and coins. Prices are reduced. SFH tfn

**THE CITY OF ST. FRANCIS** is accepting bids to repaint the 39 pedestal pedestrian lights on Main Street. Contact JR at 785-332-3031 for details. Bids due by 5 p.m. Oct. 14. 38-41c. SFH 9/19-10/10

**Help for Abused women and children.** Open 24 hours a day, seven days a week. Call Northwest Kansas

Shelter, 800-794-4624. SFH tfn

**Raybo's Meats** will beat First Stop, Norton on Tuesday, October 8 through Friday, October 11 from 11:00 a.m. to 7:00 p.m. N 10/9

**Millings Available.** Can be transported. Call Merrill at 785-871-0836 or Debat 785-202-1833. N 11/6

**Carpet Cleaning - 3 Room Special** - Only \$159.95! Dry-Foam Safe & Green Seal approved. Serving NWKS mileage free since 1987. A+ Cleaners (785) 538-2526 or (785) 443-5400, Johnene Cheney. N 11/1

**HELP WANTED**

**Part Time Dietary Server positions** needed for our growing Assisted Living

Facility. Flexible hours. Friendly and Rewarding work environment. Great position for a High School/College Student or someone who needs to get out of the house few a few hours a day and enjoys working with the elderly. Apply at Fairview Estates Retirement Community, 1630 Sewell Ave, Colby, KS 67701 - 785-462-2154. EOE C 10/9-10/16

**Certified Medication Aide/CMA and CNA** positions available on all shifts. We offer Competitive Wages, Shift Differentials for night shift, Holiday Pay and Call in pay available. Friendly and Rewarding work environment. Apply in person at Fairview Estates Retirement Community, 1630 Sewell Ave, Colby, KS 67701 - 785-462-2154. EOE C 10/9-10/16

**Hometown Family Radio**  
 with  
**7102.1 PURE ROCK** and **105.3 COYOTE COUNTRY**  
 bring you  
**THE ZONE 93.9**  
**McCook's HIT Music Station**

**HomeLand REALTY AUCTION**  
 "Western Hospitality"  
 (785) 899-3060  
[www.HomeLandRE.com](http://www.HomeLandRE.com)  
 1112 Main Avenue Goodland, KS 67735

**213 Aspen**  
  
 \$149,500  
 4BR/2.75 Bath  
 Call Rose today!

**216 W. 11th**  
  
 \$50,000  
 3BR/1 Bath  
 Give Tom a call today!

425 Center.....	\$45,000
216 W. 11th.....	\$50,000
424 Center.....	\$54,500
709 Cherry.....	\$61,500
218 W. 11th.....	\$61,500
222 W. 4th, Bird City.....	\$69,000
212 Center.....	\$76,500
1319 Arcade.....	\$78,000
1523 Clark.....	\$79,500
307 E. 11th.....	CONTRACT
923 Caldwell.....	CONTRACT
808 W. 9th.....	CONTRACT
1016 Kansas.....	\$89,950
1407 Arcade.....	CONTRACT
213 Aspen.....	\$149,500
1101 Arcade.....	\$175,000
506 Harrison.....	\$175,500
6525 Road 16.....	\$327,500
1024 Main (commercial).....	\$94,900
1101 Main (commercial).....	\$94,999

**A "Don't Miss" Event!**  
**Fun on the Farm Jamboree**  
 at the Sherman Theatre, Goodland, KS  
 Featuring Richard Lynch and Country Legend T.G. Sheppard  
**Saturday, October 26: TWO SHOWS: 2 PM AND 7 PM MT**  
 Fundraising event for Cat Country 89.1 KXCT, a non-profit, non-commercial radio station



**\$25 tickets on sale now at The Goodland Star-News!**  
 The Goodland Star-News  
 1205 Main Avenue, Goodland, KS 67735 • Ph: (785) 899-2338

**HomeLand REALTY AUCTION**  
 (785) 462-8255  
[www.HomeLandRE.com](http://www.HomeLandRE.com)  
 Pat Sloan (785) 443-3261  
 Marilyn Meyer (785) 462-2703  
 Toni Lindberg (785) 443-4032  
 Rock L. Bedore (785) 443-1653  
 Tom Harrison (785) 443-0136  
 Jerry Wycoff (785) 672-0429  
 Mike Scott (785) 675-8556  
 Rory Bedore - Owner  
 1055 S. Range - PO Box 508 Colby, KS

**NEW LISTING**



**110 S. School**  
 \$59,900  
 Call Pat today!



**1725 W. 5th**  
 4 BR/2 Bath  
 Give Rock a call today!

Residential Lots \$14,000 to \$19,000	
224 Price, Oakley	CONTRACT
1115 Cty Road R, Levant	\$45,000
621 Cornell, Oakley	\$59,500
110 S. School	\$59,900
419 Colby Ave., Oakley	CONTRACT
985 E. 8th	\$72,500
605 W. 7th, Oakley	\$75,000
480 N. Lincoln	SOLD
605 Longview, Oakley	CONTRACT
209 S. Waldo, Oberlin	CONTRACT
1060 W 2nd	CONTRACT
1725 W. 5th	\$135,000
2290 Cty Road 34, Rexford	\$138,500
1040 Villa Vista	CONTRACT
1130 Terrace	EXCLUSIVE
1165 Wheatridge Road	\$210,000
1807 Harvey Court	\$265,000

**COMMERCIAL LISTINGS**  
 320 Main, Rexford, KS 3,240 sq.ft steel building with workshop, storage and living area, situated on five full lots. Call Rock today!  
 Commercial building site 1-10 acres North of I-70 on Willow Avenue East of Whistle Stop. Give Tom a call today!  
 63 Acre parcel or 2-6 acre lots located along I-70 frontage, Colby, KS. \$17,000/acre Call Marilyn!  
 1075 S. County Club CONTRACT

**AG LAND LISTINGS**  
 160 Acres Logan County Cropland - 13 South, 3 West and 1 South of Oakley, KS. - \$3,000/Acre Call Rock!  
 160 Acres Logan County CRP - 15 South of Monument, KS. - \$1,250/Acre Call Rock!  
 80 Acres Logan County Dryland - \$160,000 Call Tom!

See our entire selection at [www.waltermotorco.com](http://www.waltermotorco.com)



**LPN part-time needed** for growing Assisted Living Facility. Flexible hours, competitive wages, friendly and rewarding work environment. Apply at Fairview Estates Retirement Community, 1630 Sewell Ave, Colby - 785-462-2154, email resume to fairview@st-tel.net. EOE  
C 10/9-10/16

**Paraprofessional opening** at Colby Public Schools. Health Insurance and other benefits are available. Application available at the administration office, 600 W. Third Street, 785-460-5000 EOE  
C 10/9

**Assistant basketball coaches needed!** Coaches needed for boys and girls at the high school and middle school levels.

Application available at the administration office, 600 W. Third Street. 785-460-5000 EOE  
C 10/9

**Trucking Company in Northwest Kansas** has immediate opening for driver. Hauling grain, rock, and sand Monday through Friday. Local hauling, home every weekend. Paid weekly, must have a CDL and good MVR. Must have 2 years driving experience. Call for appointment (877) 850-7285 or (785) 678-8041.  
O 10/9 to 10/30

**Colby 24/7 Travel Store** has an opening for a full time Assistant Manager. Our employees are customer service oriented and have an outgoing personality. Benefits include, flexible hours, BCBS insurance,

401K, Paid Vacation, and Incentive pay. Apply in person at 24/7 Travel Store 1980 south Range. Also check us out on the web www.24-7stores.com.  
C 10/2-10/9

**FT Accounts Receivable Clerk** wanted at Rawlins County Health Center, Atwood, KS. Apply at www.rchc.us EOE.  
C 10/2-10/9

**SureFire Ag Systems is hiring** for full time seasonal positions. We develop and manufacture application technology used in modern farming businesses. We are looking for motivated individuals eager and willing to learn. Open positions include pulling/packing orders, shipping and assembly. These positions run from October through April with paid holidays. Apply on site at 9904 HWY 25 Atwood KS. or email

jason@surefireag.com  
C 10/2-10/9

**DL Cattle Trading**, out of Benkelman, NE has an immediate opening for a feedyard office manager/bookkeeper. The ideal candidate would have good computer skills and basic accounting knowledge. Having an agriculture (beef cattle) background would be a plus. The individual must be trustworthy and reliable. The job offers a very competitive salary and benefits package with housing provided. Interested individuals should contact Bill Sleigh at 614-800-4777 or email bill.sleigh@dlglobal.net.  
C 10/2-10/23

**FirstFleet Inc is looking to hire** Class A CDL driver for our Garden City, KS location for deliveries in Lexington, NE. 2 Yrs minimum Exp along with a clean safety/driving record

required. Great Pay, Great Benefits, Great People. Please Contact Matt Fisher, 816-214-1232, for more info.  
C 10/2-10/9

**Logan County Farm Service Agency** has a temporary full-time Program Technician position available. Salary ranges from \$24,933 to \$31,315 (Grade CO-3 to CO-5) depending on knowledge and experience. Must be a US citizen; high school education or GED. An agricultural background and general computer knowledge is not required, but helpful. Applications (FSA-675, Application for FSA county employment and KSA's, Knowledge, Skills and Abilities) may be picked up at the Logan County FSA Office, Oakley, KS between 8 a.m. and 4:30 p.m., Monday through Friday. Applications and KSA's must be returned to the office no later than 4:30 p.m., October 11, 2013. Please call the Logan

County FSA office with any questions at 785-672-4861. FSA is an Equal Opportunity Employer.  
C 10/2-10/9

**Receptionist wanted:** approximately 30 hours per week. Send resume to: 1401 Main, Goodland, KS 67735.  
G 10/2-10/9

**Schwan's - Colby, KS** Now taking applications! Must be 21 or older, good driving record, active license. Apply now: www.schwansjobs.com Questions: 785.462.2871  
C 9/25-10/16

**Village Inn is now hiring** all positions, all shifts, apply in person.  
C 9/25-10/16

**PART-TIME CNA NEEDED.** Goodland Home Health, contact Sue at (785) 821-0050.  
G 9/18-10/18

**WOOFER PUMP & WELL INC.**  
1024 Oak Ave.  
Hoxie, KS 67740  
Office Phone 785/ 675-3991 Fax: 785/ 675-3990  
Shop Phone 785/ 675-3023 E-mail: woofpw@ruraltel.net

**Irrigation, Domestic, Geothermal & Environmental Services**

- Irrigation Pump Repair
- Irrigation Well Drilling
- Domestic Well Drilling & Repair
- Environmental Drilling
- Windmill Repair
- Solar Systems
- Geothermal Pump Systems

For all your irrigation needs call: Lance Shepard (785) 675-8376

**506 Harrison - \$175,500**

You won't want to miss this lovely Stone Rancher in a great location! This spacious home offers 4 Bedrooms - 1.75 Baths, Formal Living Room w/ fireplace, Den/Dining Room with fireplace, roomy Kitchen which has generous storage. Sellers have completely remodeled the Main Bath, installed new Furnace and Air Conditioning, New Carpet and tile in the entryway. There is an abundance of storage with efficient closets everywhere. Outside you will find a patio, underground sprinklers, privacy fencing and semi-circular front drive-way. Don't Miss This One!!  
Call Rose TODAY!!

**HomeLand REALTY AUCTION**

**Rose Koggie**  
Associate Broker  
(785) 821-1179

**Tom Harrison**  
Goodland Managing Broker  
(785) 443-0136

4 Bedroom / 1.75 Bath

**STORAGE UNITS & 1940 PACKARD AUTOMOBILE AUCTION**  
**Tues, Oct. 22, 2013 @10:30 AM, CDT**

**AUCTION LOCATION:** On the property at 102 Albert St, Oakley, KS  
**Seller:** Eaton Trust

• 5 Storage Units on 7 lots with RV storage units and additional space for automotive or a small shop.  
• Natural gas & water  
• Immediate possession  
• 2012 taxes = \$1,900.72



**1940 PACKARD - RESTORED**  
Packard 160 series, 1803 - 4 door touring Sedan, straight 8, seats reupholstered, new tires, 2) spare tires-fender mounts, new engine overhaul, undercarriage has been painted.

**INTERNET BIDDING AVAILABLE!**

For a Virtual Tour visit  
[www.farmandranchrealty.com](http://www.farmandranchrealty.com)

**FARM & RANCH REALTY, INC.**  
1420 W. 4<sup>TH</sup> • COLBY, KS 67701  
Call Toll Free - 1-800-247-7863  
**DONALD L. HAZLETT, Broker/Auctioneer**  
"When you list with Farm & Ranch, it's as good as SOLD!"

**LOCAL TRADES YOU DON'T WANT TO MISS!**

 <b>2011 Acadia Denali</b> White Diamond, Leather, \$32,900	 <b>2007 Cadillac DTS</b> Beige, Leather... \$14,900
 <b>2006 Buick Lucerne</b> Glacier Blue, Cloth... \$10,900	 <b>2003 Buick Lasabre</b> Red, Leather... \$7,900
 <b>2003 Dodge Ram 1500</b> White, Leather... \$7,900	 <b>2002 Chrysler 300M</b> Gray, Leather... \$5,900

**FINLEY MOTORS, INC.**  
1520 Highway 27, Goodland, KS 67735 • Toll free: (800) 525-3701  
"YOUR VOLUME & VARIETY DEALER"  
[WWW.FINLEYMOTORSINC.COM](http://WWW.FINLEYMOTORSINC.COM)

**Immaculate Conception Fall Festival**  
Leoville Parish Center, Leoville, KS  
October 13, 2013 2:30 p.m.

Come join the fun fellowship and friends. Bingo starts at 2:30 p.m. There will also be a roast beef and turkey dinner from 5-7:30 p.m. Adults \$7, kids 5-12 \$3, and kids 4 and under eat free. Come join in the fun, fellowship and friends.

Raffle  
Auction  
Games  
Religious Store  
CYO stand

Ad sponsored by  
**The Bank in Jennings**

**Farm Equipment Antique Tractor & Truck AUCTION**  
**Saturday, October 12, 2013 • 10 a.m. CT / 9 a.m. MT**  
Location: From Tribune, Ks. 4 miles north to Rd. M, 4 miles west to Rd 12, 1 mile north to Rd L, 1 1/4 miles west

**FARM EQUIPMENT**  
1993 Ford Versatile 946 tractor, Designation 6, duels, 6,312 hrs., 20.8-42 tires, Ser.#930089 - 1972 Case 1370 tractor, duels, 3 pt., 9339 hrs, lots of recent repairs - Sunflower Richardson 9x5 sweep plow, new style pickers, new blades - (5) Melroe hoe drills, 8x12 - Richardson 7x5 sweep plow w/pickers - JD 16 ft. chisel - Richardson 5x5 ad flex sweep plow w/FK new style pickers - (2) JD one-ways - Ark Valley 15 ft. disk - Miskin 7 1/2 yard dirt scrapper - Overhead machinery carrier, 50 ft. - JD 40 ft. springtooth - Bandwagon 1000 gal. nurse trailer 1985 Blair 24 ft. goose neck trailer w/4 ft. dove tail.

**RESTORED OR RUNNING ANTIQUE TRACTORS**  
Turner Simplicity tractor, on steel, possible 1 of 4 in existence, good shape - Farmall B tractor, ne, gas - JD Model D tractor, Ser. #162924 - MM UB tractor, propane w/scoop, Ser. #09700764 - JD AR tractor, unstyled, steel wheels, Ser. #260926 - Simpson Jumbo Model C tractor, wf, Ser. #11442 - Farmall M tractor, wf, Ser. #fbk134510 - Cat 30 crawler tractor, Model 6G, Ser. #5786p - Cat 30 crawler tractor, Ser. #PS73 - JD 435 tractor, diesel, wf, ps, Ser.#437378 - MM Model BF tractor, wf - Case 800 tractor, LP, wf, 3 pt., Ser.#8122896 - Leader tractor 3pt., wf - Leader tractor, no 3pt., wf, Ser. #269 - Massey Harris 44 tractor, standard, wf, Ser. #G51452 - Earth Master tractor, wf - (2) Ford 9N tractors, 3 pt. - 1928 Hart-Parr 28-50 tractor, scarce - AC Model WC tractor, wf, Ser. #31367 - Oliver 99 tractor, gas - JD Model R tractor - MM Model GB tractor, diesel - Oliver 88 tractor, diesel, Ser.#8266035C88.

**RESTORABLE TRACTORS AND PARTS**  
Twin City tractor, 20-35, Ser. #8788 - MH 202 tractor - Case DC tractor - Case L tractor - MM tractor - JD Model GP tractor - JD Model G tractor - Moline Universal tractor - (2) CO-OP tractors - Oliver 80 tractor, row crop - Case Model DC tractor, row crop - Cat 22 crawler tractor - Cat D-4 crawler tractor w/Trackson loader - McCormick Deering 15-30 tractor, Ser. #123205M - JD model GP tractor, in pieces, Ser. #220705 - Twin City, Oliver, JD, Wallis, IHC and many other tractors to restore or for parts, approximately 75 total - Implements for these older tractors.

**OTHER COLLECTABLE FARM ITEMS**  
Several antique combines & threshing machines - Old truck frames - Wagon wheels & steel wheels - IHC 22 threshing machine - (10) one cylinder engines: JD, IHC, Fairbanks - Lots of parts for one cylinder engines & other small motors - Clipper grain cleaner - Antique car radiators - Lots of collectable truck & car parts - 4-wheel grain wagon - 4-wheel Montgomery Ward grain wagon, metal - Cast iron stove parts - New crank shaft for 1530 IHC tractor.

**TRUCKS AND PICKUPS**  
1962 Studebaker truck, 5x2 spd trans., Detroit 453 diesel motor, 16 ft. bed & hoist, roll over tarp - 1959 IHC AC 180 truck, 5x2 spd. trans., Detroit 453 motor, 16 ft. bed & hoist, w/Westfield hydraulic drill fill auger - 1967 Ford 1-ton pickup w/ flatbed, 4 spd. trans., dually - 1970 IHC 1/2 ton pickup.

**COLLECTABLE PICKUPS, CARS & OTHER ITEMS**  
1966 Olds Ninety Eight car, 4 dr., LS, clean - 1949 KBI IHC pickup, 4 spd., 6 cylinder - 1949 Chevy Fleetliner car, 2 dr., restorable - 1960 Ford Falcon car, 4 dr. - Several old Model T trucks & parts - Other old trucks - Honda 175 motorcycle - 25 hp. boat motor - Large safe from US post office.

**OTHER FARM & SHOP ITEMS**  
Davis grain roller mill, 10 x 30 - Several small augers, 110 volt - 900-20 tires, like new - Other used tires - White Witte generator w/engine, 12.5 kw, on trailer - (30) Joints of 3" drill stem - Hog panels - 3 pt. post hole digger - 500 bushel bulk bin - Lincoln DC portable welder, 225 amp - Pratt Whitney Large metal lathe, 14", extra pieces (nice) - Some scrap metal - Many other items

Richard and his dad were one of the foremost antique tractor collectors in the area. This should be a neat auction.  
**Rusty Iron Farm • Richard Wendelburg owner • 620-376-4365**  
Lunch served  
Terms: Must show ID to register. - Cash or approved check day of sale. Not responsible for theft or accident. - All items sold as is. - No warranties expressed or implied. - Announcements day of sale take precedence.  
[www.berningauction.com](http://www.berningauction.com) & Facebook

**760+/- ACRES CROPLAND & GRASS**  
**NORTON & PHILLIPS COUNTIES, KS**  
**LAND ABSOLUTE AUCTION**  
**THUR., OCT. 17, 2013 @10:30 AM, CDT**

**AUCTION LOCATION:**  
Dane G. Hansen Museum, Logan, KS

Property will be offered in 4 tracts & combinations.

**SELLERS:**  
**Bowman Family**

**LEGAL DESCRIPTIONS:**  
**TRACT 1:** SE/4SW/4 & S/2SE/4 of 31-4-20  
**TRACT 2:** N/2SW/4, SW/4SW/4 & SE/4NE/4 of 31-4-20  
**TRACT 3:** N/2SW/4 plus acres S of Yankee Road in NW/4 of 6-5-20  
**TRACT 4:** NE/4 & N/2SE/4 of 1-5-21 and Approx 50 acres N of Yankee Road in NW/4 of 6-5-20

This combination farm is located on the North Fork of the Solomon River just outside Logan, KS. It offers first bottom river land and excellent hunting potential. All 4 tracts are contiguous with 320 total acres of cropland, balance in grass. Multi-parcel auction method lets the Buyer buy 1 tract, any combo of tracts or entire property!

**INTERNET BIDDING AVAILABLE!**  
For virtual tour visit  
[www.farmandranchrealty.com](http://www.farmandranchrealty.com)

**FARM & RANCH REALTY, INC.**  
1420 W. 4<sup>TH</sup> • COLBY, KS 67701  
Toll Free - 1-800-247-7863  
**DONALD L. HAZLETT**  
Broker/Auctioneer  
"When you list with Farm & Ranch, it's as good as SOLD!"

**YOST**   
800-524-9678 785-332-2188 yostford.com  
Sales Manager — Brent Rueb Like us on Facebook Yost Ford

**Get your wheat planted -then- Stop in and see us during our YEAR-END SALES EVENT**

**We need your good late model trade in.**

**The New yostford.com at the New Yost Ford**