

US Postage Paid
STANDARD RATE

POSTAL
CUSTOMER

We reach more than 42,000 readers each week!

The Country Advocate

The 900-pound gorilla of northwest Kansas advertising!

Week of January 8, 2014

A common section produced by/supplement to The Oberlin Herald, Colby Free Press, The Goodland Star-News, Bird City Times, The Saint Francis Herald, The Norton Telegram and The Western Times



CARD OF THANKS

hours for January & February 10-3.

CFP

I WISH TO THANK everyone for my birthday cards, pictures and gifts and coming to my party. Great day with family and friends. – Joyce Sumner
N 1/6

Help for Abused women and children. Open 24 hours a day, seven days a week. Call Northwest Kansas Shelter, 800-794-4624.

SFH tfn

NOTICES

FREE informational seminar. Bring your own laptop. Every Tuesday at 4:30 p.m. Mortensen Computer Services, 101 S. State, Norton.

N tfn

Happy New Years from that tree guy Kerry at Infinite Connections. Get on his schedule for 2014 - 785-626-4261.

C 1/8 - 1/29

Steamway Carpet Cleaning Co. 1-800-292-9497.

N tfn

Plum Creek Ltd. Winter Clearance. New Saturday

MAIL IN YOUR AD

Use this convenient form to mail in your ad!

Name _____

Phone Number _____

Address _____ City _____ ST _____

Write one word per line, phone number is one word.

_____	_____	_____	_____	_____
_____	_____	_____	_____	_____
_____	_____	_____	_____	_____
_____	_____	_____	_____	_____
_____	_____	_____	_____	_____
_____	_____	_____	_____	_____
_____	_____	_____	_____	_____
_____	_____	_____	_____	_____
_____	_____	_____	_____	_____
_____	_____	_____	_____	_____
_____	_____	_____	_____	_____
_____	_____	_____	_____	_____

Phone # _____

\$9.45 first 15 words & 55¢ each additional word (per week)

Cost of ad per week \$ _____

Number of weeks to run X _____

TOTAL COST OF AD = _____

CLASSIFIED DEADLINE IS FRIDAY AT NOON! Ads not accompanied by payment when mailed or called in will be subject to a \$4 billing fee. Your ad will run one week in The Country Advocate and the paper of your choice.

Mail your ad and check to:

The Goodland Star-News • 1205 Main
Goodland, Kan. 67735 • (785) 899-2338

Colby Free Press • 155 W. 5th
Colby, Kan. 67701 • 785-462-3963

The Oberlin Herald • 170 S. Penn Ave
Oberlin, Kan. 67749 (785) 475-2206

The Saint Francis Herald • Box 1050
St. Francis, Kan. 67756 • (785) 332-3162

The Norton Telegram • 215 S. Kansas.
Norton, Kan. 67654 • (785) 877-3361

The Country Advocate

ECO ACRES

BUILD HERE

HomeLand REALTY/AUCTION
“Western Hospitality”
1055 S. Range Ave. - Colby, KS 67701

Residential Lots each 1/2 Acre + \$14,000 to \$19,000

Call Pat today!
Office: 785-462-8255 Cell: 785-443-3261

Let the **Gorilla** help sell your stuff



If you're planning a garage sale, be sure it's in **The Country Advocate**

Invite the 900-pound Gorilla to help with your garage sale. You'll have more customers, sell more stuff and make more money. That means more in your pockets at the end of the day, and less junk to haul off to the dump.

How does it work? Simple. While the paper reaches most families in the town, The Country Advocate goes all over northwest Kansas. It reaches 41,860 readers in 11 Kansas counties, plus parts of northeastern Colorado and southwest Nebraska.

That's why it's the 900-pound Gorilla of Northwest Kansas Advertising, reaching more homes and more people than any other publication, broadcast station, cable system, Internet page or advertising medium.

Reader after reader has tried The Advocate for their advertising. The results?

Stuff sells. People drive for miles to find a good sale. They don't want to walk away empty-handed. The Gorilla works.

Your newspaper makes it easy for you to be in The Advocate. Just call or stop by and place your ad. You'll be surprised how easy it is, and how affordable. You'll be surprised — and happy — when your phone starts to ring or people show up at your door.

But call today. Deadline for The Advocate is noon Friday, ONE WEEK BEFORE a weekend sale. Sure, you can get an ad in the paper later, but it won't be the same. Call the Gorilla.



**COLBY
FREE PRESS**

155 W. Fifth Colby, Kan. 67701
(785) 462-3963

**THE NORTON
TELEGRAM**

215 S. Kansas, Norton, Kan. 67654
(785) 877-3361



THE OBERLIN HERALD

170 S. Penn Ave., Oberlin, Kan. 67749
(785) 475-2206

**The
Goodland Star-News**

1205 Main, Goodland, Kan. 67735
(785) 899-2338

Bird City Times

Box 220, Bird City, Kan. 67731
(785) 734-2659

The Saint Francis Herald

Box 1050, St. Francis, Kan. 67756
(785) 332-3162

Company's Coming: Carpet Cleaning Special - Any 3 Rooms only \$174.95! Dry-Foam safe & Green Seal approved. Serving NWKS mileage free since 1987. Call today: A+ Cleaners (785) 538-2526 or (785) 443-5400, Johnene Cheney. N 1/8

HELP WANTED

Direct Contact, Inc is currently seeking Field Technicians to assure that all planters are field ready. Calibrations of already installed units, conversions, adjustments, repairs, etc. Interested candidates contact Amy Theobald, 1-800-558-6803, ext. 105 or email amy_theobald@directcontact.com. C 1/8 - 1/15

Temporary, part-time, general chrome shop help wanted. Apply in person at Truck Town, 105 W. Horton Ave., Colby, KS. Please ask for Tori. 785-462-8785 C 1/8 - 1/15

Homestead Nutrition Project is accepting applications for an assistant cook at the Colby Sr. Center Meal Site. M-F 7:30 a.m. - 1:00 p.m. No evenings, weekends or major holidays. Vac/Sick/Holiday pay and KPERS offered. Please call 1-800-432-7422. C 1/8

Part-time Help Wanted at home-based daycare. Call 785-460-8261 for more information. C 1/8

We are looking for a full-time experienced electrician. Please send resume with references or pick up an application 785-462-6692. C 1/8-1/15

High Plains Mental Health Center currently has an opening for either a full time or part time Branch Office Support Staff at our Branch Office in Colby. Qualified candidate should have good secretarial and office skills, handle multi-line phone system, and data entry. Candidate must also successfully pass a KBI background check. Interested applicants -

respond via mail to Maureen Mindrup, Human Resources Manager, High Plains Mental Health Center, 208 E. 7th St., Hays, KS. 67601, or by e-mail to Jean Montgomery at jean.montgomery@hpmhc.com. HPMHC is an Equal Opportunity Employer M/F/D/V. C 1/8-1/15

You have a Pickup & Trailer? Want to work for yourself? We are looking for you!!! We are looking for self motivated & dependable individual looking to work as a wholesale food distributor in Western Kansas. If you are interested in being your own boss email contact info to: guy@just4userv.com. 12/20-1/27-

Position Available: Looking for an OTR driver, CDL required, clean MVR, have 2 years driving experience, will train the right person, drug testing required. 785-675-8581. C 12/25-1/15

Wagoner Repair & Performance, 1100 S. Country Club Dr., Colby, KS 785-460-1081. If you are a diesel mechanic or an auto mechanic and you are interested in working decent hours, with weekends by choice, please apply. Health insurance is optional. C 12/25-1/8

Dundy County Hospital has an opening for a full-time maintenance tech. Preferred applicants would have general construction knowledge, lawn care experience, basic electrical knowledge, as well as mechanical boiler and piping experience. Position will require evening on-call time as well as every other weekend and alternating holidays. Must possess a valid driver's license with a clean driving record and have trailer towing experience. Basic computer skills are required. Employment offer will be contingent on passing pre-employment physical and drug/alcohol screen. Applicants must be able to lift 50lbs, bend, kneel, and work in a fast paced environment. If interested

pick up an application at the reception desk at DCH or call Vince Turpin @ 308-423-2204. DCH - EOE. G 12/25-1/8

Great Western Tire of Colby, Inc., 1170 S. Country Club Drive, is now accepting applications for all positions. Experience required, but will train the right person. Valid driver's license is a requirement. Full time position includes competitive salary and benefits. Apply in person, EOE. Questions please call 785-462-2100. C 12/11-TFN

Decatur County Road and Bridge is taking applications for full-time employment. Employee will be subject to random drug and alcohol testing and will be required to obtain a CDL. Applications available at Engineer's Office. Call (785) 475-8111. Decatur County is an Equal Opportunity Employer. O 4/24tf

Help Wanted: correspondent for Rexford. Send news via e-mail once a week. Paid by inch and receive free subscription to The Oberlin Herald. O 1/30 tfn

PSI Transport is always looking for good company livestock and grain haulers as well as shop mechanics. Competitive pay, life/health/dental benefits and bonus program available. EOE. (785) 675-3477. G 6/15-TFN

PSI TRANSPORT is looking for owner operator to pull livestock trailer. Good rates, weekly pay and consistent work. Have modern equipment. Run the midwest. Call (785) 675-3477 or (913) 533-2478. Call Monday-Friday, 8 a.m. to 5 p.m. PSI TRANSPORT is looking for professional drivers to haul cattle in the midwest. Industry leader in pay w/ health insurance, retirement

plan, and other incentives upon hire. Excellent equipment. Pay every week with direct deposit. Class A CDL required. Call (785) 675-3477 or (913) 533-2478. Call Monday-Friday, 8 a.m. to 5 p.m. I can be reached at bthumme1@feedcattle.com. N 1/8

Carriers Wanted: The Norton Telegram is looking for Carriers. For more information call Marcia or stop by the office at 215 South Kansas Avenue, Norton. Phone 785-877-3361. N tfn

Valley Hope Association is seeking a Corporate Customer Service Specialist to work as a part of an office team to maintain several administrative duties. This position is located in Norton, KS. Successful candidates must have a valid driver's license. Excellent working environment with a competitive salary and benefits package available. Email resume to employment@valleyhope.org. EOE. N 1/15

ATTENTION: Truck Drivers. Valley Feeds Trucking: Long Island KS. is looking for a dependable and self motivated person to join our team driving a company semi, hauling livestock, grain and feed commodities. Driver is home most evenings and weekends. A class A CDL and clean driving record is a must. Excellent Pay Package, BC/BS Insurance, Longevity and Safety bonus, 1 weeks paid personal leave and more. Please call Jeff or Paul for more information and or confidential interview, N 1/8

785-854-7867, Ext 3, or 785-202-1751 evenings. N 1/8

ARE YOU LOOKING for good, solid, employment with great benefits and also presents a challenge and is rewarding? Norton Correctional Facility is looking to hire Corrections Officers. Starting pay is \$13.61 plus shift differential pay. Benefits include health, dental and vision insurance, paid vacation, holidays, and sick leave, KPERS retirement, and much more. There are promotional opportunities which make it a great career choice. You may call the NCF Human Resource Office 785-877-6643 to obtain an application or apply online at www.jobs.ks.gov. The job flyers can also be viewed at this web site. Online applications can be emailed to ncfr@doc.ks.gov. N 3/5

PHILLIPS COUNTY RETIREMENT CENTER has openings for LPN's and RN's. Offering part-time or full-time employment, good wage and benefit package including paid single health and dental plan. Please call 785-543-2131 for more information or stop by 1300 State Street to pick up an application. N 1/8

DOOR & WINDOW REPLACEMENTS
SEAMLESS RAIN GUTTERS
GENERAL CARPENTRY REPAIRS
Ron Lucke
CUSTOM BUILDING
(719) 346-8840
CELL: (719) 349-8840

WANTED
Want to buy: John Deere diesel engines, running or not. Call (785) 263-6275. G 12/4-2/4
Junk batteries, non-ferrous metals and iron. Darrel Bowen. Phone 785-899-2578. G tfn

Wish to purchase Farmland within 25 miles of Long Island, KS. Call Kevin Tubbs at 785-664-8022. N tfn

ARE YOU LOOKING FOR AN EXCITING NEW CAREER? JOIN THE CLEARY TEAM!!

CLEARY BUILDING CORP.
NOW HIRING FOR CONSTRUCTION FORMAN

Cleary is a family owned, debt-free, national leader in pre-engineered building construction. We are seeking responsible, hard working, energetic personnel. Construction experience is preferred, but we will train the right candidates.

Join our team of champions!!
VALID DRIVER'S LICENSE REQUIRED
MUST BE 18 YEARS OF AGE OR OLDER
FULL TIME WORK AND FULL BENEFITS
TOP WAGES for the RIGHT INDIVIDUALS
APPLY TODAY!!
www.workforclearybuildingcorp.com
990 S. Range Ave.
Colby, KS 67701
(785) 462-2023
Mon-Fri 8 am - 5 pm

Dietary Aide Position

Come Join our Good Samaritan Dietary team as a Dietary Aide p/t positions available with potential f/t and evening aide positions 5-7:30. Great opportunity. All shifts offer good pay and benefits with flexible schedule. Apply online @ www.good-sam.com or in person at Good Samaritan Society, 108 E Ash Oberlin. EEO



Available Opportunities...

Regional Drivers Needed in Central and Northwest Kansas

We are seeking safe, hard-working individuals who desire a career with a solid company. Drivers will be home daily and have scheduled days off.

Competitive compensation packages available.

Must have over-the-road tractor trailer experience, a safe driving record and hold a CDL with an X endorsement.

To view a complete list of our career opportunities, visit www.CVRRefining.com/Careers.

Coffeyville Resources Crude Transportation, LLC is an Equal Opportunity Employer (EOE). Qualified applicants are considered for employment without regard to age, race, color, religion, sex, national origin, sexual orientation, disability or veteran status.



Time for a New Career?

The Goodland Star-News is looking for a **FULL TIME ADVERTISING EXECUTIVE** to join our team selling advertising for Nor'West Newspapers. Work week is 40 hours. Computer skills are helpful but not required. Must have good communication skills, excellent customer service skills with attention to detail, and enjoy a fast-paced atmosphere.

Send a resume to: **Kevin Bottrell, Editor,** 1205 Main, Goodland, KS 67735, or apply in person. No calls please.

The **Goodland Star-News**
1205 Main, Goodland, KS 67735

PBC
Pepsi Beverages Company of Colby, KS has an **IMMEDIATE** opening for:
Burlington, CO Part Time Merchandiser
Please review the detailed job descriptions, requirements, and apply online TODAY at www.pepsico.com/careers
PBC is an Equal Opportunity Employer

NOW HIRING
MONTANA MIKE'S STEAKHOUSE

Part Time:
Kitchen Staff & Servers
APPLY IN PERSON
1855 S. Range Ave.
Colby, KS

NOW HIRING!
Front Desk Clerks; Cooks; Housekeeping; Servers; Maintenance
Flexible hours. Full and part-time positions available. Great benefits including insurance, vacation pay & 401K. Top pay. Certification bonus. Monthly bonus program. Employee discount at Penny's Diner. Excellent promotional opportunities, Dynamic training program. APPLY TODAY! 801 N. Highway 27. Front Desk Clerks/Van Drivers must have good driving record and be able to pass a drug test. (Junction of Hwy K-27 @ US-40) Sharon Springs, KS Phone: (785) 852-4664. (785) 852-4665-fax. sharonspings@mail.oaktreeinn.com

Penny's Diner

VAP CONSTRUCTION, INC.
STEEL AND POST FRAME BUILDINGS

SPECIALIZING IN CUSTOMIZED STEEL AND POST FRAME BUILDINGS
WE WILL BEAT ANY NORTHWEST KANSAS COMPETITOR'S PRICE ON A COMPARABLE PROJECT!!
AFFORDABLE • SUSTAINABLE • LOW-MAINTENANCE • MULTI-PURPOSE
Vap Construction, Inc. offers numerous design styles, sizes, exterior finishes, accessories and colors for your Commercial, Agricultural or Residential Building.
CONTACT US FOR A QUOTE TODAY! CALL: 866-492-1978
Serving Kansas, Nebraska, Colorado and Wyoming • Fully insured with over 25 years of experience
For more information visit: vapconstruction.com • 605 North 10th Street | Atwood, KS 67730

Wanted: Grass to rent or purchase in Norton or Graham County. Contact Lee Hardy at 785-871-0832. N tfn

Wanted to lease: Bowhunting family interested in leasing land for archery deer and turkey hunting in the Norton and Oberlin areas. 970-531-2671. N 1/13/14

ORIGINAL CN license plates in good condition. 1960, 1965, 1969. 620-846-0398. 01-02c.

SFH 1/2-1-9

SERVICES

Hickert Enterprises LLC. Windmill repair and service. Tree trimming and removal. (785) 475-2729. O 1/1-6/25

PLEXUS...Serious product for serious people who

seriously want to get healthy and/or lose weight. Call (785) 332-4381.

G 11/20-tfn

Burlington-Goodland area. Residential overhead door service and repair, 20 years experience. Call Gary at (719) 350-0705.

G 7/17-tfn

Do you have weeds every year? Want a great looking yard? Call JM Tree & Lawn Service to fill ALL of your needs this year. We offer full tree care and sprinkler system maintenance/installs as well. Call today to get a free quote. 785-462-6908.

C 5/22-TFN

BECKMAN Carpet Cleaning: Truck-mounted steam cleaning. Carpets, upholstery and autos. Call (785) 626-4548.

SFH tfn

Have a leaking roof and

need it repaired? Look no further. Murray Roofing & Construction, LLC will give you a free estimate and roof inspection. We specialize in residential and commercial roofing systems. Call our office to schedule an inspection. 785-462-6908.

C 4/3-TFN

Call us before you pay your next insurance premium. American Family Insurance - Rita Peters Agency - Colby 785-462-8246.

C 1/25-TFN

CAT'S TNT for jewelry, material, vinyl graphic designs, massages, quilting and more! Stop by 1018 Main, Goodland, or call (785) 890-2287 for more information.

G 3/28-tfn

Experienced with texturing, painting, cleanup/removal of clutter. Experience with Rental management

experience. Have 16 ft. car trailer for rent. 785-462-5861.

C 3/25-TFN

Abel Tree Service-Fully insured, free estimates, stump grinder, bucket truck. 785-871-7275.

N tfn

Dan is back! Dan Geschwentner. Small remodeling and repair jobs. Call 785-443-3673.

C 2/3-TFN

Jacobs Service, your authorized Traeger Grill dealer. See our selection of grills, pellets, rubs and spices at West Highway 36, Norton. Pellets are \$13.50 per bag EVERY DAY!

N tfn

Septic Tanks Pumped and systems installed. Call Logan Septic and Water. 785-543-7772.

N tfn

A&S Plumbing 24/7, 20 years experience. No job too big or small, fully insured. Ask about our 10% discount for parts and labor for first time customers. Spencer Stevens, owner. 785-664-8180.

N tfn

PETS

Registered Toy Poodle puppies. 2 males and 1 female. Black, black and tan. \$200. Call Deb (785) 475-2054.

O 1/8-1/15

FOR RENT

Spacious 1 bedroom apartment in Goodland. No smoking, pets negotiable. Call (307) 575-0975.

G 1/8-2/8

1 bedroom house in

Goodland. \$350/month plus deposit and utilities. No pets please. Call (785) 332-2589. G 1/1-1/8

2 large bedroom home in Goodland. Call mornings or late evenings, (785) 891-3761 or (785) 694-1683. G 1/1-15

RV lots available in newly-renovated mobile park in Goodland. \$185/month and \$50 deposit. Sunflower Estates, call (785) 728-7222. G 12/11-1/11

For rent: 2 bdr. apartment, close to downtown Oberlin, partly furnished, city bill paid, \$350 per month plus \$350 deposit. Contact Johnson Realty, Inc. (785) 475-2785. O 11/13tfn

2 bedroom apartment, Brookwood Apartments, Oberlin, (785) 475-3450. O 36tf

The Country Advocate Service Directory

LOCAL HEADSHOP IN BURLINGTON, CO!

The new age has arrived!

JANUARY SPECIAL: Mention this ad and get 10% off 1 item!

Medical card holders: 10% off 1 item • Veterans: 15% off 1 item
Now carrying pipe tobacco, cigarettes, cigars, hookah tobacco and vaporizers!
E-juice: 5 different MG in multiple flavors! Also carry nicotine & non-nicotine e-hookahs and e-juice

G&G Freds' Tobacco, Pipes & Accessories

All pipes & accessories intended for tobacco use. 415 14th, Burlington, CO • Beginning Dec. 26 Open 9 AM-7 PM
Phone: (719) 212-7048 or (719) 342-0503 (after hrs)

Langer Industrial Service

2022 County Road 11 • Levant, KS 67743 • 785-586-2208
Monday - Friday 8 a.m. - 5 p.m.

We pay cash up to for all scrap metal*

Brass • Copper • Aluminum • Batteries • Electric motors • Cars
• Combines • Farm Equipment • Prepared/Unprepared Iron and Tin
• Container Service • Off site baling and car crushing
• Limited pickup service available

Schedule deliveries after normal business hours by appointment when necessary

* Some Conditions Apply

Guitars & Band Instruments

"No need to go to the city for your instrument needs. Come see us the The Music Box!"



- Rent or purchase
- Instruments made in the USA
- ACCESSORIES (reeds, drumsticks, strings, pads, etc.)



430 14th Street, Burlington, CO • Phone: (719) 346-9407
Open Friday and Saturday from 12-5 p.m., or call for weekday appointments

Lessons • Repairs • Instrument Rentals

In the Nation, we step up for life's moments.

You were there for their first step. But how do you protect their next ones? By adding Nationwide life Insurance to your financial plan, you can take the first big step toward showing your family how much you care about their future. We put members first because we don't have shareholders.

Join the Nation that walks with confidence.

Contact your Nationwide agent to find out more about life insurance from Nationwide.

Join me in Colby.

Shirley D Skolout
Mountain Plains Agency LLC
1690 W. 4th St., Colby
(785)460-6284
skolos1@nationwide.com



Nationwide is On Your Side.®

Products underwritten by Nationwide Mutual Insurance Company and Affiliated Companies, Columbus, Ohio. Not all Nationwide affiliated companies are mutual companies and not all Nationwide members are insured by a mutual company. Nationwide, Nationwide Insurance, the Nationwide framework, and Nationwide is On Your Side are service marks of Nationwide Mutual Insurance Company. © 2012 Nationwide Mutual Insurance Company. LAM-1873AD (01/12)

Call your local newspaper today to find out how this space works for you!

Celebrating 40 years in business!



BANNERS - LETTERING - PINSTRIPES - ART
Award winning Quality signs since 1974
204 W. 4th Bird City, Kansas
785-734-2423



Dr. Tom Barlow

DENTIST

785-460-7538

Appointments Readily Available

505 H N. Franklin, Colby

MURRAY ROOFING & CONSTRUCTION

RESIDENTIAL • COMMERCIAL • INDUSTRIAL

Residential:

- Roofing
- Construction
- Remodels
- Blown in Insulation



Commercial:

- TPO, EPDM, Duro-Last, Modified, Fibered and Non-Fibered roof coatings.

Fully Insured, Bonded, Licensed and Covered by workman's Comp.

Office: 785-462-6908

Office Manager: 785-443-5708
Owner: 785-443-1339



Elite Dura-last Contractor

CHECK OUT OUR WEBSITE FOR MORE INFORMATION:

www.MurrayEnterprises.org

Paw Wash Pet Crematory
6445 Rd. 21, Goodland
Kathy Schermerhorn
Please leave message
CELL PHONE: (785) 899-4398
Private or Group Rate

Mobile Home Lots for Rent

\$175 Month
(includes water, sewer & storage shed)
FREE Month with approved application

Friendly Acres Mobile Home Park

1150 S. Franklin, Colby
Call 785-462-6445

Windy Plains Bike Shop

Professional bicycle repairs since 1978!
Parts, accessories and service for all makes.
Pick up and delivery available in Goodland!

TIRED OF FLATS?
ASK ABOUT OUR NO FLAT GUARANTEE!

Harold Snethen
6085 Rd. 17

(785) 899-4786 • (785) 899-5858 (home)
Same day service on most out of town repairs!

KANSAS Insurance INC

Formerly THOMAS County INSURANCE AGENCY



Dennis Tubbs
dtubbs@kansasins.com

490 N. Franklin 785-462-3939

- Home & Auto
- Farm & Crop
- Business Insurance
- Boat, Motorcycle, RV



On Your Side.®

www.kansasins.com

Certified Insured & Bonded



When Time Matters & Quality Counts



Roofing, Siding, Gutters

General Construction (Decks, Porches)

Post Frame or Steel Buildings

Unbeatable Steel Building Prices Residential & Commercial Save With Quality



308-345-3242
www.cteroofing.com



FARM & INDUSTRIAL PAINTING
Grain Bins, Barns, Morton Sheds, Barn Repairs, Metal Roofs
ALL COLORS! TRI-STATE PAINTING
Pat Castella 1-800-940-8289 leave message
FREE ESTIMATES!

NEW SYSTEM PROFESSIONAL WINDOW CLEANING

(785) 462-6995 (800) 611-6735

www.MyWindowCleaner.net
Serving Colby since 1992!

Commercial • Residential • Free Estimates

SPEEDLINER Moonlight Liners



Spray-In Bedliners

Scott Gilmer

819 W. 8th • Goodland, KS 67735
(785) 890-5384
Evenings & Weekends

Looking for wheat straw or damaged wheat to bale

Kroskob Brothers Farms
Custom Haying and Farming

Will Prepay to secure Acres
Call for Pricing

Brandon: 970-380-4256 or Travis: 970-380-6853

FIFTH STREET APARTMENTS in Bird City has for rent two-bedroom duplex apartments. Applications must income qualify. For information contact N.W. Kansas Housing, Inc. at (785) 421-2151 or pick up an application at Century II in Bird City. We offer Equal Housing Opportunity and are handicap accessible.
SFH tfn (52)

Downtown office space available at 5th and Franklin, Colby. Call 785-462-3939.
C 9/19-TFN

One bedroom apartments available to rent in Norton. Contact: Lacy Frack, PHM Executive Director, Norton Housing Authority KS034, Phone 785-877-2714; Fax 785-877-2577.
N tfn

One Bedroom Apartment. Newly remodeled with updated kitchen cabinets and bathrooms. Close to Hwy. 36 and hospital in Norton, KS. Furnished or unfurnished. All utilities included. Laundry facilities on premises. \$350 per

month. No pets or smoking inside. Call (785) 202-1167.
N tfn

Independent living apartments at Prairie Meadows and Bieber Cottages in Norton now available for persons 55 years and above. For more information about these comfortable living apartments, call Administrator Nancy McGinnis, phone 785-877-2601.
N tfn

Houses & Apartments.

Cole Real Estate in Goodland 785-899-2683.
G tfn

REAL ESTATE

2 bedroom, 2 bath with one car garage house trailer in Brewster, move in ready, all appliances included \$7,500. 785-462-0528.
C 1/8

REAL ESTATE SERVICES

It pays, not costs to use

our services. For all your real estate needs contact Duane McEwen at 785-877-3032. Homerange Real Estate, Broker Gary Richards.
N tfn

Make the Weiser Choice - Contact Weiser Realty for all of your real estate needs at 785-877-2185. Jolene L. Weiser, Broker; Samantha M. Hager, Sally Nelson, Robert Wyatt, salespersons.
N tfn

Professional Service Listing and Selling your

property. Contact Larry Riggs, Broker or Jeanette Krizek, Listing Agent. 785-678-7163. Kansasland Realty and Auction.
N tfn

FARM SERVICES/ EQUIPMENT

2012 Wilson Grain trailer. 43x96x66. Air ride, ag hopper, 90% virgin tires and brakes. Call (785) 821-2009.
G 11/20-1/22

The Country Advocate Service Directory

New to Western Kansas!
Newbanks Pumps, Inc.
We sell the best and service the rest!
Water Well Drilling & Service
- Irrigation wells - Domestic wells
- Stock wells - Solar Systems
Curt Goble, Owner
Ph: (785) 899-6302 ~ Email: newbankspumps@gmail.com
CO #841 • KS #856 • Elec. Cont. #6127

Looking for a better return?
If you have CDs about to mature or other assets to invest, consider all of your options. Not only do our fixed annuities offer you a competitive return, they also offer you flexibility, security and guarantees.
To see how simple it can be to save for your future, contact us today.
FARM BUREAU FINANCIAL SERVICES
Insurance • Investments
Auto | Home | Life | Business | College | Retirement

NEW YEAR SPECIAL
applies to in-stock products
Buy 1....SAVE 10%
BUY 2....SAVE 15%
BUY 3....SAVE 20%
Excludes Carmex products. Offer expires 1/31/2014
Amazing Hair & Nails
Melody Knudson: Owner/Operator
Lisa Roberson & Amber Barrie: Hair Extraordinaires
1016 W. Highway 24, Suite #2, Goodland • Ph: (785) 890-4440

WANTED: DIRTY CARPET
IF YOU HAVE DIRTY CARPET, WE CAN STEAM CLEAN IT.
NO JOB TOO BIG OR TOO SMALL!
Cleaning NW Kansas one house at a time!
• Commercial/Residential
• Advanced Truck Mounted Steam Cleaning Equipment
• Water Damage Restoration
• FREE ESTIMATES
PRO FLOOR CARE
Carpet & Upholstery Cleaning
(785) 462-8313 or (800) 473-4138

Nancy LePell Bookkeeping
165 East 3rd - Colby, KS 67701
785-462-7428
Income Tax Preparation - Individual, Business and Estates
Accounting and Bookkeeping
Business and Financial consultation
Christy Griffith, RTRP Nancy LePell, EA, ChFC, CB
Working to bring you the best possible solutions

One combined policy + One deductible for it all
One big sigh of relief
When things go wrong, you need your insurance to go right. Contact me to see how our **one deductible advantage** can help provide you peace of mind when you need it most.
David Browne III
550 N Franklin Ave
Colby, KS 67701
785-462-3388
FARM BUREAU FINANCIAL SERVICES
Insurance • Investments
Auto | Home | Life | Business | College | Retirement

Culligan
better water. pure and simple.®
• Drinking Systems • Water Softeners (Sales & Rentals)
• Water Coolers • Salt Sales & Delivery
Scheopner's Water Conditioning, Inc.
Goodland & Colby, KS • Toll free: (800) 536-2352

NKBA
The Kitchen & Bath Professionals
• Kitchen Cabinets • Counter Tops
• Closets • Furniture • Commercial
• Entertainment Centers
• Custom Jewelry Closets
Mingo Custom Woods
1965 W. 4th St., Colby, KS • 800.320.2201
www.mingocustomwoods.com • 785.462.2200

BURLINGTON FAMILY DENTISTRY
Justin Evanson
DDS, MD
Oral Surgeon
Jason Ehtessabian
DDS, FAGD, PC
Fellow of the Academy of General Dentistry
Dr. Justin Evanson **Dr. E**
IV Sedation, Wisdom teeth removal, Implant placement, and Exceptional Comprehensive Dental Care for the Entire Family!
(719) 346-8266 340 14th St. Burlington, CO
www.burlingtonfamilydentistry.net

Questions about health care reform?
We have the answers.
You have new health insurance options, but which one is right for you? We can help you understand your options and select the right plan for you and your family.
I'm ready to help. Give me a call today!
Vernon Hurd
Farm Bureau Agent
550 N. Franklin Ave.
Colby, KS 67701
785-269-9511
www.VernonHurd.com
KANSAS FARM BUREAU
The Voice of Agriculture
CoventryOne.
Products available at Farm Bureau Financial Services
CHCS1765 Health insurance plans underwritten by Coventry Health and Life Insurance Company. H240B-ML-1 (8-13)

This space does the hard work for you!
Call your local newspaper today to find out how!

Goodland Home Health, LLC
Sue McCracken, RN
655-B E. 22nd, Goodland, KS
Office: (785) 890-7658 • Cell: (785) 821-0050
We provide the best care for those individuals due to illness who are unable to care for themselves or their loved ones.

The Decorating Co.
Interior Design Consultants
Irene Smith & Rochelle Kling
There's no limit to our imagination.
106 E. 11th, Goodland, KS 67735
(785) 890-5441
E-mail: decorco@st-tel.net

NOW available at Oasis Travel Center in COLBY...
Gunnysack Greeting Cards
"Cards that have the guts to tell it like it is"
Sarcastic & Silly
Very Blunt & Unusual
Not for the easily Offended
Created by Ellis, KS resident
Tracy Augustine
Stop by to check out the wonderful selection or go online at
www.gunnysackgreetings.com

HSI
HOXIE STATE INSURANCE, INC.
824 Main, PO Box 378
Hoxie, KS 67740
115 S. State St.
Winona, KS 67764
(785) 675.3263 - Fax (785) 675.3721

C.W. Beamgard Co. Inc.
SALES & SERVICES SINCE 1919
• New Vehicle Sales • Service
• Used Vehicle Sales • Windshield Pit Repair
• Parts • Tires
• Accessories • Towing Service
Monday - Friday 8-6, Saturday 8-Noon
785.626.3286
Fax 785.626.3717
210 State St. • Atwood, KS 67730

Sealy **MOHAWK** **ASHLEY FURNITURE** **MED-IFT**
Superior
Flooring and Furniture and Accessories
360 14th St., Burlington, CO ~ PHONE: (719) 346-7579
Dan and Myrna Troyer

ROOFMASTERS
Your Local Roofing Contractor
425 East Hill, Colby, KS
Licensed - Bonded - Insured
RESIDENTIAL 1-800-536-6642
Tamko Shingles 1-785-462-6642
GAF Shingles
Wood Shingles
Metal Roofs
FREE ESTIMATES
Elastomeric Rubber Coating For Metal Roofs
COMMERCIAL
Rubber Single Ply
White TPO Single Ply
Built Up Systems
Modified Systems

Meadow Lake Restaurant & Lounge
• Open to the Public •
Monday Nights \$1 Draws
Saturday Nights Prime Rib
MEADOW LAKE
GOLF COURSE & RESTAURANT
785-460-6443
1085 E Golf Club Rd. • Colby, KS

Disc Rolling—Rolling on the farm. Call Ron Lewis, Eustis, NE. 308-486-3501.
N tfn

PASTURE WANTED

GRASS PASTURE WANTED to rent, Adam Jones, 785-332-6206.
SFH tfn

GRAIN/FEED

151 Round Bales, 9% Protein, low nitrates, SE Thomas County. 303-202-1000.
C 1/8-1/29

1,000 Round Net wrapped cane bales low nitrates. 245 net wrapped straw bales all southwest of Colby 785-443-2571 or 785-462-2012.
C 1/1-1/22

FEED FOR SALE. Sorghum Sudan feed. Round bales, net wrapped. Nitrate 522, TDN 64.4%. Hauling available, \$120/ton. Call 785-734-7114. 01-02c.
SFH 1/2-1/9

FEED HIGH QUALITY 877F, very low nitrate - safe - \$120 @ ton. Price negotiable. Delivery available. St. Francis. 785-332-5600 or 785-332-3914. 47-2C.
SFH 11/21-1/9

FOR SALE

Steel Building Bargains, Allocated Discounts. We do deals 30x40, 50x60, 100x100 and more Total Construction and Blueprints Available www.gosteelbuildings.com. Source #18X - 620-577-4455.
C 1/8-1/15

6' Circular Hot Tub, great condition. Asking \$2,400 OBO 785-462-3308.
C 1/8-1/15

Suzuki Concert Master Personal Piano DP88 for sale \$750 - 785-462-2904 or cell

785-269-7012.
C 1/8-1/15

Abernathy solid walnut w/frosty plum finish, dining room table w/2 leaves, 5 chairs, 1 Captains chair & matching buffet \$800. 785-443-1414.
C 1/8

1948 Philco Radio/Phonograph cabinet, good condition. Both radio and phono work. \$100.00. Call (719) 350-0705.
G 1/1-tfn

Refrigerators, electric stoves, gas range, under counter dishwashers, window air conditioners. We do not buy appliances 785-694-8013.
C 12/25-1/15

Vap Construction, the strongest name in steel and post frame buildings. We will beat any Northwest Kansas competitor's price on a comparable project. Contact us for a quote today! (866) 492-1978.
C 12/18-1/8

Large leather recliner, mahogany, like new, \$250; kitchen aid mixer, older, works well, \$25. (785) 475-2521.
12/18

Antique curved glass china hutch, all original. Sable fur stole, no dealers. (308) 345-4024.
O 11/27-12/25

For Sale: A slightly used wood pellet fireplace insert and 20 bags of Pellets. This Timber Ridge Pellet Fireplace Insert is an efficient heating upgrade with a beautiful bay design and EPA certification. U.S.A. 45-lb. hopper provides up to 24 hours of warmth. User-friendly control panel with auto start, works with masonry or zero-clearance fireplaces. Minimum opening required: 36in.W x 16in.D x 21in.H. Asking \$2000.00 O.B.O. Please call for more

information at 785-475-3510.
O 11/6TF

For Sale: A 1950's Hutch and matching Buffet. In great shape and custom made. We do have the matching Table and Chairs but they have some issues but in good shape. Grandparents bought the table and chairs and had the Hutch and buffet handmade to match. Asking \$250 O.B.O. for whole set. Please call for more information at 785-475-3510.
O 11/6TF

Third row seats for GMC Yukon. Two pieces, gray leather, good condition. \$300 OBO. Call or text (785) 202-0607 or (785) 470-1188.
O 11/6TF

2 Harley Davidson die cast models. 1-1:10 scale Hot Wheels HD Softail. 1-1:10 scale Maisto FLSTS Heritage Springer. Still in original boxes! Call Gary at (719) 350-0705.
G 9/25-tfn

AWP toolbelt/pouches with kidney belt and suspenders. Paid \$100 plus, asking \$50. Call Gary at (719) 350-0705.
G 9/25-tfn

FIREWOOD FOR SALE in Goodland. Call (785) 890-7224 or (785) 821-2814.
G 12/12-tfn

Rubber stamps, custom made, The Country Advocate, 1205 Main. Goodland, Kansas. (785) 899-2338.
G tfn

MATTRESS SETS, most sizes in stock. Biers Hometown Store, St. Francis. 332 2119. 52c
SFH 12/26

HUMIDIFIERS, whole house humidifiers available at Biers Hometown Store, St. Francis. 785-332 2119. 01c.
SFH 1/2

LOG SPLITTER, 332-4939. 01c
SFH 1/2

For Sale: Pecans for sale by Coterie Club, Almena. Call Donelle, 785-874-8450 or Georgie at 785-877-2023.
N tfn

KANSAS CLASSIFIEDS

Help Wanted

Anthony, Kansas is seeking Electric Maintenance Worker I (Electric Department Lineman). Vocational degree in electricity is preferred. Applications and complete job description: www.anthonykansas.org. 620-842-5434. EOE.

Help Wanted

Heavy Equipment Operator Training! Bulldozers, Backhoes, Excavators. 3 Weeks Hands On Program. Local Job Placement Assistance. National Certifications. GI Bill Benefits Eligible. 1-866-362-6497

Help Wanted

Partners In Excellence OTR Drivers APU Equipped Pre-Pass EZ-pass passenger policy. 2012 & Newer equipment. 100% NO touch. Butler Transport 1-800-528-7825 www.butlertransport.com

TECHNICIANS: Competitive wages, Health/Dental Insurance, Year-end Bonus Program, 401K, sign-on bonus, relocation (NorthWest Kansas) assistance, excellent benefits. www.mitteninc.com or 785-672-2612

Help Wanted/Truck Driver Drivers - CDL-A. Train and work for us! Professional, focused CDL training available. Choose Company Driver, Owner Operator, Lease Operator or Lease Trainer. (877) 369-7885 www.CentralTruckDrivingJobs.com

Misc.

You can become an expert in HVAC installation and repair. Pinnacle Career Institute Online HVAC education in as little as 12 months. Call us today: 1-877-651-3961 or go online: www.HVAC-Online-Education.com

Sporting Goods

GUNSHOW JAN. 11-12 SAT. 9-5 & SUN. 9-3 WICHITA CESSNA ACTIVITY CENTER (2744 GEORGE WASHINGTON BLVD) BUY-SELL-TRADE INFO: (563) 927-8176

CARD OF THANKS

Help Wanted

WANTED SHOP I WISH TO THANK

Specials for the week January 3-9

Drinks included. Dine-in or carry out!

- Friday, Jan. 3: Taco Salad
- Saturday, Jan. 4: Sloppy Joes
- Sunday, Jan. 5: Pork
- Monday, Jan. 6: Soup and Salad
- Tuesday, Jan. 7: Stroganoff
- Wednesday, Jan. 8: Pizza Rolls with Side Salad
- Thursday, Jan. 9: Chicken Alfredo



Jct. of Hwys. 27 and 40, Sharon Springs, Kansas • Phone: 785-852-4664

ATTN: Area Farm Producers



Is having a complimentary lunch at El Dos De Oros restaurant on January 15 at 12 p.m.

Be our guest and learn about our 2014 Confection Sunflower Contract Offering:

- STABLE PRICING
- COMPETITIVE EARNING POTENTIAL COMPARED TO OTHER CROPS
- LOW WATER USAGE CROP/DROUGHT TOLERANT

Please RSVP To: 785-462-3911 by January 14th

AMERICAN IMPLEMENT

1104 W. Hwy. 24 • Goodland, KS 67735

(877) 320-4020 For after hours service call & select option.
americanimplement.com

2012 Polaris RZR 900



#53217: Solar Red, Roof, half windshield, front bumper, 96 mi., 16hrs. **\$13,900**

2013 Polaris RZR 900 XP



Orange Madness, windshield, roof, rear panel, 1,200 miles, 130 hrs., #51059 **\$14,900**

2013 Polaris RZR 900 4



doors cargo box roof rear panels 574 miles Indy Red, Pro Armor seats, 4-point harness in rear, 1/2 windshield. **\$19,900**

NEW 2014 POLARIS RANGER 900



Red, #49235 **\$14,199**

NEW 2014 POLARIS RANGER 900



Sage Green, #49882 **\$14,199**

NEW 2013 POLARIS RZR 900 XP EPS



Stealth Black, Roof, Front & Rear Bumpers, 1/2 Windshield, Rear Panel, Doors w/decals **#46514**

NEW 2014 POLARIS RANGER 900



White Lightning with EPS, #52117 **\$14,999**

2008 POLARIS SPORTSMAN 800



#42903 EFI Sage Green, Front & Rear Brush Guards, Front & Rear Rack Extensions, 98.2 hrs., 1,094 miles **\$6,300**

NEW 2014 Polaris RZR 800S



White and yellow with EPS, #49624 **\$14,999**

2013 Polaris Ranger 500



Crew Camo, 244 miles, 25 hrs., #52970 **\$10,000**

2011 John Deere 825i Gator



1,825 miles, 327 hours, #49718 **\$10,800**



WARNING! ATVs can be hazardous to operate. For your safety, always wear a helmet, eye protection and protective clothing and never carry passengers unless the adult ATV has been designed by the manufacturer specifically for that purpose. Polaris adult models are for riders age 16 or older. Polaris youth models of 90cc are for riders age 12 or older. Polaris youth models of 50cc are for riders age 8 or older. Be sure to take a safety training course. For safety and training information in the U.S., call the SWA at (800) 887-2887. You may also contact your Polaris dealer or call Polaris at (800) 324-3764.



As a new year begins make sure your family is protected. We all have goals for our children but what would happen if you weren't there to provide for them? Fredrickson Insurance Agency can assist you with all of your life insurance needs.



183 S. Penn Ave
Oberlin, Kan.
(785) 475-3883

"We sell insurance but specialize in service."

Company's Coming:
 Carpet Cleaning Special - Any 3 Rooms only \$174.95!
 Dry-Foam safe & Green Seal approved. Serving NWKS mileage free since 1987. Call today: A+ Cleaners (785) 538-2526 or (785) 443-5400, Johnene Cheney.
 N 1/8

information.
 C 1/8

We are looking for a full-time experienced electrician. Please send resume with references or pick up an application 785-462-6692.
 C 1/8-1/15

High Plains Mental Health Center currently has an opening for either a full time or part time Branch Office Support Staff at our Branch Office in Colby. Qualified candidate should have good secretarial and office skills, handle multi-line phone system, and data entry. Candidate must also successfully pass a KBI background check. Interested applicants - respond via mail to Maureen Mindrup, Human Resources Manager, High Plains Mental Health Center, 208 E. 7th St., Hays, KS. 67601, or by e-mail to Jean Montgomery at jean.montgomery@hpmhc.com. HPMHC is an Equal Opportunity Employer M/F/D/V.
 C 1/8-1/15

HELP WANTED

Direct Contact, Inc is currently seeking Field Technicians to assure that all planters are field ready. Calibrations of already installed units, conversions, adjustments, repairs, etc. Interested candidates contact Amy Theobald, 1-800-558-6803, ext. 105 or email amy_theobald@directcontact.com.
 C 1/8 - 1/15

Temporary, part-time, general chrome shop help wanted. Apply in person at Truck Town, 105 W. Horton Ave., Colby, KS. Please ask for Tori. 785-462-8785
 C 1/8 - 1/15

Homestead Nutrition Project is accepting applications for an assistant cook at the Colby Sr. Center Meal Site. M-F 7:30 a.m. - 1:00 p.m. No evenings, weekends or major holidays. Vac/Sick/Holiday pay and KPERs offered. Please call 1-800-432-7422.
 C 1/8

Part-time Help Wanted at home-based daycare. Call 785-460-8261 for more

You have a Pickup & Trailer? Want to work for yourself? We are looking for you!!! We are looking for self motivated & dependable individual looking to work as a wholesale food distributor in Western Kansas. If you are interested in being your own boss email contact info to: guy@just4userv.com.
 12/20-1/27-

Position Available: Looking

for an OTR driver, CDL required, clean MVR, have 2 years driving experience, will train the right person, drug testing required. 785-675-8581.
 C 12/25-1/15

Wagoner Repair & Performance, 1100 S. Country Club Dr., Colby, KS 785-460-1081. If you are a diesel mechanic or an auto mechanic and you are interested in working decent hours, with weekends by choice, please apply. Health insurance is optional.
 C 12/25-1/8

Dundy County Hospital has an opening for a full-time maintenance tech. Preferred applicants would

have general construction knowledge, lawn care experience, basic electrical knowledge, as well as mechanical boiler and piping experience. Position will require evening on-call time as well as every other weekend and alternating holidays. Must possess a valid driver's license with a clean driving record and have trailer towing experience. Basic computer skills are required. Employment offer will be contingent on passing pre-employment physical and drug/alcohol screen. Applicants must be able to lift 50lbs, bend, kneel, and work in a fast paced environment. If interested pick up an application at the reception desk at DCH or

call Vince Turpin @ 308-423-2204. DCH - EOE.
 G 12/25-1/8

Great Western Tire of Colby, Inc., 1170 S. Country Club Drive, is now accepting applications for all positions. Experience required, but will train the right person. Valid driver's license is a requirement. Full time position includes competitive salary and benefits. Apply in person, EOE. Questions please call 785-462-2100.
 C 12/11-TFN

Decatur County Road and Bridge is taking applications for full-time employment. Employee will be subject to random drug and alcohol testing and will be required to obtain a CDL. Applications available at Engineer's

Office. Call (785) 475-8111. Decatur County is an Equal Opportunity Employer.
 O 4/24tf

Help Wanted: correspondent for Rexford. Send news via e-mail once a week. Paid by inch and receive free subscription to The Oberlin Herald.
 O 1/30 tfn

PSI Transport is always looking for good company livestock and grain haulers as well as shop mechanics. Competitive pay, life/health/dental benefits and bonus program available. EOE. (785) 675-3477.
 G 6/15-TFN

WOOFER PUMP & WELL INC.
 1024 Oak Ave.
 Hoxie, KS 67740
 Office Phone 785/ 675-3991 Fax: 785/ 675-3990
 Shop Phone 785/ 675-3023 E-mail: woofpw@ruraltel.net

Irrigation, Domestic, Geothermal & Environmental Services

- Irrigation Pump Repair
- Irrigation Well Drilling
- Domestic Well Drilling & Repair
- Environmental Drilling
- Windmill Repair
- Solar Systems
- Geothermal Pump Systems

For all your irrigation needs call:
 Lance Shepard (785) 675-8376

See Our Selection at waltermotorco.com
Walter Motor Company
 2 Blocks West of State St. (U.S. 283) on Washington St., Norton, KS
1-800-479-3112 or 785-877-3112
 Home Phone: Norm Walter (785) 877-3159 or Curt Walter (785) 877-5679
We Can Fix You UP! Full Service Shop with 3 Technicians to Serve You!

2005 Pontiac G6 - A sporty 4 door, V-6, air conditioning, cruise, power windows and locks. 129,000 miles.
2003 Cadillac Sedan DeVille DHS - A very well cared for luxury sedan with 129,000 miles.
2002 Ford Taurus - V-6 front wheel drive.

1983 Lincoln Continental Mark VI - Only 32,400 miles on this gorgeous 4 door, wire wheels, custom roof and all the luxury extras! One of a kind!!

PICKUPS

2011 Ford F150 - 4 door crew cab, XLT, 5.0 V-8, 4x4, adjustable pedals, short bed, chrome package and more - Super Sharp! 20,000 miles.
2008 Chev. Silverado 1500 Series - 4 door, crew cab, 271 5.3 V8, 4x4, full power, alloy wheels, bed liner, Super Clean!, 59,000 miles.
2005 Ford F150 Super Cab - With Lariat trim, 5.4 V-8, 4x4, bedliner, leather. Nice! 115,000 miles

CROSSOVERS-SUVS

2011 Ford Escape XLT - Only 17,000 miles on this popular sized SUV, V-6, 4 wheel drive, moon roof, luggage rack.
2010 Ford Edge - A limited Series Crossover- all wheel drive, heated and cooled leather, power lift gate and more. Gorgeous in Red Candy metallic. 16,000 miles.
2010 Mercury Mariner - SUV, front wheel drive, leather seats, moon roof, satellite radio, traction control, extra sharp, 33,000 miles.
1999 Jeep Grand Cherokee Limited - 4 wheel drive, leather interior, 139,000 miles.

See our entire selection at www.waltermotorco.com

HomeLand REALTY AUCTION
 (785) 462-8255
 www.HomeLandRE.com

OAKLEY, KS
 419 Colby Ave.
 5 BR/2 Bath
 Call Toni today!

NICE NEIGHBORHOOD
 1130 Terrace
 2 BR/2 Bath
 Give Pat a call today!

COMMERCIAL LISTINGS
 Commercial building site 1-10 acres North of I-70 on Willow Avenue East of Whistle Stop. Give Tom a call today!
63 Acre parcel or 2-6 acre lots located along I-70 frontage, Colby, KS. \$17,000/acre Call Marilyn!
 Colonial Steak House Oakley, KS - CONTRACT Call Tom!

AG LAND LISTINGS
 160 Acres Thomas County Cropland w/several shop buildings, grain storage, and cattle facility - 3 West and 4 South of Colby, KS. \$848,000 (can be split) Call Rock for details!
 160 Acres Logan County CRP - 15 South of Monument, KS. - \$1,250/Acre Call Rock!
 80 Acres Logan County Dryland - \$160,000 Call Tom!
 960 Acre Wallace County Grass Ranch w/ Improvements - \$850/Acre Call Pat or Rock!
 160 Acres CRP (Contract thru 9-30-25)
 Sherman County Land - \$1,750/Acre Call Tom!
 160 Acres Sherman County Irrigated Cropland - \$3,600/Acre Call Tom!
Let Our Agents Work for You!

YOST 
 800-524-9678 785-332-2188 yostford.com
 Sales Manager - Brent Rueb

Use your Smart Phone to scan our Bar Code for complete inventory

Like us on Facebook Yost Ford

New for 2014 Ford F150 STX
Now offered in Super Crew.
Excellent Work Truck
5.0 L, 4X4, Cloth, Rubber Floor Mats
Priced Under \$40,000

The New yostford.com at the New Yost Ford

HometownFamilyRadio
 with **7102.1 PURE ROCK** and **105.3 COYOTE COUNTRY**
bring you
THE ZONE 93.9
McCook's HIT Music Station

MILL BAR ANGUS

Mill Bar Consensus 7744
 Sire: Connealy Consensus MGS: Sitz Upward
 EPD's BW +2.0 WW +65 YW +108 Milk +31
 \$B+104.75
 205 Day Wt. 727 WR 109

Mill Bar Pioneer 7799
 Sire: SAV Pioneer MGS: Connealy Freight Train
 EPD's BW +2.4 WW +57 YW +101 Milk +30 \$B+64.42
 205 Day Wt. 774 WR 116

Performance Tested Carcass-Evaluated PRODUCTION SALE
Friday, January 24, 2014 • 1:00 PM
Tri-State Livestock Auction, McCook, NE

400 Angus Sell!
110 Big, Stout, January & February Yearling Bulls

Featuring Sons of:

- Connealy Consensus - 35 sons sell!
- Mill Bar Went Stellar - 8 sons sell!
- SAV Pioneer - 19 sons sell!
- SAV Final Answer - 17 sons sell!
- Sitz Upward - 14 sons sell!
- SAV Angus Valley - 14 sons sell!

200 Fancy, One-Iron Angus Replacement Heifers
90 Purebred Commercial Angus Cows

99% of this offering is AI sired

- FREE Delivery
- FREE Feed Until April 1st
- First Breeding Season GUARANTEE
- 2013 Sale: 74% Repeat Buyers

Mick & Marlene Cox
 73786 Ave. 356
 Hayes Center, NE 69032
 (308) 286-3416

View our sale book online at: www.millbarangus.com
millbarangus@hotmail.com
Auctioneer: Joe Goggins

MILL BAR ANGUS

PSI TRANSPORT is looking for owner operator to pull livestock trailer. Good rates, weekly pay and consistent work. Have modern equipment. Run the midwest. Call (785) 675-3477 or (913) 533-2478. Call Monday-Friday, 8 a.m. to 5 p.m. PSI TRANSPORT is looking for professional drivers to haul cattle in the midwest. Industry leader in pay w/ health insurance, retirement plan, and other incentives upon hire. Excellent working environment with a competitive salary and benefits package available. Email resume to employment@valleyhope.org. EOE.

3361. N tfn
Valley Hope Association is seeking a Corporate Customer Service Specialist to work as a part of an office team to maintain several administrative duties. This position is located in Norton, KS. Successful candidates must have a valid driver's license. Excellent working environment with a competitive salary and benefits package available. Email resume to employment@valleyhope.org. EOE.

N 1/15
ATTENTION: Truck Drivers. Valley Feeds Trucking: Long Island KS. is looking for a dependable and self motivated person to join our team driving a company semi, hauling livestock, grain and feed commodities. Driver is home most evenings and weekends. A class A CDL and clean driving record is a must. Excellent Pay

N 1/8
Carriers Wanted: The Norton Telegram is looking for Carriers. For more information call Marcia or stop by the office at 215 South Kansas Avenue, Norton. Phone 785-877-

Package, BC/BS Insurance, Longevity and Safety bonus, 1 weeks paid personal leave and more. Please call Jeff or Paul for more information and or confidential interview, 785-854-7867, Ext3, or 785-202-1751 evenings. N 1/8

ARE YOU LOOKING for good, solid, employment with great benefits and also presents a challenge and is rewarding? Norton Correctional Facility is looking to hire Corrections Officers. Starting pay is \$13.61 plus shift differential pay. Benefits include health, dental and vision insurance, paid vacation, holidays, and sick leave, KPERS retirement, and much more. There are promotional opportunities which make it a great career choice. You may call the NCF Human Resource Office 785-877-6643 to obtain an application or apply online at www.jobs.ks.gov. The job flyers can also be viewed at this web site. On line applications can be emailed to ncfhr@doc.ks.gov.

PHILLIPS COUNTY RETIREMENT CENTER has openings for LPN's and RN's. Offering part-time or full-time employment, good wage and benefit package including paid single health and dental plan. Please call 785-543-2131 for more

information or stop by 1300 State Street to pick up an application. N 1/8

not. Call (785) 263-6275. G 12/4-2/4

Junk batteries, non-ferrous metals and iron. Darrel Bowen. Phone 785-899-2578.

G tfn

WANTED
Want to buy: John Deere diesel engines, running or



Become a Master Gardener!

Classes begin Feb. 4, 2014



Interested in becoming a K-State Research and Extension Master Gardener? Receive training and support in horticulture from K-State R&E. Volunteering in the local community. Help K-State R&E with its Educational Mission. Receive 40 hours of classroom and hands-on instruction in horticulture. Class topics in the training program include:

Basic Botany	Trees and Shrubs
Soil Science	Entomology
Fruits & Vegetables	Houseplants
Landscape Design	Landscape Maintenance
Lawn Care	Plant Pathology
Annuals and Perennials	

Northwest Kansas MG Training Every Tuesday February 4th - March 25, 2014. Logan County EMS Building 703 W. 3rd Oakley, KS 67748.

Applications at your local extension office or www.goldenprairie.ksu.edu

Golden Prairie Extension Office at 785-671-3245 for more information

Applications are due no later than **January 24, 2014**. A minimum of 10 people must be pre-registered to hold the program.

An enrollment fee of \$90.00 covers the cost of all educational materials.

Kansas State University Agricultural Experiment Station and Cooperative Extension Service. All educational programs and materials available without discrimination on the basis of race, color, religion, national origin, sex, age or disability



Silent Auction for Bison Harvest

When- Bidding will begin January 7th at Oakley vs Dighton basketball game and end on January 10th at the beginning of the third quarter of the Oakley vs Oberlin boy's varsity game when there are no bids placed for three (3) minutes.

Where- Oakley High School Lobby



Who- Participants must be legal to harvest the bison. They will need to be able to transport the bison from the Smoky Valley Ranch. Processing is not included.

The bison harvest is provided by the Nature Conservancy at Smoky Valley Ranch and will take place in late January or early February as arranged with Smoky Valley Ranch.



Contact Information 785-671-3241 or ggoodsoak@st-tel.net

THIS IS WHAT EVERYONE IS TALKING ABOUT!

Goodland Star-News
1205 Main Avenue, Goodland, KS 67735 • Phone (785) 899-2338
Goodland, Kansas 67735
10 Pages

Heavy rains cause minor flooding

By Kevin Bottrell
It's been a while since Sherman County saw this much rain at once. More than six inches fell in Goodland over a three-day period with more moisture following over the weekend. The National Weather Service reported record rainfall on Thursday: 4.11 inches, beating the record of .85 for Sept. 12, set in 2008. The rain began falling Wednesday afternoon. Rainfall that day was 1.23, not far off from the Sept. 11 record of 1.85 set in 1933. The rain let up Friday after dropping an additional .79 inches, beating the Sept. 13 record of .64 from 1982. The total rainfall in town was 6.13 for the three-day period. Higher rainfall - as much as 8.32 inches on Thursday - was reported in the southern part of Sherman County by the Community Collaborative Rain, Hail and Snow Network. On Thursday there were reports of minor flooding in Kit Carson County. About 16 miles south of Burlington, a semi-tractor rig got most lost control when it tried to go through six to eight inches of water on Highway 385. A flash flood warning was issued Thursday afternoon for Kit Carson and Sherman Counties as well as parts of Cheyenne and Wallace Counties. In Goodland large amounts of water collected in the retaining pools near Phillips and Pioneer Parks. As county road crews got out and about Friday, flooding or washed out areas were discovered over several county roads including County Road 68 between 17 and 18; Road 13 between 52 and 55; and Road 17 between 52 and 55. Water from the Smokey Hill River was flowing over a bridge on County Road 13. There was also flooding in the eastbound lanes of I-70 between exits 11 and 14 on Friday. Traffic was diverted onto U.S. 24 between those two exits for several hours before it was re-opened in the late afternoon. Areas to the south near the Wallace County border saw more rain Tuesday. Reports from the public indicated that between a half inch and an inch of rain fell. It rained again in Goodland Sunday and Monday mornings. The weather service predicted a chance of rain throughout Monday. An approaching warm front from the south was to keep the skies mostly cloudy. Clear skies and temperatures in the mid-80s are expected today. Before the multi-day rainstorm, Goodland was at a little over half its average rainfall for that point in the year.

NEW Dollar Menu & More!



<p>\$1</p> <ul style="list-style-type: none"> NEW! Buffalo Ranch Hot 'n Spicy McChicken NEW! BBQ Ranch Burger Grilled Onion Cheddar Burger Hot 'n Spicy McChicken Sweet Tea lg Fruit 'N Yogurt Parfait Side Salad Cone Cookies 	<p>\$2 & more</p> <ul style="list-style-type: none"> Bacon Cheddar Hot 'n Spicy McChicken® Bacon Buffalo Ranch Hot 'n Spicy McChicken® Bacon McDouble®
<p>\$1.69</p> <ul style="list-style-type: none"> Double Cheeseburger 	<p>\$1.39</p> <ul style="list-style-type: none"> McDouble® 20pc. Chicken McNuggets® (Serves 2)



GOODLAND LOCATION ONLY • OPEN DAILY 6 A.M. TO 11 P.M.

HUGE HOLIDAY SALE EVENT!

We have recently taken in several trades!

 <p>2006 Cadillac DTS Sedan Beige, Leather, 111,927 miles</p>	 <p>2008 GMC Acadia SLT-2 Silver, Leather, 82,026 miles</p>
 <p>2010 Chevrolet Silverado 1500 White, Cloth, 49,998 miles</p>	 <p>2012 Toyota Camry LE V6 Dark Gray, Cloth, 24,231 miles</p>
 <p>2008 Mercedes-Benz MClass Black, Leather, 55,558 miles</p>	 <p>2012 Honda CR-V EX-L Blue, Leather, 23,400 miles</p>

Subscribe to *The Goodland Star-News* today!

NAME: _____ SHERMAN COUNTY & ADJACENT COUNTIES:

ADDRESS: _____ 3 MONTHS: \$29.00

CITY: _____ ZIP: _____ 6 MONTHS: \$48.00

PHONE NUMBER: _____ 1 YEAR: \$81.00

PLEASE MAIL CHECK OR MONEY ORDER TO: _____

OUT OF AREA (WEEKLY MAILING):

The Goodland Star-News

1205 Main Ave., Goodland, KS 67735

FINLEY MOTORS, INC.

1520 Highway 27, Goodland, KS 67735 • Toll free: (800) 525-3701 • "Your volume & variety dealer!"

WWW.FINLEYMOTORSINC.COM



SELLER: A.C. BLICKENSTAFF HEIRS

880 +/- Acres Cropland, Grassland

NORTON COUNTY, KANSAS

Century Norton County Farm

Auction

Auction Location: St. Francis Parish Hall
NORTON, KANSAS

**AUCTION
TIME:
2:00 P.M.**

TUESDAY, JANUARY 21, 2014

LAND LOCATION: Northwest Norton County in Garfield and Rock Branch Township.
From Norton: 9 Miles West on Highway 36 to County Road W9, North 6 Miles, then East on Road G to the NW Corner of Section 5. Tract #2 Accessible from Road H.

TRACT #1: West Half of the Southeast Quarter (W 1/2 SE 1/4) and the Southeast Quarter of the Southeast Quarter (SE 1/4 SE 1/4) in Section 32, Township 1 South, Range 24, West of the 6th P.M. Norton County, KS, being 120 acres more or less.

TRACT #2: West Half (W 1/2) of Section 4, Township 2 South, Range 24, West of the 6th P.M., Norton County, Kansas, being 320 acres more or less.

TRACT #3: Northeast Quarter (NE 1/4) the East Half of the Northwest Quarter (E 1/2 NW 1/4) and the Northwest Quarter of the Southeast Quarter (NW 1/4 SE 1/4) in Section 5, Township 2 South, Range 24, West of the 6th P.M., Norton County, Kansas, being 280 acres more or less.

TRACT #4: The Southwest Quarter (SW 1/4) of Section 33, Township 1 South, Range 24, West of the 6th P.M., Norton County, Kansas, being 160 acres more or less.

MINERAL RIGHTS: All of the Seller's interest will transfer to the Buyer(s) at closing. Mineral Rights are believed to be 100% intact.

MANNER OF AUCTION: This real estate will be offered in "multi-parcel" auction in four tracts and will not be offered in combination tracts. Bids will be on individual tracts only. Auction procedure and increments of bidding are at the discretion of the auction company.

TERMS: Buyer(s) will pay 10% down day of sale, with the balance to be paid on or before February 28th, 2014. Personal and corporate checks are acceptable for the down payment with the final payment to be made in certified funds. All funds will be held by Security Abstract Trust Account, Title/Escrow Company. Financing, if any necessary will need to be arranged and approved prior to the auction.

CLOSING: Closing on all tracts will be on or before February 28, 2014.

POSSESSION: *Date of Closing on all open cropland and grassland acres. (Tract 2, 3, 4)

*After the 2014 wheat harvest on the planted wheat acres (Tract #1)

CROPS: Tract #1 is planted to winter wheat. Buyer will receive the landlord's 30% share. Tract #2 cropland is currently in wheat stubble. Tract #3 cropland is currently corn stalks. Tract #4 cropland is currently feed stubble.

F.S.A. INFORMATION: Buyer(s) will receive the landlord's 30% share of all FSA wheat payments and 100% of all FSA feed grain payments. If any, associated with the 2014 crop year.

TAXES: Seller will pay all of the 2013 and prior year taxes. Taxes for 2014 will be the responsibility of the Buyer(s).

TITLE INSURANCE: Title Insurance will be provided to the Buyer(s) in the amount of the purchase price with the premium to be paid 50% by the Seller and 50% by the Buyer(s).

INSPECTIONS: Each potential bidder is responsible for conducting their own independent inspection and due diligence concerning pertinent facts about the property. Acreage figures are considered to be approximate and are from reliable sources based on FSA figures. Sale is subject to all right-of-way and easements, whether recorded or not, and to oil and gas lease of record, if any.

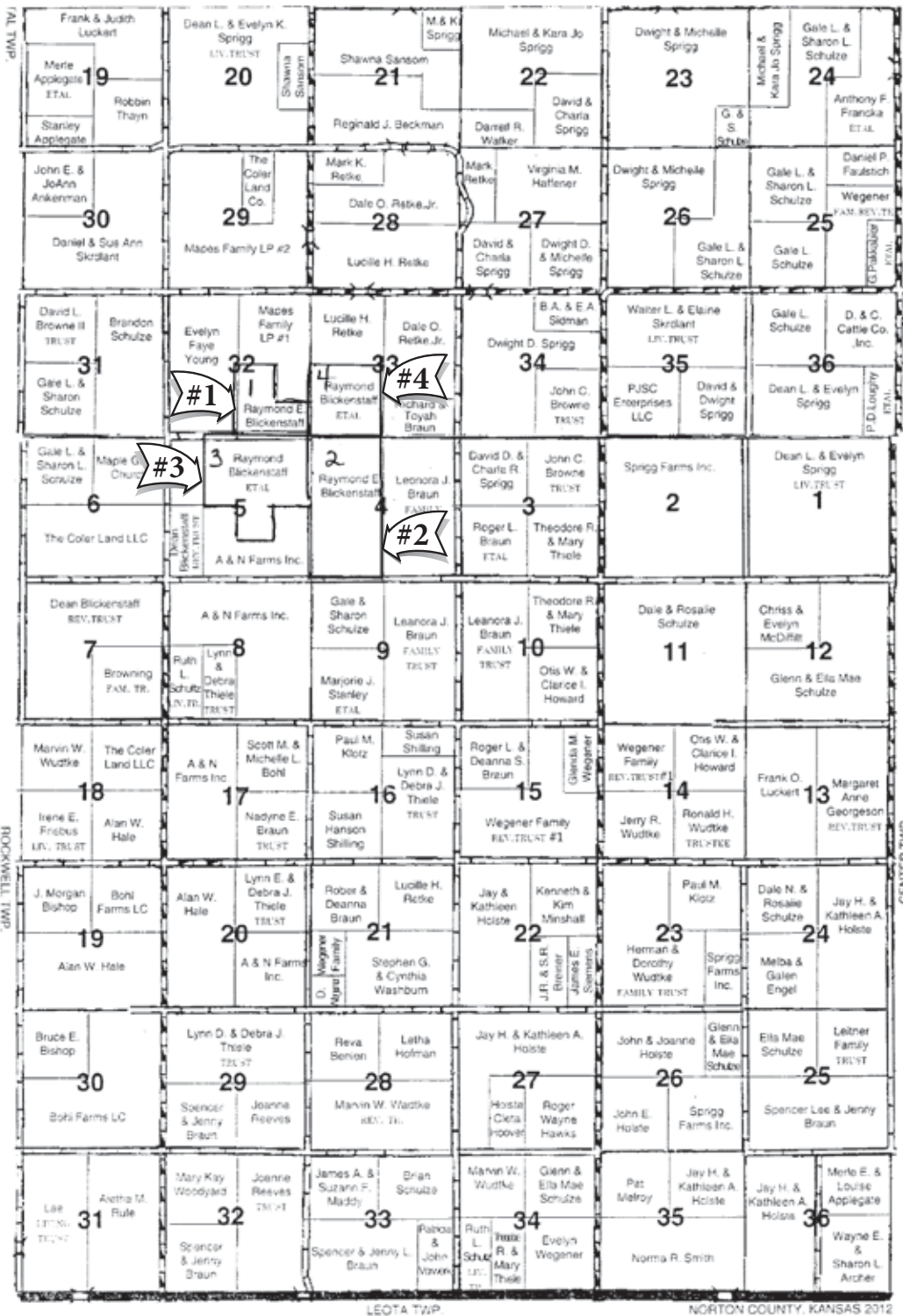

Tract	Auction Acres	Cropland	Grassland	Wheat Base/Yd	Sorghum Base/Yd	Oat/Barley Base/Yd	Well	Taxes
#1	120.0	103.24		46.99/42	13.96/46	3.53/40		600.20
#2	320	97.66	219.78	44.44/42	13.21/46	3.34/40	Windmill	601.50
#3	280	135.96	180.12	61.88/42	18.39/46	4.65/40	Sub	698.56
#4	160	15.78	143.0	7.17/42	2.13/46	.53/40	Well	164.72

AUCTIONEER'S NOTE: Mr. A.C. Blickenstaff purchased the farm in 1904 and it has been in their family since. Offered at auction for the first time in 110 years. Tract #1 is all terraced cropland with excellent soils. Tract #2, #3 are diversified tracts with excellent cropland and grassland. Tract #4 is primarily grassland with a small amount of cropland. A fencing allotment (credit) will be offered on Tract 2, Tract 3 and Tract 4. Contact Weiser Realty for more information. Plan to attend the Blickenstaff Heirs Land Auction on January 21st. We look forward to seeing you.

SELLER: A.C. BLICKENSTAFF HEIRS

Auction Conducted by:
Weiser Realty, Jolene Weiser Broker
Robert D. Wyatt, Auctioneer



Jolene L. Weiser, Broker/Owner: 871-7278 • Robert D. Wyatt, Auctioneer/Salesperson: 877-7263 • Samantha M. Hager, Salesperson: 871-7279
214 E. Washington, Norton, Kansas 67654 - Phone (785) 877-2185