

# Classifieds

## Services

**Gun cleaning, scope mounting and sighting, recoil pad installation, glass bedding and tuning stocks.** C-M Gun, Colby, KS. ---7/27---8/10---

**Tree Trimming & Removals.** Call Don Whaley at 785-608-6184. Insurance Certified with International Society of Arboriculture and 20+ years experience. Free estimates. Colby, Kansas. "You get what you pay for!" ---7/22---8/17---

**Need your house roofed?** Free estimates for asphalt or metal. Also do odd jobs. Kennan Racette 785-671-8859 or 785-953-7065. ---7/22---8/3---

**Tired of fishing from the bank?** We will rent you by the day a very nice small aluminum fishing boat. Boat is fully equipped and ready to go. Call 785-443-1177 for details. ---7/1---TFN---

**Home remodeling repairs, stucco, painting, shingle blow off, yard fence.** No job to small. JB Construction. 785-462-8674. ---6/29---8/1---

**Free estimates on our Lawn Power Rake, aerate, & edge program.** JM Tree & Lawn Service. 780 E. 4th, Colby. 1-800-794-3204 or 785-462-6908. ---3/18---TFN---

**Free estimates on our Lawn Fertilizer & Herbicide program.** JM Tree & Lawn Service. 780 E. 4th, Colby. 1-800-794-3204 or 785-462-6908. ---3/18---TFN---

**Free estimates on underground sprinkler systems.** JM Tree & Lawn Service. 780 E. 4th, Colby. 1-800-794-3204 or 785-462-6908. ---3/18---TFN---

**Free estimates on landscaping.** All types of fencing, tree trimming, and removal. JM Tree & Lawn Service. 780 E. 4th, Colby. 1-800-794-3204 or 785-462-6908. ---3/18---TFN---

**Tired of leaks every time it rains?** Frustrated with the bucket brigade? Murray Roofing. 780 E. 4th, Colby. 1-800-794-3204 or 785-462-6908. ---3/18---TFN---

**Free Estimates on all kinds of roofs.** Murray Roofing. 780 E. 4th, Colby. 1-800-794-3204 or 785-462-6908. ---3/18---TFN---

**Free Estimates on vinyl siding, windows, doors, and insulation.** Murray Construction. 780 E. 4th, Colby. 1-800-794-3204 or 785-462-6908. ---3/18---TFN---

**Services online at [www.NW-KansasOnline.com](http://www.NW-KansasOnline.com).** ---3/11---TFN---

## Public Notice

### NOTICE OF PUBLIC HEARING

You are hereby notified that a variance request will be heard at 9:30 A.M. on Tuesday, August 25, 2009, in the Council Chambers of City Hall for the Leopold Family Trust, 175 Thompson Avenue, Colby, Kansas, (The West 112 1/2 feet of Lots 1 and 2, Block 2, Eastview Tract).

Owners are requesting a variance to permit constructing a carport in the side yard at their residence which will not meet the requirement of Zoning Ordinance No. 1257 that accessory buildings be located in the rear yard in an R-1 - Single Family Dwelling District.

This public hearing will be held for the Board of Zoning Appeals. The public is invited to attend.

(S) Joni L. Ketchum, City Clerk

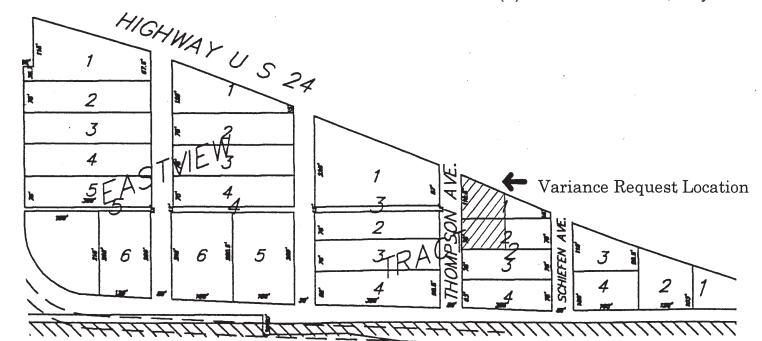

(Published in the Colby Free Press on Friday, July 31, 2009)

## Services

**"ASSIST-UR-SALE."** Have items in storage or a vehicle you want to sell? We have a 90% sell rate and we can sell your items for a minimal 10% commission. References available. No charge to you unless your item sells. Call Duane at 785-443-1177. ---12/11---TFN---

## Pets/Supplies

**Yorkshire Terrier Puppies** - AKC farm/family raised. Vet checked. All shots! sappaviewyorkshireterriers.weebly.com. Call for more info. 785-626-0352. ---7/17---7/31---

## Garage Sales

**675 W. Plum, Colby.** Friday 8/7/09 6 am - 2. Clothing: Baby to Adult. Home décor, kitchen ware, X-Box 360/games. Lots of misc. ---7/31---8/6---

**Huge Moving Sale.** Farm Supplies, Guns, Household. 1 Day Only, Saturday August 1st, 8 am - 2 pm. 509 N. 5th, Atwood. ---7/29---7/31---

**Saturday August 1st**, 7:30 am - Noon. 1649 U.S. Hwy. 24, 2 1/2 miles west of Colby on Hwy 24. TV, household items, girls toddler through size 5 clothes, mens and women's clothes, lots of misc. ---7/29---7/31---

**Moving Sale Friday** July 31st and Saturday August 1st, 8 am - 8 pm. Max George. 710 S. Grant, Colby. ---7/29---7/31---

**Yard Sale Friday July 31st**. 1195 Summer Sun, corner of College Drive and Summer Sun. 8-6. ---7/29---7/31---



## Public Notice

### NOTICE OF AVAILABILITY

FEDERAL FINDING OF NO SIGNIFICANT IMPACT/RECORD OF DECISION

For Proposed Development  
Shalz Field  
Colby, Kansas

The Federal Aviation Administration has approved a Finding of No Significant Impact/Record of Decision (FONSI/ROD) for the improvements identified at Shalz Field, Colby, Kansas. The FONSI/ROD is being made available to the public pursuant to Part 1506 of the Council on Environmental Quality Regulations concerning implementation of the National Environmental Policy Act. Copies of the FONSI/ROD are located at: City Hall, 585 N. Franklin Avenue; Pioneer Memorial Library, 375 West 4th Street; Colby Municipal Airport, 5 Airport Plaza; Thomas County Clerk's Office, 300 N. Court Avenue; and Federal Aviation Administration, Airports Division, 901 Locust, Kansas City, Missouri 64106.

(Published in the Colby Free Press on Friday, July 31, 2009)

## Garage Sales

**995 E 6th, Colby.** Dropleaf table, waterbed, 3.5cu freezer, 2 microwaves, pole tree trimmer, electric saw, tree trimmer pole, craftsman riding mower, FWD mower, mechanics creeper, odds and ends. Friday 7-31-09, 8-7. ---7/29---7/31---



## Notice

**RECOVERY....**  
The Bright Side of Addiction  
**Narcotics Anonymous**  
is there for you and your family!  
Meetings are Open to the Public  
City Hall Basement  
Tues., Fri. & Sun. - 8:00 p.m.

## Real Estate

## Homeland Realty & Auction

**NEW 320 ACRES LOGAN CO.** CRP & grass S of Monument, KS (Under Contract)  
**NEW 43.4 acres** grass located East edge of Colby, KS. (Under Contract)  
**NEW Excellent building lot** located on Cottonwood Drive in Colby, KS. Beautiful mature pine trees with asphalt street. \$39,000.  
**320 ACRES THOMAS CO.** grassland 4 miles West 1/2 N of Oakley, KS \$700/acre.  
**160 ACRES THOMAS CO.** irrigated cropland 4 miles West of Oakley, KS. \$1,600/acre.  
**35 ACRES** Close to I-70, Range Ave., Colby, Kansas. \$15,000/acre.  
**RESIDENTIAL LOTS** Located South of Dillons, Colby, KS. \$6,500 per lot.  
**148 ACRES RAWLINS COUNTY** Cropland and grass 4 1/2 miles North of Ludell, Ks. Cash rents going to Buyer. \$757/acre. Call Pat 785-443-3261.  
**640 ACRES GRAHAM COUNTY** CRP with irrigation wells and water rights Northwest of Hill City, Kansas. (Immediate Possession). \$850/acre.  
**400 ACRES LOGAN COUNTY** grass & cropland w/improvements located at Page City, KS. Beautiful 2 story home, barn, cattle working facility, Quonset, grain storage and cattle feeding pens. **PRICE REDUCED !!!**  
**480 ACRES LOGAN COUNTY** sprinkler irrigated land located 1 mile North of Page City, KS. Excellent farmland with 3 wells & 3 sprinklers. \$2,150/ac.  
**615 ACRES LOGAN CO.** Crop & grassland N of Winona, KS. (SOLD)  
Call Rock L. Bedore 785-443-1653

**1675 W 4th Colby**  
6,000 sq. ft office/retail building plus 4,500 sq. ft. warehouse with dock. High traffic area. Excellent for investor.

**206-208 Plum St. Oakley**  
Duplex. Great rental history, 2 bdrms 1 bath, 1 car garage each unit. Give Marilyn a call for all the details. Great Buy!

**COMMERCIAL DEVELOPMENT** 6.7 acres adjacent to Wal-Mart with I-70 frontage. Located in Colby, Kansas. **Call Rock.**  
**INDUSTRIAL LOT** in Colby's Industrial Area just off of I-70 Exit 53. Great building location. \$47,000. **Call Rock.**  
**LOCATE** to Colby's fastest growing area. I-70 frontage, 2-6 acre lots. Join Colby Petro, Colby Implement and others. **Call Marilyn.**  
**9 UNIT MOBILE HOME PARK** on West edge of Colby. Good rental history and management available. **Call Pat.**  
**310-316 W 7th Oakley** Well maintained brick 4-plex. Maintenance & updates have been done. Good rental history. **Call Marilyn.**

**HomeLand REALTY AUCTION**  
"Western Hospitality"  
410 N. Franklin  
785-462-8255  
[www.colbyhomeland.com](http://www.colbyhomeland.com)

**Agents**  
Rock L. Bedore 785-443-1653  
Jerry Wycoff 785-672-0429  
Marilyn Meyer 785-462-2703  
Pat Sloan 785-460-7495

## LAND & COMMERCIAL Opportunities

*the Promise of Land.....*

**Atwood**  
119 S. 4th - Beautiful Main Street building with well established home decorating business.  
\*\*\*\*\*  
509 N. 5th - Storage or light manufacturing facility. 8,600 sq. ft. \$800/month rental income. \$85,000

**Brewster**  
226 & 228 Kansas Avenue - "Old Theater" - great storage. Lot size 100 x 140. Building 36 x 105. \$12,500

**Colby**  
430 N. Franklin - "WOW" Fitness Center. 3,125 sq. ft. \$189,000. 6 rental apartments upstairs.  
\*\*\*\*\*

420 N. Franklin - Prime Downtown Colby Location. 2 bedroom apartment upstairs. \$49,900.  
\*\*\*\*\*

455 Austin - TriPlex Apartments. Good Cash Flow. Always rented. \$165,900.  
\*\*\*\*\*

900 E. 4th - Convenience Store. 2,583 sq. ft. \$185,500. Great Corner Location.  
**Oberlin**  
Blue Sky Auto Car Wash. Good Location. \$200,000.

**WE WANT TO SELL YOUR LAND!**  
If you are seriously considering selling your land, but have questions or concerns, contact Terry or Molly for a *no obligation market analyses*.

Stock's Full Team of "YELLOW SHIRTS" & Experience want to handle your next Auction...  
Call the "WE SELL" TEAM.

**Check Our Website**  
[www.stockrealtyandauction.com](http://www.stockrealtyandauction.com)

Terry Stover: 785-626-2082 Molly Oliver: 785-462-5203  
Ron Stock: 402-649-3705 Mark Stock: 402-276-2077

**STOCK REALTY & AUCTION CO.**  
390 N. Franklin, Ste. 100, Colby, KS 67701  
[www.stockrealtyandauction.com](http://www.stockrealtyandauction.com)  
785-460-SOLD (7653)  
QUALITY LAND BROKERS & AUCTIONEERS

## Real Estate

## MULTI-PARCEL REAL ESTATE & FARM MACHINERY AUCTION ABSOLUTE

SELLERS: ELVIN FISCHER ESTATE, ET AL.

**TUES., AUG. 18, 2009 @10:30 AM, MDT**  
**Auction Location:** From Wallace, KS go 11 mi S, 5 mi E, 1 mi S, 1 mi E & 1/2 mi S to the farmsite on Tract 3. **SIGNS WILL BE POSTED!**

**320 ACRES CROPLAND W/IMPROVEMENTS WALLACE CO, KS**  
Selling in 3 tracts & combinations of tracts

**TRACT 1:** NE/4 of Section 24-15-38  
**TRACT 2:** SE/4 of Section 25-15-38  
**TRACT 3:** 10 ac w/improvements on E/2 of Section 24-15-38

Great opportunity to purchase two quarters of cropland ready to plant Fall wheat, and/or to buy a home in a secluded "Country Setting" on 10 acres.

## FARM MACHINERY & EQUIPMENT SELLING IMMEDIATELY FOLLOWING THE LAND



**TRACTORS:**  
•82 IHC 5288, 180HP, 3 pt, 3 remotes, PTO, 8,946 hrs  
•75 IHC 966, 100HP, 3pt, 2 remotes, PTO, w/GB 660 front end loader w/grapple fork  
**COMBINE & HEADERS:**  
•83 JD Turbo 8820, 2,308 eng hrs, w/JD 230 platform, 30'  
•76 JD 6600 w/JD 24' platform for parts  
•JD 6-row crop head  
**GRAIN CART:**  
•Caldwell GC700, 750 bu  
**HORSE TRAILER:**•16' stock trl  
**PICKUPS:**•94 Chevy Silverado 1500, 4x4, ext cab, V8 auto•72 Chevy Custom 20, V8, 350, 4spd  
**TRUCKS:**•76 Chevy C65,5x2, tag axle, V8 460, 22' Tradewind B&H, RO tarp•69 Chevy C50, 4x2, V8, 15' B&H w/RO tarp  
**FARM MACHINERY & EQUIP:**  
•IHC 9' swather, model 990MC  
•NH 276 baler•NH 102 bale wagon•HM round bale hauler•3pt bale fork•Landleveler 10' box scraper•8' back blade•FMC 3 pt Side-Winder 6' PTO rotary mower  
•Rhino 3pt post hole digger w/2 augers•6"x35' auger  
**FARM MACHINERY & EQUIP:**  
•2) FK 5x6 blade plows w/pickers  
•FK 3x6 blade plow w/pickers  
•Miller 16' offset disc•IHC 24' crustbuster•Fuel tri - 100 gallon diesel & 100 gal gas tanks w/12V elec pumps•2 sets IHC 16x10 hoe drills•Several old toolbars & oneways•JD 6-row planter on toolbar•Wire roller w/B&S motor on small tri•Misc steel & wire panels•110V fence chargers  
**SHOP EQUIPMENT:**•5HP air compressor•Craftsman 7HP, 17" rototiller•Lincoln 225 arc welder  
•HD shop press •Craftsman 2 1/2 HP 10" radial saw •Craft drill press•B&D Workmate work bench•Bur Mill 110V grinder  
**MISCELLANEOUS:** •Electric drill fill auger•500 gal diesel & propane tanks•Fishing rods & tackle•Old "Vickers" gasoline sign•Old steel "Phillips" sign•"Russell Standard" horse-drawn grader on steel•Several old wagon wheels & parts •Cement mixer•Misc push mowers •Lots of iron, tools, AND MANY MORE  
**MISC ITEMS TOO NUMEROUS TO LIST!**

CALL FOR A BROCHURE OR VISIT [www.farmandranchrealty.com](http://www.farmandranchrealty.com)

## FARM & RANCH REALTY, INC.

**MIKE BAILEY, Listing Agent**  
1420 W. 4th • Colby, KS 67701  
Telephone 1-800-247-7863  
**DONALD L. HAZLETT, BROKER**  
"When you list with Farm & Ranch, it's as good as SOLD!"

## Auction

**Auction Location:** Grainfield 4-H Building, West 3rd Street, Grainfield, KS  
**Saturday, August 8, 2009 10:00am**  
SELLING FOR: Cox Heirs of Isella & Verle (Corky) Dorothy Cox

Selling will be coins, collectibles, primitive and novelty items as well as nice glassware, household, furniture, appliances, lots of tools, lawn & garden, many misc items of interest too numerous to mention here. A little something for everyone. For a complete listing, visit our website at [www.pfeiferbrothersauction.com](http://www.pfeiferbrothersauction.com)  
Pfeifer Brothers, auctioneers is not responsible for accidents or theft the day of sale. All items must be removed the date of sale. Terms of sale are cash or good check. Come and enjoy the day with us.

Jason Pfeifer Russell, KS 67665 785-483-2578 785-483-1805  
pb Pfeifer Brothers Auctioneers  
Kansas Auctioneers Association  
Brandon Pfeifer Ellis, KS 67637 785-726-3310 785-650-7588

**For the Best TV Experience, Upgrade from Cable to DIRECTV!**

PACKAGES START AT **\$29.99** mo. Everyday Low Price

**For a limited time get: FREE PRO INSTALL** IN UP TO 4 ROOMS. Complex/Custom installation extra. Handling and delivery fee \$19.95.

**FREE DIRECTV® HD DVR UPGRADE**  
Set your home DVR with any cell phone or computer.\*  
With activation of CHOICE XTRA™ package or above.\*

**FREE NASCAR HotPass** NEW FOR '09  
ONLY ON DIRECTV.  
Offers ends 9/30/09 and are based on approved credit. Credit card required. New customers only. Lease required, must maintain programming, DVR and/or HD Access. Lease fee of \$3/mo. for second and each additional receiver.

**No Equipment to Buy! No Start-up Costs!**  
**Switch today! 1-888-327-9062**

**DOLBY DIGITAL**

**Wanted on Cinemax®**

• Worry-free 99.9% signal reliability  
• Local channels included in every package†  
• 100% digital picture and sound on every channel  
• #1 in Customer Satisfaction

Among the largest national cable and satellite providers. 2009 American Customer Satisfaction Index. University of Michigan Business School.

Credit card not required in MA & PA. \*\*HD channels include 5.1 surround sound when available from programmer. Additional equipment required and sold separately. "Dolby" and the double-D symbol are trademarks of Dolby Laboratories. "DVR Scheduler requires Internet access via computer or mobile phone and directv.com login. Remote connections may vary. In rare instances, scheduled recordings may not be recognized. Only available on certain receivers. Visit [directv.com/dvrscheduler](http://directv.com/dvrscheduler) for details. "HD DVR INSTANT REBATE": Advanced equipment instant rebate requires activation of CHOICE XTRA (\$60.99/mo.) package or above. FAMILIAR ULTRA or above. Jadeworld or any qualifying international service bundle, which shall include PREFERRED CHOICE programming package. DVR service (\$6/mo.) required for DVR and HD DVR lease; HD Access fee (\$10/mo.) required for HD and HD DVR lease. LIMIT ONE ADVANCED EQUIPMENT REBATE PER DIRECTV ACCOUNT. SYSTEM LEASE: Purchase of 24 consecutive months of any DIRECTV base programming package (\$29.99/mo. or above) or qualifying international services bundle required. FAILURE TO ACTIVATE ALL OF THE DIRECTV SYSTEM EQUIPMENT IN ACCORDANCE WITH THE EQUIPMENT LEASE ADDENDUM MAY RESULT IN A CHARGE OF \$150 PER RECEIVER NOT ACTIVATED. IF YOU FAIL TO MAINTAIN YOUR PROGRAMMING, DIRECTV MAY CHARGE A PRORATED FEE OF \$40. RECEIVERS ARE AT ALL TIMES PROPERTY OF DIRECTV AND MUST BE RETURNED UPON CANCELLATION OF SERVICE, OR ADDITIONAL FEES APPLY. VISIT [directv.com](http://directv.com) OR CALL 1-800-DIRECTV FOR DETAILS. Programming, pricing, terms and conditions subject to change at any time. Pricing residential. Taxes not included. Receipt of DIRECTV programming is subject to the DIRECTV Customer Agreement; copy provided at [directv.com/legal](http://directv.com/legal) and in your first bill. PHOTO CREDITS: HBO and Cinemax are registered service marks of Home Box Office, Inc. ©2009 DIRECTV, Inc. DIRECTV and the Cyclone Design logo, FAMILY and CHOICE XTRA are trademarks of DIRECTV, Inc. All other trademarks and service marks are the property of their respective owners.