

# Classifieds

## Real Estate

### Homeland Realty & Auction

**NEW 12 ACRES RAWLINS CO** w/house, detached 2 car garage, Quonset, & several out buildings. 6 mile E & 6 mile S Atwood, KS \$65,000  
**NEW 140 ACRES THOMAS CO** cropland with improvements & remodeled house located at Rexford, KS. Immediate Possession. \$288,000.  
**RESIDENTIAL LOTS** in El Chaparral, Colby, KS. **(SOLD)**.  
**EXCELLENT BUILDING LOT** located on Cottonwood Drive in Colby, KS. Beautiful mature pine trees with a prime location. \$39,000.  
**320 ACRES THOMAS CO.** grassland 4 miles West 1/2 N. of Oakley, KS \$700/acre.  
**160 ACRES THOMAS CO.** irrigated cropland 4 miles West of Oakley, KS. \$1,600/acre.  
**35 ACRES** Close to I-70, Range Ave., Colby, Kansas. \$15,000/acre.  
**RESIDENTIAL LOTS** Located S of Dillons, Colby, KS. **(Under Contract)**.  
**148 ACRES RAWLINS COUNTY** Cropland and grass 4 1/2 miles North of Ludell, KS. Cash rents going to Buyer. \$757/acre. Call Pat 785-443-3261.  
**400 ACRES LOGAN COUNTY** grass & cropland w/improvements located at Page City, KS. Beautiful 2 story home, barn, cattle working facility, Quonset, grain storage and cattle feeding pens. **PRICE REDUCED !!!**  
**480 ACRES LOGAN COUNTY** sprinkler irrigated land located 1 mile North of Page City, KS. 3 wells & 3 sprinklers. **(For sale or lease)** \$2,150/acre.  
**Call Rock L. Bedore 785-443-1653**



**1675 W 4th Colby**  
6,000 sq. ft office/retail building plus  
4,500 sq. ft. warehouse with dock. High  
traffic area. Excellent for investor.



**310-316 W. 7th Oakley**  
Well maintained brick 4-plex. Updates &  
maintenance have been done. Good  
rental history.

**COMMERCIAL DEVELOPMENT** 6.7 acres adjacent to Wal-Mart with  
I-70 frontage. Located in Colby, Kansas. **Call Rock.**  
**INDUSTRIAL LOT** in Colby's Industrial Area just off of I-70 Exit 53.  
Great building location. \$47,000. **Call Rock.**  
**LOCATE** to Colby's fastest growing area. I-70 frontage, 2-6 acre lots.  
Join Colby Petro, Colby Implement and others. **Call Marilyn.**  
**9 UNIT MOBILE HOME PARK** on West edge of Colby. Good rental  
history and management available. **Call Pat.**

**HomeLand**  
REALTY AUCTION  
"Western Hospitality"  
410 N. Franklin  
785-462-8255

**Agents**  
Rock L. Bedore 785-443-1653  
Jerry Wycoff 785-672-0429  
Marilyn Meyer 785-462-2703  
Pat Sloan 785-460-7495

[www.colbyhomeland.com](http://www.colbyhomeland.com)

## A Delightful House



**1825 W. 5th  
Colby, KS**

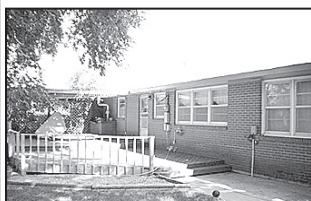

**Come check out the  
hardwood floors,  
spacious rooms,  
upgrades and a deck  
with plenty of shade!**



1085 Taylor Ave., Colby, KS  
Linda Taylor - Broker  
**785-460-3721**  
Broker Owned



[www.colbysouthwindrealty.com](http://www.colbysouthwindrealty.com)

**HomeLand**  
REALTY AUCTION  
"Western Hospitality"  
[www.colbyhomeland.com](http://www.colbyhomeland.com)  
410 N. Franklin  
785-462-8255



**310 S. Garfield \$135,000**  
New master bdrm & new bath on the  
main floor. Formal dn rm, parlor & family  
room. 4 bdrms & full bath upstairs. Deck  
off kitchen. Kids can walk to school.



**255 N. Garfield \$98,500**  
Original woodwork, gorgeous staircase &  
great built-ins in this Early American  
home. 3 bdrms, 2 baths & a den. Nice  
front porch, & upper balcony & mature  
landscaping w/sprinklers. Walk to school.

**Inventory is low – WE WANT YOUR HOME.** Give us a call and let our team of experienced realtors provide you  
with a free market analysis as well as a personal marketing plan. **HomeLand – A TEAM WORKING FOR YOU!**

201 Penn Jennings	\$10,000	855 S. Grant	REDUCED	\$70,000
615 Longview-Oakley	\$39,900	995 S. Range	REDUCED	\$79,500
721 Smokyhill-Oakley	\$59,500	1105 Flint	SOLD	
760 S. Mission	CONTRACT	955 E 5th	CONTRACT	
555 N Grant	CONTRACT	255 N. Garfield	\$98,500	
560 W 6th	CONTRACT	460 W 4th	CONTRACT	
1213 Ct. Place	NEW	860 S. Court	CONTRACT	
12 acres w/improvements	\$63,500	905 S. Range	NEW	\$107,500
445 W. Walnut	Reduced	880 Thompson	CONTRACT	
	\$65,000			
	\$68,000			



**905 S. Range \$107,500**  
4 bdrm brick ranch on corner with full  
finished bsmt, 3 car detached garage,  
fence, covered patio & lush back yard  
with sprinklers. Who needs any more?



**1473 Pioneer Dr. \$117,500**  
"Country Living" 2.7 acres. Lots of  
trees, room & privacy. 4 bdrm, 3  
bath ranch just a few minutes from  
town. Oversized heated garage/shop.



**\$9,500 Allowance!!!**  
**575 La Hacienda \$219,000**  
Location & quality here. 5 bdrm, 3.5  
bath brick ranch, den & family room,  
oak woodwork and so much more. 2  
acres mature landscaping. Great Buy!



**1213 Court Place \$63,500**  
BEGIN HERE: One level home features  
a spacious master bedroom w/sitting  
area, large eat-in kitchen, 1 car attach  
garage. Low maintenance exterior.



**995 S. Range \$79,500**  
One level brick home with 2 bdrms & 2  
full baths plus a large 2 car garage  
Located on a corner lot. The new price  
makes this a "steal."



**855 S. Grant \$70,000**  
Reduced! Open floor plan, 3 bdrm, 2  
bath low maintenance brick exterior,  
patio, full bsmt. 1 car attached garage.  
Room for your family to grow.

1473 Pioneer Drive	\$117,500
1125 S. Court	REDUCED
310 S. Garfield	\$129,000
1175 Brookside	\$135,000
1285 E. 8th	CONTRACT
575 LaHacienda	SOLD
1818 Harvey Ct.	"NEW PRICE"
1675 W 4th	"UNIQUE"
310-316 W 7th Oakley	"COMMERCIAL"
	"4-PLEX"

## Stock Realty & Auction Featured Homes

### Must See



• **Brick Spacious Home**  
• **Full Basement - large rooms**  
**785 S. Lincoln \$126,500**

### Reduced Price



• **24x24 Garage**  
• **2 bedroom cottage**  
**595 S. Grant \$59,900**

### Full of Wow!



• **Lots of New**  
• **3 bedroom, 2 baths**  
**265 S. Grant \$74,900**

### Look!



• **Great Value**  
• **4 bedroom, oversized grg**  
**620 N. Range \$55,500**

### So Lovely



• **One level, 3 bedroom**  
• **1 car garage and more**  
**325 E. Pine \$59,900**

### Brewster Home



• **3 - 4 bedroom**  
• **Lots of upgrades**  
**402 Nebraska \$42,500**

### One-level



• **3 bedroom, 1 car garage**  
• **Corner lot**  
**685 S. School \$56,000**

### Lets Talk!



• **Attractive Home**  
• **Lots and lots of garages**  
**665 E. 8th \$77,500**

### Building Lot



• **Established wind break**  
• **West edge of Colby**

**MOLLY J.  
OLIVER**  
Residential  
Specialist  
462-6133 (res.)



**STOCK REALTY & AUCTION CO.**  
390 N. Franklin, Ste. 100, Colby, KS 67701  
[www.stockrealtyandauction.com](http://www.stockrealtyandauction.com)  
**785-460-SOLD (7653)**  
**QUALITY LAND BROKERS & AUCTIONEERS**

**\* Save \$8,000 \***

**First Time Buyer  
Tax Credit.**

**Contact Molly for  
Booklet and details.**



**REDUCE  
REUSE  
RECYCLE**

**1977 – 2009  
30+  
YEARS OF  
EXPERIENCE  
EXPERTISE  
EXCELLENCE**

## FARM & RANCH REALTY, INC.



1420 W. 4<sup>TH</sup> – P.O. BOX 947  
COLBY, KS 67701  
785-462-3904  
**DONALD L. HAZLETT, Broker**



**DON HAZLETT**

[www.farmandranchrealty.com](http://www.farmandranchrealty.com)

**WE INVITE YOU TO TALK TO ONE OF OUR REAL ESTATE PROFESSIONALS!**

**Naomi Ward • Steve Hazlett • Ron Evans • Ed Currier • Neal Mann • Mike Bailey • Scotty Legere**

### AUCTION SCHEDULE

**10/02/09 – 600 ac cropland &  
grass N of Quinter – 26-10-26**  
**10/06/09 – 1,870 ac Phillips Co,  
Colo irrigated, dryland, grass &  
CRP selling in 8 tracts for  
Gloria Woodmancy Trust**  
**10/10/09 – Bartlett Concrete  
liquidation, Burlington, CO for  
Chris Bartlett Estate**  
**10/15/09 – 480 ac Wichita Co  
cropland selling in 3 tracts for  
Doug Hill Trust**  
**10/20/09 – 160 ac Cheyenne Co,  
KS cropland selling in 2 tracts  
for Waters Grandview Farms,  
LLC**  
**10/27/09 - 23,808 deeded acres in  
4 stand alone ranches in Bent,  
Baca & Las Animas Counties,  
South of Las Animas, selling  
in 7 tracts or combos for  
WGW, Inc., et al.**  
**12/01/09 – Krebs Ranch – 9,600  
acres on Smoky Hill River  
between Oakley and Scott City,  
KS on Hwy 83 – 5 tracts and  
combos**

### COMMERCIAL BUILDING



**1921 S. Range - Located in the  
original Walmart Plaza – 7,500 sq.  
ft.– \$199,500**



**5<sup>th</sup> St & Martin Ave – \$ 57,000**

**600+/- ACRES CROPLAND & GRASS  
LAND AUCTION  
SHERIDAN COUNTY, KS  
Fri., Oct. 2, 2009 @10:30 AM, CDT**

**AUCTION LOCATION:  
Scout Center, Hoxie**

**SELLERS:  
Richard L. Sterrett &  
Carolyn More**

**Section 26-10-26,  
less 35 ac owned by the  
State of Kansas**

- 215.6 cropland ac
- 384.4 grassland ac

Great section of **productive  
cropland w/live springs** in  
the pasture. Good access  
plus **hunting potential**—some  
breakable grass

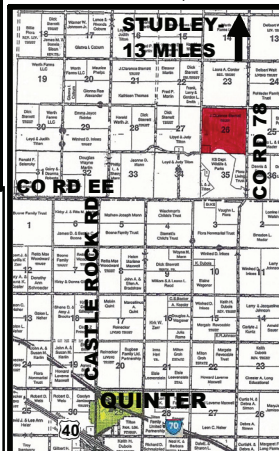

Land located NE of  
Quinter adjoins the KS  
Dept of Wildlife & Parks

**\*CHECK OUR WEB SITE FOR  
ADDITIONAL LISTINGS!**

**THESE BINS ARE EMPTY AND  
READY FOR FALL GRAINS!!**

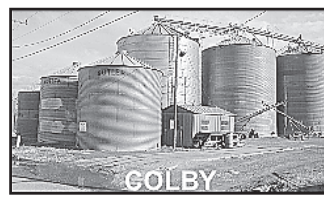

**114,000 bu (3 steel bins)  
storage plus 10,000 bu grain  
elevator in downtown Colby.**



**240 E. Plum**

**"When you list with Farm & Ranch,  
it's as good as SOLD!"**

**Stick With the Classifieds.**

**If you're looking to buy, sell or trade,  
check out the Classifieds. It's fast, easy and  
you'll find what you are looking for!**

**The Colby Free Press Classifieds  
785-462-3963**