

To place your classified ad, mail (155 W. Fifth), fax (785-462-7749), phone (785-462-3963), or stop by our office at 155 W. Fifth

Kansas Classified Network

Career Opportunity
AIRLINES ARE HIRING - Train for high paying Aviation Career. FAA approved program. Financial aid if qualified - CALL Aviation Institute of Maintenance. 888-248-7449.

Career Opportunity
ALLIED HEALTH career training - Attend college 100% online. Job placement assistance. Computer available. Financial Aid if qualified. SCHEV certified. Call 800-481-9409 www.CenturaOnline.com

Career Opportunity
ATTEND COLLEGE ONLINE from Home. *Medical *Business *Paralegal, *Accounting, *Criminal Justice. Job placement assistance. Computer available. Financial Aid if qualified. Call 888-220-3977 www.CenturaOnline.com

Career Training
ALLIED HEALTH career training - Attend college 100% online. Job placement assistance. Computer available. Financial Aid if qualified. SCHEV certified. Call 1-800-481-9409 www.CenturaOnline.com

Help Wanted
"CAN YOU DIG IT?" National Heavy Equipment 3wk training program. Backhoes, Bulldozers, Trackhoes. Financing avail + Post G.I. bill approved. Local job placement asst. 866-362-6497

Kansas Classified Network

Help Wanted
Deliver buses out of Hutchinson, KS. IMMEDIATE OPENINGS for CDL Drivers. 17 Reload Locations. Flexible Schedule. Daily Settlements. We know how to treat a driver like family. 1-866-764-1601

Help Wanted
"Hundreds of Health Care Jobs Available! Connect with Kansas employers at www.KSHealthJobs.net. Search for Kansas positions - post your resume - apply on-line. Absolutely FREE. Visit www.KSHealthJobs.net."

Help Wanted/Truck Driver
Need CDL Drivers A or B with 2 yrs recent commercial experience to transfer motor homes, straight trucks, tractors, and buses. www.mamotransportation.com 1-800-501-3783

Help Wanted/Truck Driver
"You got the drive, We have the Direction" OTR Drivers APU Equipped Pre-Pass EZ-pass Pets/passenger policy. Newer equipment. 100% NO touch. 1-800-528-7825



Restaurant Equipment For Sale

5,000 Sq. Ft. of Equipment

- Ranges
- Tables
- Salad Bar
- Fryers
- Ovens
- Booths
- Chairs
- Dishes

You name it and more equipment can be inspected in Burlington, Colorado. Call Dave Cap 402-651-6519

Real Estate



YOUR LEADER FOR HOME LOANS IN NW KANSAS

Farmers & Merchants Bank of Colby

240 W. 4th St., Colby, Kansas (785) 460-3321



Jacque Golemboski
Mortgage Loan Officer
NMLS #643818
F&M Bank NMLS #528146



Mortgage interest rates are as low as:

- 15 year loans - 3.625%* (3.713% APR)
- 20 year loans - 4.250%* (4.318% APR)
- 30 year loans - 4.250%* (4.301% APR)

*Rates may change without notice subject to market conditions. APR based on a loan of \$100,000, actual fees may vary. Mortgage products are subject to change and availability. The actual mortgage product you qualify for will depend upon the verification of the value of your home, your credit score and other considerations.

Rates shown assume:

- Excellent Credit
- Conventional Loan, 80% Loan to Value
- Single Family Residence

Real Estate



Molly J. Oliver
462-5203



Terry Stover
626-2082



Kevin Barnett
443-1722

| | | | |
|----------------------------------------------------------------------|--------------------------------------------------------------------------|-------------------------------------------------------------------------------|--------------------------------------------------------------------------|
| | | | |
| JUST LISTED A Beautiful Home 228 Nebraska \$75,500 | Move-in Ready 4 BRS, 2 bath, 3 grg/shop 526 Main \$119,500 | So very lovely Fm room w/fireplace 309 Rock Island \$42,000 | Take a Look 3 BR with new look 815 E. 8th \$57,000 |
| | | | |
| Lots of Privacy Spacious home & 42x45 grg 825 W. 8th \$122,500 | So very Attractive Spacious 4 BR, 3 bath 480 W. 5th \$135,500 | OPEN Sunday 1:00 - 2:00 6 BR, 3 bath, 2 car grg 1310 Brookside Come See | Great Home 4 BR, 3 bath 5 +/- acres 194 Co Rd 3 Brewster |
| | | | |
| Cabin Feel Large Corner Lot Call Terry 440 W. Summit | Convenience Store & Gas Call Terry for details 3597 Hwy 83 Rexford | 29 Storage Units Great Investment E. George Dighton KS | 8 Lane Bowling Alley Call Kevin for details 2406 Hwy 40 Wakeeny KS |

Stock Realty & Auction Co. 390 N. Franklin Ste. 100 • Colby, KS 67701 • www.stockra.com (785) 460-7653

Real Estate



NOW HIRING

- Part-Time**
- Housekeepers
 - Night Auditor

Fuel Discounts! • Holiday Incentive Pay! • 401(K)!
Employee Recognition Programs! • Advancement Opportunities!

Apply at Hampton Inn
1000 E. Willow Dr., Colby, KS
EOE Post-Employment Drug Testing Required

FARM & RANCH REALTY, INC.

1977 - 2011
34+
YEARS OF
EXPERIENCE
EXPERTISE
EXCELLENCE

1420 W. 4th - P.O. BO 947
COLBY, KS 67701
785-462-3904

DONALD L. HAZLETT, Broker
www.farmandranchrealty.com

Naomi Ward • Steve Hazlett • Ron Evans • Neal Mann • Ed Currier • Mike Bailey • Scotty Legere

ABSOLUTE LAND AUCTION

4,975 ACRES

PRIME THOMAS & RAWLINS COUNTY CROPLAND

Tues, Nov. 22, 2011 @10:30 AM, CST
City Limits Convention Center, Colby, KS

- Immediate possession
- Good access
- Mineral rights to the Buyers
- Grain bin site w/170,000 bu capacity
- Large shop - 3 phase electrical



MAGNIFICENT COUNTRY HOME on 14.72 ac SE of Colby, NEW shop bldg, round top hay shed - house has 4,500 sq. ft., 5 BR, 3 baths, 3 car garage, underground sprinklers, new windbreak w/drip lines.
MUST SEE TO APPRECIATE!
Price - \$399,000

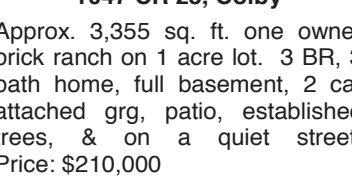

****CHECK OUR WEBSITE FOR ADDITIONAL LISTINGS & VIRTUAL TOURS!****

REAL ESTATE FOR SALE

- NORTON** - 160 ac 6S & 1/2W of Norton - 149.5 ac in CRP, \$5,232 ann pmt, 9 yrs remaining - fantastic hunting
- NESS** - Nice CRP quarter East of Brownell - SE/4 of 20-16-21
- WICHITA** - 80 ac cropland 6 1/2 W & 5N of Leoti
- SHERIDAN** - 160 acres center pivot irrigated quarter - Modern home, shop, machine shed, & small feeding area, NE of Grinnell - SE/4 of 8-10-29

AUCTION SCHEDULE

- 10/19/11 - 800 ac Logan County cropland & grass selling in 2 tracts & combos, near Russell Springs
- 10/25/11 - 500+ ac Greeley County cropland & CRP w/gas production near Tribune selling in 5 tracts & combos
- 11/1/11 - 285+ ac Gove County cropland & grass - near the East edge of Oakley - selling in 4 tracts & combos
- 11/5/11 - Farm Machinery & Equipment for Vincent & Kathy Zerr - 5 1/2 mi E of Angelus - CONSIGNMENTS WELCOME!
- 11/8/11 - 160 ac excellent center pivot irrigated quarter NW of Grant, NE - GH sprinkler nozzled at 850 GPM
- 11/10/11 - 480 ac excellent Kit Carson County cropland North of Seibert, Colorado selling in two tracts and combination
- 11/15/11 - 1,280+ ac Graham County expired CRP cropland & grass, S of Hill City, selling in 5 tracts & combos
- 11/22/11 - 4,975 ac PRIME Thomas & Rawlins Counties, KS cropland, imm poss, good access, mineral rights to Buyers, 170,000 bu grain bin site, large shop - 3 phase electrical - selling in 26 tracts & combos
- 12/1/11 - 1,120 ac Comanche County cropland - grass - CRP - mineral rights to be offered separately - South of Coldwater (near Buttermilk) - 10 tracts & combos
- 12/13/11 - Wendell Farm Machinery & Equipment Auction at the Farm & Ranch auction pavilion in Colby

"When you list with Farm & Ranch, it's as good as SOLD!"

MUCH MORE DAY OF SALE! Lunch will be served!
Tom Harrison-Auctioneer-Broker: (785) 443-0136
Tom Simpson-Auctioneer: (785) 443-1153
Bob Jones-Auctioneer: (785) 443-0138
TNT AUCTION
For complete sale bill, visit: www.tntjonesauction.com

getcaughtrecycling.org™