

Classifieds

Card of Thanks

Thanks to Shepard Staff, Tim and Gwen Griffiths, Wes Bencken and the Young People of Celebration Community Church of Hays for the repair, painting and new sign for the Museum. - Rexford Historical Society
---9/21---9/28---

Notices

Save this 10% Coupon and phone 785-462-5572 for repair and bags on vacuum cleaners. Formally N.W. Vacuum, Erwin E. Thiele.
---9/26---10/15---

Plum Creek Ltd - Downtown Colby - Festive Fall Sale! Come in for your 25% off discount card and enjoy storewide savings! Wednesday, Sept. 26 - Saturday, Sept. 29.
---9/24---9/28---

Colby Fall Fling - Homebased Business & Craft Show, Saturday, October 6, 9 a.m. - 3 p.m., 4-H Building, Thomas County Fairgrounds.
---9/24---10/5---

Carpet Cleaning: 3 Room Special - \$159.95! Dry-Foam Safe and Green Seal approved. Serving NWKS mileage free since 1987. A+ Cleaners (785) 538-2526 or (785) 443-5400, Johnene Cheney.
---9/5---10/29---

Fall Clean-Up Time! Will haul away unwanted items and help with your clean-up needs 785-672-4163 please leave message.
---8/22---TFN---

Dan is back! Dan Geschwentner. Small remodeling and repair jobs. Call 785-443-3673.
---12/15---TFN---

Classified ad deadlines (word ads only). Noon the day before publication (noon Friday for Monday paper). Please check your ad the first time it runs. If you find an error, please call at (785) 462-3963 so it can be corrected, since we will not be responsible for errors after that first day. The Colby Free Press.
---3/1---TFN---

Help Wanted

Holiday Inn Express is looking to fill the position of a part-time breakfast attendant, 3-5 mornings per week, which would include some weekends. Please apply in person at Holiday Inn Express & Suites, 645 W. Willow, Colby, KS.
---9/27---10/3---

Needed OTR Driver. Peterbilt equipment, Blue Cross healthcare, good home time & top wages. 785-675-8375.
---8/15---TFN---

Enjoy the 100 Greatest Books of All Time and Never Have to Read a Word!

FOR LESS THAN \$1 A BOOK, you'll be captivated by the stories from the 100 greatest literary classics of all time... without ever having to read a word. Listen to them in audio book format, preloaded on the included personal MP3 player.

Your collection includes:

- ✧ Adapter for listening in the car
- ✧ Personal headphones
- ✧ Just \$99!

Call Now!

888-807-6501

24 hours a day

FREE GIFT for Acting Now

Order now, and you'll receive a special FREE gift: *50 of the most enchanting classical music works* (a \$50 value) by the world's great composers: Beethoven, Brahms, Tchaikovsky... all your favorites!

© 2012 Library of Classics, Inc.

Help Wanted

At Frontier Ag we value initiative, results and will reward your abilities with good pay, benefits and responsibility as a member of a Northwest Kansas Ag leader. In Atwood, Ks there is opportunity for a bulk fuel driver. You must be a qualified driver with CDL and have the ability to get endorsements. Call Stuart Johnson at 785-626-9001. Drug Screen required. EEO Employer.
---9/26---10/1---

Great Western Tire of Colby, Inc., 1170 S. Country Club Drive, has an opening for a full time tire technician. Experience required, but will train the right person. Full time position includes competitive salary and benefits. Apply in person, EOE. Questions please call 785-462-2100.
---9/21---TFN---

St Francis Community Services is accepting applications for the following positions: THERAPIST, LMSW, LMFT, LPC. Provide in home family services and case management using a therapeutic model. Builds on the strengths of the families to resolve issues and maintain the family as a whole. Requires 2 yrs. exp. working with children & families, dependable transportation, a clear MVR/KBI, at least 21 years of age & Master's Social worker, counseling, marriage & family or related field, BSRB license. SOCIAL WORKER, LBSW, LMSW, LPC, LMFT. Work with children/families in Foster Care Reintegration contract to develop permanency options for the children through reintegration with originating-family or other permanency alternatives. Requires one of above licenses, a clear MVR/KBI, exp. working with children & families, dependable transportation & at least 21 yrs. of age. SFCS offers an excellent benefit package & competitive wages. Send Resume to kerri.kemp@st-francis.org, or Apply online at: www.st-francis.org. EOE
---9/20---10/3---

Now Hiring! CNA's, FT/PT available. Competitive wage scale. Apply in person at Deseret Health & Rehab at Colby, 105 E. College Dr., Colby, KS or call 785-462-6721 EOE.
---9/19---10/1---

Midwest Well & Pump, Inc. is seeking qualified applicants for the positions of: mud rotary driller & irrigation pump setter, for the water well industry in the SW KS area. Applicants must have a CDL, clean driving record & 4+yrs. experience. We offer competitive wages, benefits and OT. Submit resumes to: P.O. Box 692 Garden City, KS 67846, Fax to: (620) 275-4695, or Email to: Midwest@wbsnet.org Office #: (620) 275-1920 with any questions.
---9/19---10/1---

Help Wanted

Thomas County is requesting applicants for the position of County Appraiser. Responsibilities are administrative and supervisory work in appraiser's office, be responsible for annual valuation of all real and personal property, as well as field inspections, data collection, index/depreciation studies; valuation hearing; and prepare annual maintenance reports. Strong leadership, interpersonal communication, planning and decision-making skills are necessary, as well as fiscal management experience. Requirements include CAE, RES, RMA, or general certification from Kansas Real Estate Appraisal Board, three (3) years appraisal experience, along with high school diploma or equivalent. Applicant will be qualified by Director of Property Valuation and meet all qualifications of the State of Kansas. Salary based on experience. EOE and ADA employer. Please send resumes to: Thomas County Clerk, 300 N Court Ave., Colby, KS 67701 or obtain application from HYPERLINK "http://ks-thomas.manatron.com" "http://ks-thomas.manatron.com" or call 785-460-4500. Return application with comprehensive resume by Friday, October 12, 2012.
---9/19---10/11---

Now Hiring - Housekeepers for our Independent and Assisted Living Apartments. Experience preferred but will train a qualified applicant. Good hours, Monday - Friday and Aflac available. Great place to work that is very rewarding. Apply in person at Fairview Estates Retirement Community, 1630 Sewell Ave., Colby, KS. 785-462-2154 EOE.
---9/20---10/3---

Stephens Construction, Inc. is accepting applications for full time construction crew workers. Experience in steel &/or wood-frame building erection required. Concrete and other construction experience preferred. Competitive wages and benefits. Apply in person at 1260 S. Country Club Drive, Colby.
---9/17---10/5---



Join the Blue Sky Satellite team!

Blue Sky Satellite installs exclusively for DISH Network with 12 locations in the Midwest.

Starting Pay is \$13.50 - \$15 per hour!!

Our Technicians receive Top Hourly Rates, Overtime Pay, 4 Day Work Week, Company Vehicle, Monthly Performance Bonuses and Excellent Benefits.

If you would like to find out more about an exciting career in our telecommunication installation field, apply online at www.blueskydish.com under the Jobs tab or call Ray Ziegler at 316-619-2552.

Kiss Unwanted Items Goodbye



Sell them in the Classifieds

785-462-3963

Help Wanted

City Limits Grill is accepting applications for a bartender and a maintenance person. Please apply in person at 2227 S. Range.
---9/13---9/28---

Latham Construction in Winona, KS is seeking full-time or part-time help. Construction background preferred. Contact Rachel for application. 785-846-7433.
---9/10---10/5---

Family farm seeking full time employees. Non smoking environment. CDL and mechanical skills a must, compensation based on experience and performance. 785-462-5580.
---9/5---10/1---

PSI Transport, LLC, is always looking for good company livestock and grain haulers as well as shop mechanics. Competitive pay life/health/dental benefit and bonus program available . EOE (785) 675-3477
---7/13---TFN---

Wanted - Experienced Truck Driver. Good pay, benefits, decent home time. Jack 785-675-8375 or Jim 785-675-2196.
---3/22---TFN---

Help Wanted

Carriers needed to deliver the Colby Free Press! Great for someone needing extra income. A few hours a day, 4 days a week. Bonus after 3 months. To apply please stop by the office at 155 W. Fifth St., Colby or for questions call 785-462-3963.
---3/21---TFN---

Now hiring for all positions. Apply between 6 a.m. - 1 p.m., Monday - Saturday. See Don or Tammy at Village Inn Restaurant, 2215 S. Range.
---9/7---TFN---

Office Space for Rent

Downtown office space available at 5th and Franklin. Call 785-462-3939.
---10/12---TFN---

Misc for Rent

Generators for rent: 30kW and 2100 kW. Self-contained, trailer mounted. Single phase and 3 phase units. Call 785-675-8974.
---9/24---10/19---

Misc for Rent

Roll off boxes. Great for construction projects. Call for details. 785-443-1339.
---2/9---TFN---

Misc. for Sale

Pebble Embossed Plastic Banquet rolls 40"x300" (white) \$30 + tax. Can be purchased at the Colby Free Press, 155 W. 5th St.
---3/21---TFN---

Must Sell! Construction materials in front lot, 740 E. 4th, Colby, viewable outside, call 785-443-1339 to make offer.
---2/9---TFN---

TAKE A SMALL STEP TO GET HEALTHY

www.smallstep.gov

Ad Council.org



We make HOME LOANS Easy & Convenient

Conventional Loan Interest Rates

	Rate	APR	Payment
*15 Year Fixed:	2.375%	2.448%	\$660.92
*20 Year Fixed:	3.000%	3.072%	\$554.60
*30 Year Fixed:	3.000%	3.041%	\$421.60

* Annual Percentage Rates listed above are based on a \$100,000.00 loan with an 80% loan to value and 30-day rate lock. The payment reflects a monthly principal and interest payment excluding monthly taxes and insurance. Rates may change without notice subject to market conditions.

Apply ONLINE from the convenience of your home at www.wsbs.com or

stop by our office at:

2080 S. Franklin, Suite 4, Colby, KS

785-462-2151

WESTERN STATE BANK

"Quality Tradition You Can Trust"



Real Estate

HomeLand REALTY AUCTION

(785) 462-8255
www.HomeLandRE.com

Pat Sloan (785) 443-3261
Marilyn Meyer (785) 462-2703
Toni Lindberg (785) 443-4032
Rock L. Bedore (785) 443-1653
Tom Harrison (785) 443-0136
Jerry Wycoff (785) 672-0429

1055 S. Range - PO Box 508 Colby, KS

INCOME PRODUCING

1675 W. 4th
6,000' Office + 4,500' Warehouse
Give Pat a call today!

NEW LISTING
CONTRACT
280 N. Mission Ridge
4 BR/2 Bath
Give Marilyn a call!

PRICE REDUCED
1175 Summer Sun
4 BR/2 Bath
Give Rock a call!

BRING US AN OFFER
1690 W. 4th
Well maintained office space
Call Marilyn today!

135 E. Walnut (Lot) \$4,500
224 Price, Oakley CONTRACT
201 Edgerton, Oakley **SOLD**
621 Cornell, Oakley \$59,500
270 W. Webster CONTRACT
480 S. Chick CONTRACT
135 N. Grant-Exclusive CONTRACT
280 N. Mission Ridge CONTRACT
1060 E. 8th CONTRACT
125 E. Walnut CONTRACT
1175 Summer Sun \$89,500
340 S. School **SOLD**
685 W. Cherry CONTRACT
445 Lawrence \$129,900
1365 E. 8th **SOLD**
122 W. Park, Bird City \$149,500
805 E. 2nd, Oakley **SOLD**
705 S. Range CONTRACT

TURN KEY STEAK HOUSE
464 Hwy 83, Oakley
Some owner financing available
Call Tom for an appointment!

COMMERCIAL LISTINGS

2-6 acre lots located along I-70 frontage, Colby, KS. Give Marilyn a call today!
1690 W. 4th, Colby, KS Well maintained office with over 2,100 sq. ft. \$150,000 Call Marilyn!
1675 W. 4th, Colby, KS Use the warehouse and let the office lease help with payments. \$195,000 Call Pat!
111 W. 3rd, Oakley, KS 10,000+ sq. ft. building with excellent parking and a steel roof. \$185,000 Give Rock a call today!
464 Highway 83, Oakley, KS Colonial Steak House. Some owner financing available. \$340,000 Call Tom!
Commercial lot 10 acres North of I-70 between Franklin & Country Club Drive East of Bourquins. (Can be split) Call Tom!

AG LAND LISTINGS

6403 Old Hwy 40, Park, KS 41 acres Grassland, 3 bedroom house with several upgrades. \$159,000 Call Rock!
80 Ac. Thomas Cty., KS Cropland located 7 miles South of Brewster, KS **SOLD**
480 Ac. Rawlins Cty., KS Cropland 15 North & 3 West of Levant. Immediate possession. All minerals to Buyer. **C O N T R A C T**
160 Ac. Cheyenne Cty., KS Dryland 9 miles South of Bird City. 1/2 minerals to Buyer. **SOLD**
1200 Ac. Gove Cty., KS Grass, irrigated & dryland located 10 miles SE of Oakley, KS. \$1,456/Ac. **C O N T R A C T**

Real Estate



Molly J. Oliver
462-5203



Kevin Barnett
443-1722

Stock Realty & Auction Co.

390 N. Franklin Ste. 100
Colby, KS 67701

www.stockra.com
(785) 460-7653

Follow us on Facebook



Great Family Home, 6 BRS, 3 Bths - Plus
1809 Harvey Ct. \$159,900

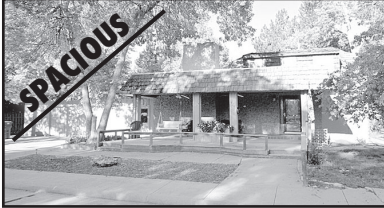

OVER 4,000 Sq. Feet Huge Rooms & More
670 N. Lincoln \$139,500



Great Office Building Fantastic Location
Purchase or Lease!!



OPEN HOUSE Sunday, Sept. 30, 1-2 p.m.
940 W. 2nd



Cute 2 BR Cottage Corner Lot
685 N. Sterling \$46,000



Lease Space Available. Located in Colby
Dillons Store Call Molly for Details



Huge Fenced Corner Lot! 3 BR, 2 Bath
Home 210 W. 5th \$92,500



We have Several Residential Building Lots
Call Molly 462-5203



157.1 +/- Farm Acres NE/4 18-25-6
Reno Co. Call Kevin Barnett 443-1722

A Home Is Burglarized Every 18 Seconds, Don't let yours be the next!



FREE Home Security System! \$850 Value!



Available Two-Way voice that allows you to instantly communicate with an ADT Security Specialist!

Call Today, Protect Tomorrow!
1-888-766-5996

Mon-Fri 8am - 11pm • Sat 9am - 8pm • Sun 10am - 6pm EST



Protect Your Home

\$99.00 Customer Installation Charge. 36-Month Monitoring Agreement required at \$35.99 per month (\$1,295.64). Form of payment must be by credit card or electronic charge to your checking or savings account. Offer applies to homeowners only. Local permit fees may be required. Satisfactory credit history required. Certain restrictions may apply. Offer valid for new ADT Authorized Dealer customers only and not on purchases from ADT Security Services, Inc. Other rate plans available. Cannot be combined with any other offer. Licenses: AL-10-1104, AZ-HOC217517, CA-AC06230, CE-ELC1039344-LS, DE-07-212, FL-EC13003427, EC13003401, GA-LM205395, IA-AC-0016, ID-3131, IL-127010102, IN-City of Indianapolis: 93294, IN-City of Louisville: 483, LA-F1802, MA-13356, MD-1071375, Baltimore County: 1375, Calvert County: AB100625, Caroline County: 1157, Cecil County: 541-L, Charles County: 804, Dorchester County: 764, Frederick County: F0424, Harford County: 3541, Montgomery County: 1276, Prince George's County: 685, Queen Anne's County: L156, St. Mary's County: LV20398, Talbot County: L674, Wicomico County: 2017, Worcester County: L1013, MI-3601205773, MN-T501807, MO-City of St. Louis: CC354, St. Louis County: 47738, MS-15007958, MT-247, NC-25310-SP-UV, 1622-CSA, NE-14451, NJ-348F00021800, NM-353366, NY-68518, City of Las Vegas: B14-00075-6-121756, CT-11262-L-121756, NY-Licensed by the N.Y.S. Department of State UDH12000228451, OH-53891446, City of Cincinnati: AC06, OK-1048, OR-170997, Pennsylvania Home Improvement Contractor Registration Number: PA22999, RI-3428, SC-8AC3630, TN-C1164, C1520, TX-B13734, UT-6422396-6501, VA-115120, VT-ES-2382, WA-602588694/PRO1E1H934HS, WI-City of Milwaukee: 0001697, WI-942433, WY-11-G-21499. For full list of licenses visit our website www.protectyourhome.com. Protect Your Home - 3750 Priority Way South Dr., Ste 200, Indianapolis, IN 46240. **Crime data taken from http://www.fbi.gov/galleries/posters/pdfs/Crime_Clock.pdf