

To place your classified ad, mail (155 W. Fifth), fax (785-462-7749), phone (785-462-3963), or stop by our office at 155 W. Fifth

Notices

Farmers Christmas Market Craft Show BP Miller Building, 895 S. Country Club Dr., Colby, KS, Saturday, December 7, 9 a.m. - 3 p.m. Linda's Bakery, Way Back Yonder, Made of Iron, The Denver Lady, Odds & Ends by Mandy Vaughn McAtee, Geraldine's Sugar Cookies, Parker's Homemade All Beef Summer Sausage & Spicy Mustard. ---11/25---12/6---

Divorce Recovery for Women - 10 weeks of classes/support group, every Monday - January 6 through March 10, 2014, 6:30 - 8 p.m. CST. Colby United Methodist Church, 950 S. Franklin, Colby, KS. All women welcome. Call to enroll 785-675-8606. ---11/21---12/5---

Gizmo's Antiques & Collectibles Pre-Christmas 10% Off Sale, November 22 - December 24. Open Wednesdays and Fridays 10 a.m. - 6 p.m. 820 S. Franklin, Colby, or call 785-443-0900 for appointments. ---11/21---12/24---

4th O'Christmas Tree Open House 3380 W. 4th St., Colby KS, Sunday, December 1, 2013, 1 - 6 p.m. Open December 1 - 21. Week days 5 - 8 p.m., Saturday 9 a.m. - 6 p.m., Sunday 1 - 6 p.m. 785-443-3448 or 785-443-1064. ---11/13---12/2---

Notices

Dan is back! Dan Geschwentner. Small remodeling and repair jobs. Call 785-443-3673. ---12/15---TFN---

Classified ad deadlines (word ads only). Noon the day before publication (noon Friday for Monday paper). Please check your ad the first time it runs. If you find an error, please call at (785) 462-3963 so it can be corrected, since we will not be responsible for errors after that first day. The Colby Free Press. ---3/1---TFN---

Help Wanted

Part-time evening help Thursday, Friday and/or Saturdays. Pick up application at Gambino's Pizza, 1100 W. 4th, Colby, KS. ---11/27---12/4---

Hitchcock, Inc. of Goodland is expanding our Valley irrigation business. Taking applications for parts and service management, project supervisors and experienced electrical technicians. Career opportunities include benefits and retirement plan. Business management, pipeline fabricator or electrician with technical experience is beneficial. Call 785-899-5628 for information. Drug test required. ---11/25---12/9---

Help Wanted

Field Sales Administrative Assistant I - FBL Financial Group is seeking indiv to assist a Farm Bureau Agency Manager. Tasks involve comm w/field & office personnel research/report prep; asst Agency Mgr; mtg plan/prep; appt setting & support new acct growth, prod & retention. HS diploma/equiv req; 2 yr clerical exp/degree + 1 yr exp req; MS Office products; good mtg planning skills; maintain confidentiality; 40 NWPM; strong cust serv & public relations skills. If interested, apply at www.fblcareers.com. EOE ---11/27---12/4---

The Wallace County Community Care Center in Sharon Springs has a current job opening for a Certified Dietary Manager. The successful candidate will be responsible for: Running the day-to-day dietary department operation, management of food service, employees including scheduling, hiring, employee relations and performance management. Other responsibilities include nutrition consulting, meal/menu planning, inventory control, nutritional assessments, care plan participation, budgeting and purchasing. Contact Lydida at 785-852-4244 or email at wcccsharonsprings@gmail.com. ---11/25---12/23---

Help Wanted

Colby Lumber looking for yardman to make deliveries and general duties. Please inquire in person 1760 W. 4th, 785-460-2181. ---11/25---12/9---

Drivers: Home Daily! Eagle Express Lines, full-time postal route openings from Oakley to Denver, CO and Topeka, KS! \$20.27 plus \$4.93 Health & Welfare. Apply: www.eagleexpresslines.com. ---11/25---12/9---

Wagoner Repair & Performance, 1100 S. Country Club Dr, Colby, KS 785-460-1081. If you are a diesel mechanic or an auto mechanic and you are interested in working decent hours, with weekends by choice, please apply. Health insurance is optional. ---11/22---12/13---

Colby 24/7 Travel Store has an opening for a full time Assistant Manager. Our employees are customer service oriented and have an outgoing personality. Benefits include, flexible hours, BCBS insurance, 401K, Paid Vacation, and Incentive pay. Apply in person at 24/7 Travel Store 1980 south Range. Also check us out on the web www.24-7stores.com. ---11/22---12/13---

Help Wanted

Truck Town has a position open in the refurbishing bay for hard working self-motivated individual. Drug test will be required. Clean and friendly work environment with good hours. Apply in person or send resume to Truck Town, 105 W. Horton Ave., Colby, KS 67701. ---11/21---12/5---

Rawlins County USD 105 is accepting applications for Part Time Accompanist. To obtain an application, please come to the district office at 205 N. 4th Street 785-626-3236 or go to www.usd105.org. Rawlins County USD 105 is an equal opportunity employer. ---11/13---12/2---

Schwan's - Colby, KS Now taking applications! Must be 21 or older, good driving record, active license. Base pay + uncapped commission. Generous benefits package with paid vacation offered! Apply now: www.careers.schwansjobs.com Questions: 785.462.2871 EOE ---11/6---12/2---

Rawlins Count Health Center is hiring a Part Time Nutritional Services Cook. Applications available at www.rchc.us under Careers and may be returned to P.O. Box 47, Atwood, KS 67730 EOE. ---11/6---12/2---

Help Wanted

CDL Drivers - Must be at least 23 years of age, clean MVR, minimum 2 years of driving experience. Hopper experience a plus. Call 785-462-0087. ---9/9---1/3---

PSI Transport, LLC, is always looking for good company livestock and grain haulers as well as shop mechanics. Competitive pay life/health/dental benefit and bonus program available. EOE (785) 675-3477 ---7/13---TFN---

Office Space for Rent

Downtown office space for rent corner location, utilities included with rent. Call Thomas County Insurance 785-462-3939. ---10/3---TFN---

Buildings for Sale

Steel Building - Allocated Bargains, 40x60 on up. We do deals www.gosteelbuildings.com - Source# 18X - 620-577-4455. ---11/27---12/27---

HOME FOR SALE

- PRICE REDUCED -
\$289,000

340 E. WALNUT
Custom-built home in Colby with 6 bedrooms, 4 baths, home office with private entrance. 3,700 sq ft. Ready for your family. Leave message at 785-460-6501.

OPEN HOUSES

Sunday, December 1
1:00 to 2:00



(785) 462-8255
www.HomeLandRE.com

"Western Hospitality"



1130 Terrace Dr.



Pat Sloan
785-443-3261



1040 Villa Vista



Rock L. Bedore
785-443-1653

Woofter Construction & Irrigation, Inc. is looking for a full time **Estimator/CAD Tech**
Benefits include:
Vacation, Blue Cross Blue Shield, Aflac, 401K

Application is available online at www.woofter.com or pick one up at 1965 Thielen Ave., Colby, KS



Colby Community College is accepting applications for an **Administrative Assistant** to the coordinator of admissions. Excellent organizational, verbal and written skills necessary. Computer proficiency, friendly demeanor, ability to multi-task and supervise student workers is required. Understanding of the importance of technology, integrity, open communication, innovative thinking, a sense of humor, and ability to work as a team to increase enrollment in a rural setting is necessary. Flexible benefits program which includes options for single and family health and dental coverage, life insurance and reimbursement accounts. Sick leave and vacation leave allowances. Participation in state retirement program. Send application letter, resume and all postsecondary transcripts by December 4, 2013 to Colby Community College, Attn: Lisa Failla, 1255 S. Range, Colby, KS 67701. Materials may be sent electronically to lisa.failla@colbycc.edu. CCC is an Equal Opportunity Employer committed to diversifying its work force and encourages applications from women, members of minority groups, individuals with disabilities and veterans.

May Your Christmas Be Marion Bright

Annual Christmas Celebration

SUNDAY, DECEMBER 1

Starting at 12:30 p.m. in Marion, KS

- * 1870's Community
- * Historic Elgin House Tours
- * Over 35 Businesses Open with Promotions
- * 2 Levels of the Community Center Filled with Artists, Craftsmen, Christmas Collections & Food
- * Christmas Parade at 4 p.m. on Main Street
- * Marion County Lake Tunnel of Lights Tour at Dusk

Experience the QSI Advantage

60x120x16 \$55,900



One 30'x16' Split Sliding Door and One 3' Entry Door

Price Includes DELIVERY & INSTALLATION On Your Level Site. Travel Charges May Apply



FREE ESTIMATES
AND ON-SITE CONSULTATION
800-374-6988

Quality Structures, Inc. MATERIAL KITS NOW AVAILABLE

www.qualitystructures.com

NOW HIRING! MDS COORDINATOR, NURSE & DIETARY. Competitive wage scale. Apply in Person at Deseret Health & Rehab at Colby, 105 E. College Dr., Colby, KS or contact Cheryl or Marcia at 785-462-6721.

Western Sprinklers has an opening for Pump Rig Operator 50K, 401K, Vac, Health Ins.

Apply at Western Sprinklers, Inc., 1100 S. Range Ave, Colby, KS. Drug testing required.

FOLEY INDUSTRIES

\$2000.00 HIRING BONUS!!

Now Hiring - Experienced Field Service Technician

Enjoy working outside? Searching for great salary and great benefits? Stop Looking!

- Opening in the Colby area.
- Full maintenance and support of heavy equipment and EPG/Petroleum engines.
- Min. 3-5 years field technician exp. req.
- Continuous development through on-going training.

APPLY TODAY! www.foleyeq.com EOE

BE THE ONE TO CHANGE A LIFE



www.Youthville.org/BeTheOne

Save \$\$\$ on prescription drug costs!

SHICK can help!

Senior Health Insurance Counseling for Kansas (SHICK) can assist in comparing the 30 plans available for Medicare Part D Rx coverage.

See if you qualify for Extra Help with Rx costs!

Open Enrollment
October 15, 2013 -
December 7, 2013

Call TODAY! 1-800-860-5260.



SHICK is administered by the Kansas Department for Aging & Disability Services

MORTON BUILDINGS, INC.

Winter Work Specials

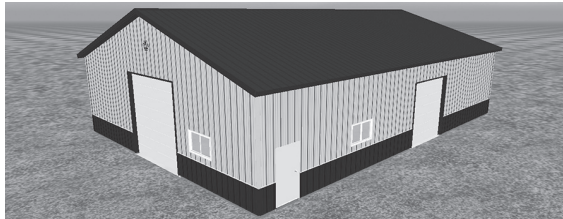

42' x 60' Winter Work Specials

- Basic Farm and Ranch storage with 2 garage doors & 1 entry door
- Good \$23,745 \$9.42/sf
 - Better \$24,783 \$9.84/sf
 - Best \$29,481 \$11.70/sf
- 26 ga. steel is standard on all Morton Buildings
 - Ask about our wind warranty with no MPH limits

8 Offices Serving Kansas. Call your local Morton Buildings office today for details and to schedule an appointment.

Prices and availability vary by location. Pricing and products subject to change without notice. Travel charges may apply. Offer ends 12/15/13. Photos may contain features not included in price. Certain restrictions apply. All transactions are subject to credit approval, applicable taxes and other terms. ©2013 Morton Buildings, Inc. Morton Buildings is a registered trademark. All rights reserved. A listing of GC licenses available at mortonbuildings.com/licenses. Ref 043.

800-447-7436 • mortonbuildings.com

Notice of Budget Hearing for Amending the 2013 Budget

The governing body of **Thomas County** will meet on the day of December 9, 2013 at 10:00 AM at Commissioners Room, 300 N Court, Colby, KS for the purpose of hearing and answering objections of taxpayers relating to the proposed amended use of funds.

Detailed budget information is available at Thomas County Clerk's Office, 300 N Court, Colby, KS and will be available at this hearing.

Summary of Amendments

Fund	2013 Adopted Budget			2013 Proposed Amended Expenditures
	Actual Tax Rate	Amount of Tax that was Levied	Expenditures	
General	8.835	847,343	2,561,522	2,689,522
County Health	0.165	15,822	326,574	424,054
			0	0

Shelly Harms
Official Title: County Clerk

(Published in the Colby Free Press on Friday, November 29, 2013)

The Northwest Kansas Educational Service Center

is advertising a vacancy for an Interrelated Teacher for the 2013-2014 school year. **Qualifications:** Must possess or be eligible to receive Kansas Teacher Certification. Training, education, experience, references, and interview results are some of the qualifications, which are considered for each candidate. For position details contact: Kurt Brown, Assistant Special Education Director at 785-672-3125 extension 120. Applications are available at www.nkesc.org or call 785-672-3125. **Application Deadline: Until Filled.** *NKESC is an Equal Opportunity Employer*

EXPERIENCE IT LIVE!

ROBERT EARL KEEN CHRISTMAS & HITS Friday, Dec. 6 @ 8PM

MICHAEL W. SMITH CHRISTMAS Friday, Dec. 13 @ 8PM

BÉLA FLECK & ABIGAIL WASHBURN - Feb 15

RONNY COX - Feb 16

LARRY THE CABLE GUY - Feb 28, 7 & 9:30PM

DAVID SEDARIS - Mar 13

REO SPEEDWAGON - Mar 14

MARTY STUART - Mar 22

ROGER MCGUINN - May 9

stiefeltheatre.org ticketmaster facebook **The Stiefel Theatre** for the Performing Arts
151 S. Santa Fe, Salina 785-827-1998

760+/- ACRES CROPLAND & GRASS

"MULTI-PARCEL" ABSOLUTE LAND AUCTION

DECATUR & RAWLINS COUNTIES, KANSAS

WED., DEC. 4, 2013 @ 10:30 AM, CST

AUCTION LOCATION: The Gateway, Oberlin, KS **SELLER:** Gilbert Bryan Family

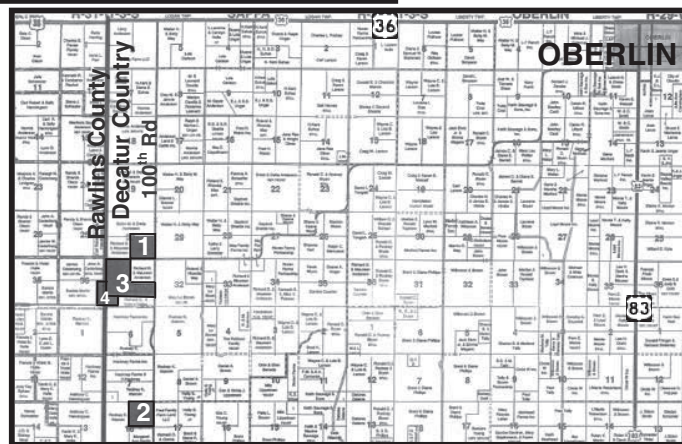

Land will be offered in 4 tracts & in combinations of tracts

LEGAL DESCRIPTIONS:

- TRACT 1: SE/4 of 30-3-30, Decatur Co - 152.5 ac cropland
- TRACT 2: NE/4 of 18-4-30, Decatur Co - 126.1 ac cropland & 24.0± ac grass
- TRACT 3: NW/4, N/2SW/4 & N/2SE/4 of 31-3-30, Decatur Co - 190.2 ac cropland and 120.6± ac grass
- TRACT 4: E/2SE/4 of 36-3-31, Rawlins Co & SW/4SW/4 of 31-3-30, Decatur Co - 114.2 ac cropland & 5.8± ac grass

INTERNET BIDDING AVAILABLE!

For a virtual tour & brochure visit www.farmandranchrealty.com

FARM & RANCH REALTY, INC.

Neal Mann, Listing Agent (785-635-2102)
Mike Bailey, Agent (785-678-8082)
1420 W. 4TH • COLBY, KS 67701
Toll Free: 1-800-247-7863
DONALD L. HAZLETT
BROKER/AUCTIONEER

"When you list with Farm & Ranch, it's as good as SOLD"