

*Senator fights for local judges

(Continued from Page 1A)
wants to move rural positions to urban areas where the case load is greater, he said.

"There's going to be a day when we're going to lose that," he added.

Gov. Brownback understands water issues better than any recent governor, he said.

"We've got a water governor who's conservative on water," he said, adding that he thought rural interests could make some gains on water issues.

Farmers can't just shut off their irrigation wells, he said, but at the same time, it's possible to use less water and make the supply go farther. He said he's doing that on his farm.

As the Senate and House finish their redistricting plans, required after every 10-year census, his focus is to keep as many districts in western Kansas as possible.

"We need to keep representation out here," he said. "I don't care what

their politics are."

He said his 18-county district, already the largest in the state, could add Phillips or another county, he said.

The first Senate map passed with 21 votes, mostly Democrats and "moderate" Republicans, he said, but the governor has promised to veto any plan that doesn't have the support of 21 Republicans in the Senate.

In the House, Rep. Ward Cassidy's 120th District would pick up Graham County for a total of six, while Rep. Rick Billinger of Goodland would add Logan and Wallace counties.

The situation with congressional districts, he said, "That's ugly."

A plan that would put urban, industrial, Democratic Wyandotte County in the 1st District with western Kansas isn't the answer, he said.

"Where does Wyandotte County fit in with the 1st District?" he asked.

*Farmer wants money

(Continued from Page 1A)
before the calf was destroyed. He said it was just cold and he might have been able to save it.

The cost of a newborn calf at the sale barn is about \$400 to \$500, he said. If the calf had grown to full size, he said, it would have brought \$1,000 to \$1,500. He asked the city for compensation somewhere between the two figures.

Mr. Morford said he also had to sell the cow because she was trying to steal other calves and causing trouble in the herd.

Mayor Bill Riedel said that the council would talk to Police Chief Wade Lockhart, who was not present, about the incident and get back with Mr. Morford.

In other business, the council:

- Received a letter from Susan Rynearson suggesting another contractor who might be able to look at the moldy buildings at Sappa Park. She also wrote that the Sappa Park committee will be bringing a master plan for the park to a council meeting in March.
- Agreed to appoint Bruce Meitl, Britton Scott and Kevin Brown to the airport advisory board. All three

own airplanes, Mayor Riedel said.

"They all have some skin in the game," he said, adding that there is no fixed number for the board, so all could serve.

• Heard that the city's insurance carrier is still investigating a fire that damaged the city's transformer in December and nothing has been said about how much it will pay.

• Learned that the city hasn't had anyone volunteer to represent it on the Economic Development Corp. board and a city appointee is still needed.

The board is going to Topeka in March to meet with legislators, Kansas Department of Transportation officials and National Guard officers, Mayor Riedel said.

• Were told that both the uranium and arsenic levels in the water system continued to be a little above government standards last year.

• Held a 15-minute closed meeting to discuss attorney-client privilege with County Attorney Steve Hirsch.

The next council meeting will be at 7 p.m. Thursday, March 1, in the upstairs meeting room at The Gateway.



STATE SEN. RALPH OSTMEYER (left) got a *Wall Street Journal* article from banker Bob Gaskill after a "town hall" meeting in Oberlin on Saturday. Both men were munching pizza furnished by the Decatur County Farm Bureau. — Herald staff photo by Cynthia Haynes

*Crime follows legislator

(Continued from Page 1A)
which can be a tough area.

He said his wife had spent the weekend in town, and they were going to have lunch before she left for home. She wanted pizza, but he wanted a sandwich, so they went to the Subway across the street from the State Office Building, and just down the block from his apartment.

While they were at Subway, he said, the Pizza Hut at the other end of the block was robbed. The bandits made people get down on the floor, then took their watches, rings and wallets. The savings and loan office in the same block was robbed by a man who wrecked his bike and broke his ankle trying to get away, Rep. Cassidy said, adding that he has a concealed-carry permit and carries his gun with him.

When his wife got home, he added, he told her about the robbery they'd missed, and she asked what he was going to do for dinner. He told her he was going to Pizza Hut, but she said, "That would be a bad idea."

He went elsewhere, and the Pizza Hut was robbed for the second time that day.

"You guys just don't know how much fun it is to live in Topeka," he said.

He and Sen. Ralph Ostmeyer of Grinnell, who were touring the 120th House District together, both thanked Decatur County Farm Bureau for setting up the meeting and providing pizza for lunch.

*Budget needs to balance

tax would go through the roof."

He said he has worked with the governor's office on plans for school finance, but never heard about a controversial plan to publish teacher evaluations on the Internet until it was delivered to the Legislature.

He said the technical education part of the governor's plan is good but won't help our area much.

"We need kids to go to vocational training," he said. "We need them to know you can live in Oberlin, Kan., or St. Francis, Kan., and come back and make a living. Now, all of our kids are living in Johnson County."

"We have to, as communities, get our kids to come back here."

He said the group Schools for Fair Funding has sued the state again over cuts to the education budget, and might well win the case as it did an earlier suit.

"I don't think you should use state money to sue the state," he said, noting that Norton is the only school district in this area involved in the group.

Mr. Cassidy said he had told the chief justice that he opposed a Judicial Department plan to end the requirement that each county have a resident judge. He said he also opposed a change that would require magistrate judges to be lawyers, which he said would increase the

department's payroll.

"I just wish common sense and calmer heads could prevail down there," said the first-term legislator. "These people just want the power."

Last year, in his first session, he said, he focused on the state fire marshal's office, which had issued more than \$3 million in "illegal" citations to schools.

This year, he said, he wants to focus on the state Board of Healing Arts, which he said should be helping rural hospitals and communities find the professionals they need.

Rep. Cassidy said Lynn Doeden of Oberlin, chief executive officer of Decatur Health Systems, had been

a big help on hospital issues. He called her, "the world's best hospital administrator."

John Miller, a Norton County commissioner and candidate for the state Senate, asked if the Legislature might put counties back under a tax lid.

"If you intend for us to grow and prosper, you can't put us back under a tax lid," he said.

Rep. Cassidy said he wasn't sure where that bill was, but it hadn't come out of committee.

He also said he opposed a bill which would allow grocery stores to sell liquor, but knows of at least one local store in his district that is hot for the idea.

New Oncology Clinic Brings Specialized Cancer Services To You



Dr. January Fields
Medical Oncologist/Hematologist

Dr. January Fields, oncologist and hematologist will see and evaluate new patients, manage patients currently receiving treatment and provide follow-up services at a new clinic in Colby.

Oncology – Dr. January Fields
Monthly
Citizens Medical Center
Specialty Clinic
100 E. College Drive - Colby

The cancer program at HaysMed is accredited by the American College of Surgeons Commission on Cancer. Its fellowship-trained cancer specialists provide these state-of-the-art cancer care services:

- Medical oncology
- Radiation oncology
- Hematology
- Breast Care Center
- Cancer prevention, screening and early detection
- Diagnosis, consultation, treatment
- Patient support and education
- Clinical research
- Cancer survivorship services

To schedule an appointment or for more information, consult your primary care physician. Or call 785-623-5774 or Toll Free 1-800-248-0073 and ask for Medical Oncology.

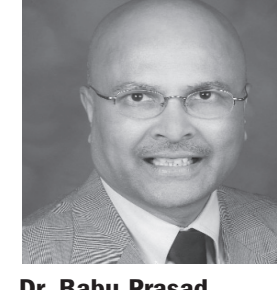

Dr. Babu Prasad
Radiation Oncologist



Dr. Anne O'Dea
Medical Oncologist/Hematologist



Dr. Sameh G. Abuerreish
Medical Oncologist/Hematologist



2220 Canterbury Drive – Hays
785-623-5774
www.haysmed.com/cancer

LAND AUCTION

812 (+/-) Acres

Bottomland, Grassland & CRP

Rawlins County, Kansas

Date: Friday, March 16th, 2012

TIME: 10:00 a.m. CST

AUCTION LOCATION:

St. Mary's Hall, Herndon, KS 67745

LAND LOCATION: From Herndon, KS, 3 miles west on Rd. X, 2 miles South on Rd. 31.

Sellers: Kelly Kimbel & Lexie Mumm

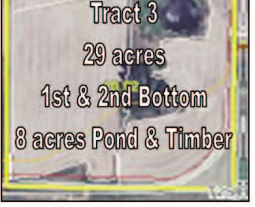

AUCTIONEER'S NOTE: This is a rare opportunity to buy good bottomland and grassland located along a well maintained county road. This is excellent hunting property with an abundance of deer and wild turkey.
TRACT I: NW¼ of NW¼ of 18-2-31, Rawlins County, consisting of approximately 29.5 acres 1st bottomland.
TRACT II: S½ of NW¼ and S½ of 18-2-31 and N½, Less SW¼ of NW¼ of 19-2-31, Rawlins County, consisting of approximately 46.6 acres CRP, 586 acres grassland.
TRACT III: SE¼ of NE¼ of 13-2-32, Rawlins County, consisting of approximately 28.9 acres 1st and 2nd bottomland, 7.51 acres pond and timber.
TRACT IV: NE¼ of NW¼ and N½ of NE¼ of 13-2-32, Rawlins County, consisting of approximately 99.9 acres 1st bottomland, 9.7 acres timber and grassland.

Tract	Legal	Cropland Acres	Grassland Acres	Wheat Base/YLD	Milo Base/YLD	2011 Taxes
Tract 1	NW¼ of NW¼ of 18-2-31	30.5	9.5	18.9/31	1.0/46	\$48.75
Tract 2	S½ of NW¼ and S½ of 18-2-31, and N½, Less SW¼ of NW¼ of 19-2-31	46.6	586	17.41/31	4.5/46	\$342.14
Tract 3	SE¼ of NE¼ of 13-2-32	28.94	7.9	16.3/31	2.6/46	\$57.69
Tract 4	NE¼ of NW¼, and NW¼ of NE¼ of 13-2-32	96.76	9.7	54.9/31	8.9/46	\$141.78

MANNER OF SALE: This land will be sold in four individual tracts only.
TERMS: 10% down day of sale, balance due on or before April 17th, 2012.
POSSESSION: Buyer(s) shall receive possession of all cropland after the 2013 wheat harvest. January 1st, 2013 on all grassland and CRP.
TAXES: 2012 and subsequent years shall be the responsibility of the Buyer(s).
MINERALS: All (100%) of the Sellers' interest shall go to the Buyer(s) at closing.
CROPS: The present Tenant shall retain all, (100%) crops for the crop year 2012 and 2013.
FSA PAYMENTS: The present Tenant shall receive all, (100%) of the 2012 and 2013 FSA payments.
LEASES: This land is being sold subject to the Tenant's rights. The Buyer(s) shall receive all, (100%) of the cash lease payments pursuant to the present lease agreement between the Sellers and the Tenant.
TITLE INSURANCE: Seller(s) shall provide title evidence the day of the sale. The premium shall be paid one-half by Buyer(s) and one-half by Seller(s) at closing.
CLOSING: On or before April 17th, 2012. Decatur County Title & Abstract, 181 S. Penn, Oberlin, KS 67749 shall be the escrow agent and closing agent. The closing fee shall be paid one-half by Seller(s) and one-half by Buyer(s).
GENERAL INFORMATION: Tract 2 has a submersible well and domestic well for livestock water supply. Tract 3 has a pond stocked with fish and is spring fed. The Beaver Creek passes through Tract 4.
INSPECTIONS: All bidders are responsible for their own inspections concerning facts about the property. Neither the Sellers, Glad Real Estate, its agents and representatives make no warranties about the property, expressed or implied.
AGENCY: Glad Real Estate, its agents and representatives are the exclusive agents of the Sellers.
Announcements made day of sale shall take precedence over printed matter.
All acreages are based on US Government (FSA) measurements and are considered approximate. Selling subject to easements, reservations, leases, and right-of-ways of record. Glad Real Estate is representing the Sellers only, in this transaction.

Glad Real Estate
415 State • P.O. Box 173 • Atwood, KS 67730
Betty L. Petersen, Broker
Rocky Hayes - Auctioneer / Sales Agent
Office: 785-626-2039; Home: 785-626-9600
Cell: 785-626-4022
Visit our website for additional pictures:
www.gladrealestate.com